

AMENDMENT OF HIGHWAY EASEMENT DEED

**118024**

BOOK 139 PAGE 686

THIS AMENDMENT, made this 28<sup>th</sup> day of October, 1992

by and between the UNITED STATES OF AMERICA, acting by and through the DEPARTMENT OF TRANSPORTATION, FEDERAL HIGHWAY ADMINISTRATION, hereinafter referred to as the DEPARTMENT, and the STATE OF WASHINGTON, hereinafter referred to as the STATE:

WITNESSETH:

WHEREAS, it is the intent of the parties to amend sheets 2, 9, 10, 11 and 12 of Exhibit "A" of that certain Highway Easement Deed dated March 9, 1993 and recorded June 25, 1993 in Book 136, pages 194 to 228 under Skamania County Auditor's File No. 116566. This is necessary because the description of the land as shown on these sheets of the original exhibit does not correctly locate the highway as constructed; and

WHEREAS, the STATE has filed application under the provisions of the Act of Congress of August 27, 1958, as amended (23 U.S.C. Section 317), for the right-of-way of a highway over certain land owned by the United States in the State of Washington, which is under the jurisdiction of the Department of Agriculture - Forest Service: and

WHEREAS, this transfer is further authorized under the provisions of the Act of Congress approved October 15, 1966 (80 Stat. 931,937, Section 6(a)(1)(A); and

|              |          |
|--------------|----------|
| Registered   | <u>2</u> |
| Indexed, Dir | <u>2</u> |
| Indirect     | <u>2</u> |
| Filmed       |          |
| Mailed       |          |

75-200  
300  
400  
500  
600

sl

WHEREAS, the Federal Highway Administrator, pursuant to delegations of authority from the Secretary of Transportation, has determined that an easement over the land covered by the application is reasonably necessary for right-of-way for State Route 504, Coldwater Lake Vicinity to Johnston Ridge; as revised October 4, 1993; and

WHEREAS, the Department of Agriculture, acting by and through the Forest Service, has agreed to the transfer by the DEPARTMENT of an easement over the land to the STATE;

Now THEREFORE, the DEPARTMENT, as authorized by law, does hereby grant to the STATE an easement for a right-of-way for the operation and maintenance of a highway including control of access thereto from adjoining land, and use of the space above and below the established grade line of the highway pavement for highway purposes on, above, across, in and upon the following described land of the United States of America within the Gifford Pinchot National Forest, County of Skamania, State of Washington:

T. 9 N., R. 5 E., W. M.

Sec. 5, S 1/2

Sec. 6, S 1/2

Sec. 7, NE 1/4

Sec. 8, N 1/2

Sec. 9, NW 1/4 NW 1/4

being those portions of the above described land lying within the right of way limits (shown as Highway Easement Lines) of State Route 504, Coldwater

BOOK 139 PAGE 688

Lake Vicinity to Johnston Ridge, sheets 2, 9, 10, 11 and 12 AS REVISED October 4, 1993, as shown on Exhibit A, attached hereto and made a part hereof, subject, however, to the terms, conditions and covenants found in that certain Highway Easement Deed recorded June 25, 1993 in Book 136 pages 194 to 228 under Skamania County Auditor's File Number 116566.

The purpose of this instrument is to correct and supersede sheets 2, 9, 10, 11 and 12 of Exhibit "A" of the above referenced Highway Easement Deed. The remainder of the original exhibit "A" is unchanged. It is understood and agreed that all of the terms and conditions of the original Highway Easement Deed apply to the land shown on the attached exhibit. Except as herein amended, said original Highway Easement Deed and its terms and provisions shall remain in full force and effect.

IN WITNESS WHEREOF, I Robert B. Rutledge, Regional Counsel, Pursuant to delegations of authority from the Secretary of Transportation, the Federal Highway Administrator, the Regional Federal Highway Administrator, and Chief Counsel, Federal Highway Administration, by virtue of authority in me vested by law, have hereunto subscribed my name as of the day and year first above written.

UNITED STATES OF AMERICA  
DEPARTMENT OF TRANSPORTATION  
FEDERAL HIGHWAY ADMINISTRATION

By

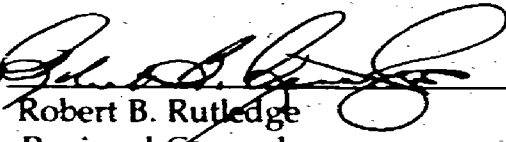
  
Robert B. Rutledge  
Regional Counsel

STATE OF Oregon )  
COUNTY OF Multnomah ) ss:

BOOK 139 PAGE 689

I, Donna Z. Juhnke Notary Public in and for the State of Oregon  
do hereby certify that on the day of Oct. 28, 1993 before me personally  
appeared Robert B. Rutledge, Regional Counsel, Federal Highway  
Administration, and acknowledged that the foregoing instrument bearing  
date of Oct. 28 —, 1993 was executed by him, in his official capacity  
and by authority him vested by law, for the purposes and intents in said  
instrument described and set forth, and acknowledged the same to be his free  
act and deed as Regional Counsel, Federal Highway Administration.

Witness my hand and seal this 28<sup>th</sup> day of October, 1993.

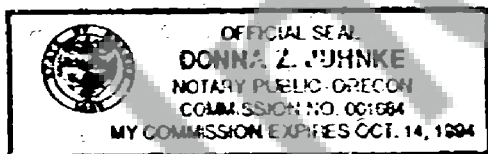

Donna Z. Juhnke  
Notary Public

My commission expires Oct. 14, 1994.

In compliance with the conditions set forth in the foregoing  
instrument, STATE certifies, and by the acceptance of this instrument, accepts  
the right-of-way over certain land herein described and agrees for itself, its  
successors and assigns forever to abide by the conditions set forth in said  
instrument.

By Joach - Perley  
Director, Real Estate Services  
WASHINGTON STATE  
DEPT. OF TRANSPORTATION

STATE OF WASHINGTON     )  
  )  
COUNTY OF THURSTON    )

BOOK 139 PAGE 690

I, Tom A. Dale, Notary Public in and for said County and State, hereby certify that Joachim Pestinger, whose name as Director, Real Estate Services is signed to the foregoing conveyance and who is known to me, acknowledged before me on this day that, being informed of the contents of the conveyance, he in his capacity as Director, Real Estate Services executed the same voluntarily on this day.

Given under my hand and seal of office this 15 day of November, 1993.

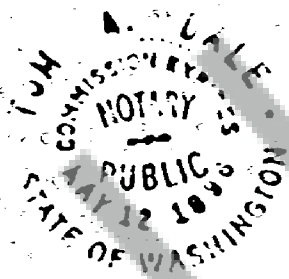

Tom A. Dale  
Notary Public in and for the  
State of Washington  
Residing at Elm...

My commission expires 5/12/96

FILED FOR RECORD  
SKAMANIA CO. WASH  
BY SKAMANIA CO. TITLE

Nov 19 3 30 PM '93  
J. Lowry  
AUDITOR  
GARY M. OLSON

BE BEGINNING OF PLAN  
STA. 2399+00 P.O.T.  
MP 45.50

NT. ST. WILHELM  
NATIONAL VOLCANIC  
MOVEMENT

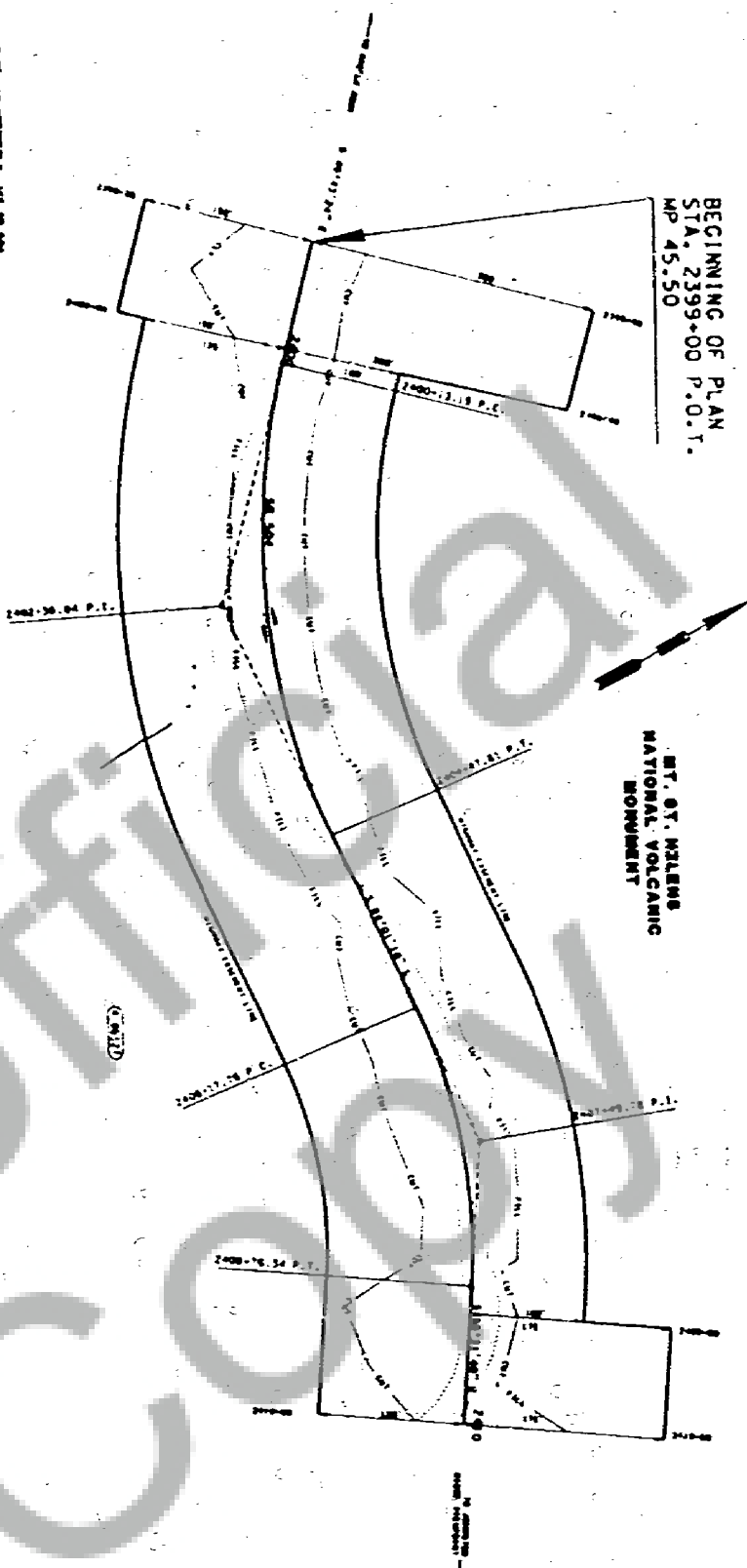

FOR RIVER IS NOT NEARBY TO V. WE DO NOT  
SEE CATCH REPORTS OF DEPENDENCY OF CR FROM V.  
LIVE OFFSHORE, UNTIL 2 OF 2, APPROX 1000  
MILES OFFSHORE.

44-38861-2000  
ALL INFORMATION CONTAINED  
HEREIN IS UNCLASSIFIED  
DATE 08-22-2000 BY 60322  
UCBAW

L. C. MO  
MAY 1960

QWNT-RSHIPS

IN 1941 48.90 TO 42.50  
COLONIAL LANE VICTORY

10  
JONES 1011 10000

**WELLS FARGO BANK**

100

● 大塚 幸司

**THE NEW YORK PUBLIC LIBRARY**

## Abstract

# A

1

9

三

10

11

50

2007

\*\*\*\*\*

**THE UNIVERSITY OF CHICAGO**

10

—

—

10

100

100

10

**Abstract**

1990-1991

MT. ST. HELENS  
NATIONAL VOLCANIC  
MONUMENT

SUPPOD PITCHOT  
NATIONAL FOREST

T. 9N. R. 5E. W. 4N.

BOOK 139 PAGE 692

EXHIBIT "A"

SM 904 UP 45.50 TO 46 52.36  
CANDORIAN LANE VICINITY  
TO  
JUNCTION ROAD  
COUNTY AND BUREAU CHARTER  
DATE OF 1954-10-15



UNITED STATES DEPARTMENT OF THE INTERIOR  
BUREAU OF LAND MANAGEMENT  
WASHINGTON, D. C. 20250  
OFFICE OF THE ASSISTANT ATTORNEY GENERAL  
WASHINGTON, D. C. 20540  
OFFICE OF THE ASSISTANT ATTORNEY GENERAL  
WASHINGTON, D. C. 20540  
OFFICE OF THE ASSISTANT ATTORNEY GENERAL  
WASHINGTON, D. C. 20540

ORANGE SHIPS

UNITED STATES DEPARTMENT OF THE INTERIOR  
BUREAU OF LAND MANAGEMENT  
WASHINGTON, D. C. 20250  
OFFICE OF THE ASSISTANT ATTORNEY GENERAL  
WASHINGTON, D. C. 20540  
OFFICE OF THE ASSISTANT ATTORNEY GENERAL  
WASHINGTON, D. C. 20540  
OFFICE OF THE ASSISTANT ATTORNEY GENERAL  
WASHINGTON, D. C. 20540



MT. ST. HELENS  
NATIONAL VOLCANIC  
MONUMENT

SEWARD PACIFIC  
NATIONAL FOREST

T.9N. R.5E. W.M.

BOOK 139 PAGE 693

|         |         |         |         |
|---------|---------|---------|---------|
| DATE    | FILE    | DATE    | FILE    |
| 10/1/78 | 10/1/78 | 10/1/78 | 10/1/78 |



Section 36, Township 9N, Range 5E, West Meridian  
Section 37, Township 9N, Range 5E, West Meridian  
Section 38, Township 9N, Range 5E, West Meridian  
Section 39, Township 9N, Range 5E, West Meridian  
Section 40, Township 9N, Range 5E, West Meridian  
Section 41, Township 9N, Range 5E, West Meridian  
Section 42, Township 9N, Range 5E, West Meridian  
Section 43, Township 9N, Range 5E, West Meridian  
Section 44, Township 9N, Range 5E, West Meridian  
Section 45, Township 9N, Range 5E, West Meridian  
Section 46, Township 9N, Range 5E, West Meridian  
Section 47, Township 9N, Range 5E, West Meridian  
Section 48, Township 9N, Range 5E, West Meridian  
Section 49, Township 9N, Range 5E, West Meridian  
Section 50, Township 9N, Range 5E, West Meridian  
Section 51, Township 9N, Range 5E, West Meridian  
Section 52, Township 9N, Range 5E, West Meridian  
Section 53, Township 9N, Range 5E, West Meridian  
Section 54, Township 9N, Range 5E, West Meridian  
Section 55, Township 9N, Range 5E, West Meridian  
Section 56, Township 9N, Range 5E, West Meridian  
Section 57, Township 9N, Range 5E, West Meridian  
Section 58, Township 9N, Range 5E, West Meridian  
Section 59, Township 9N, Range 5E, West Meridian  
Section 60, Township 9N, Range 5E, West Meridian  
Section 61, Township 9N, Range 5E, West Meridian  
Section 62, Township 9N, Range 5E, West Meridian  
Section 63, Township 9N, Range 5E, West Meridian  
Section 64, Township 9N, Range 5E, West Meridian  
Section 65, Township 9N, Range 5E, West Meridian  
Section 66, Township 9N, Range 5E, West Meridian  
Section 67, Township 9N, Range 5E, West Meridian  
Section 68, Township 9N, Range 5E, West Meridian  
Section 69, Township 9N, Range 5E, West Meridian  
Section 70, Township 9N, Range 5E, West Meridian  
Section 71, Township 9N, Range 5E, West Meridian  
Section 72, Township 9N, Range 5E, West Meridian  
Section 73, Township 9N, Range 5E, West Meridian  
Section 74, Township 9N, Range 5E, West Meridian  
Section 75, Township 9N, Range 5E, West Meridian  
Section 76, Township 9N, Range 5E, West Meridian  
Section 77, Township 9N, Range 5E, West Meridian  
Section 78, Township 9N, Range 5E, West Meridian  
Section 79, Township 9N, Range 5E, West Meridian  
Section 80, Township 9N, Range 5E, West Meridian  
Section 81, Township 9N, Range 5E, West Meridian  
Section 82, Township 9N, Range 5E, West Meridian  
Section 83, Township 9N, Range 5E, West Meridian  
Section 84, Township 9N, Range 5E, West Meridian  
Section 85, Township 9N, Range 5E, West Meridian  
Section 86, Township 9N, Range 5E, West Meridian  
Section 87, Township 9N, Range 5E, West Meridian  
Section 88, Township 9N, Range 5E, West Meridian  
Section 89, Township 9N, Range 5E, West Meridian  
Section 90, Township 9N, Range 5E, West Meridian  
Section 91, Township 9N, Range 5E, West Meridian  
Section 92, Township 9N, Range 5E, West Meridian  
Section 93, Township 9N, Range 5E, West Meridian  
Section 94, Township 9N, Range 5E, West Meridian  
Section 95, Township 9N, Range 5E, West Meridian  
Section 96, Township 9N, Range 5E, West Meridian  
Section 97, Township 9N, Range 5E, West Meridian  
Section 98, Township 9N, Range 5E, West Meridian  
Section 99, Township 9N, Range 5E, West Meridian  
Section 100, Township 9N, Range 5E, West Meridian

OWNERSHIP

|         |         |         |
|---------|---------|---------|
| OWNER   | DATE    | REMARKS |
| 10/1/78 | 10/1/78 | 10/1/78 |



54 504 UP 45.50 TO 52.56  
COORALIER LAKE VICINITY  
10  
ADDITIONAL NOTES  
1. 10/1/78  
2. 10/1/78  
3. 10/1/78  
4. 10/1/78  
5. 10/1/78  
6. 10/1/78  
7. 10/1/78  
8. 10/1/78  
9. 10/1/78  
10. 10/1/78  
11. 10/1/78  
12. 10/1/78  
13. 10/1/78  
14. 10/1/78  
15. 10/1/78  
16. 10/1/78  
17. 10/1/78  
18. 10/1/78  
19. 10/1/78  
20. 10/1/78  
21. 10/1/78  
22. 10/1/78  
23. 10/1/78  
24. 10/1/78  
25. 10/1/78  
26. 10/1/78  
27. 10/1/78  
28. 10/1/78  
29. 10/1/78  
30. 10/1/78  
31. 10/1/78  
32. 10/1/78  
33. 10/1/78  
34. 10/1/78  
35. 10/1/78  
36. 10/1/78  
37. 10/1/78  
38. 10/1/78  
39. 10/1/78  
40. 10/1/78  
41. 10/1/78  
42. 10/1/78  
43. 10/1/78  
44. 10/1/78  
45. 10/1/78  
46. 10/1/78  
47. 10/1/78  
48. 10/1/78  
49. 10/1/78  
50. 10/1/78  
51. 10/1/78  
52. 10/1/78  
53. 10/1/78  
54. 10/1/78  
55. 10/1/78  
56. 10/1/78  
57. 10/1/78  
58. 10/1/78  
59. 10/1/78  
60. 10/1/78  
61. 10/1/78  
62. 10/1/78  
63. 10/1/78  
64. 10/1/78  
65. 10/1/78  
66. 10/1/78  
67. 10/1/78  
68. 10/1/78  
69. 10/1/78  
70. 10/1/78  
71. 10/1/78  
72. 10/1/78  
73. 10/1/78  
74. 10/1/78  
75. 10/1/78  
76. 10/1/78  
77. 10/1/78  
78. 10/1/78  
79. 10/1/78  
80. 10/1/78  
81. 10/1/78  
82. 10/1/78  
83. 10/1/78  
84. 10/1/78  
85. 10/1/78  
86. 10/1/78  
87. 10/1/78  
88. 10/1/78  
89. 10/1/78  
90. 10/1/78  
91. 10/1/78  
92. 10/1/78  
93. 10/1/78  
94. 10/1/78  
95. 10/1/78  
96. 10/1/78  
97. 10/1/78  
98. 10/1/78  
99. 10/1/78  
100. 10/1/78



T. 9N. R. 5E. W.M.

BOOK 139 PAGE 694

MT. ST. HELENS  
NATIONAL VOLCANIC  
MONUMENT

GEORGE PINCHOT  
NATIONAL FOREST

EQUATOR  
MOUNTAIN

JOHNSON  
CREEK

20-MILE  
TRAIL



OFFICIAL MAPS AND ELEVATION RECORDS  
VIA. 270000 TO VIA. 271000000000  
VIA. 270000 TO VIA. 271000000000

OWNERSHIP

UNITED STATES DEPARTMENT OF AGRICULTURE  
BUREAU OF LAND MANAGEMENT  
WASHINGTON, D.C. 20250



SP 504 ... UP 45.50 TO UP 52.36  
CRODALEN LANE VICINITY  
JOHNSON RIDGE  
COUNTY AND BUREAU OFFICES

T.9N. R.5E. W.M.

GIFFORD PINCHOT  
NATIONAL FOREST

MT. ST. HELENS  
NATIONAL VOLCANIC  
MONUMENT

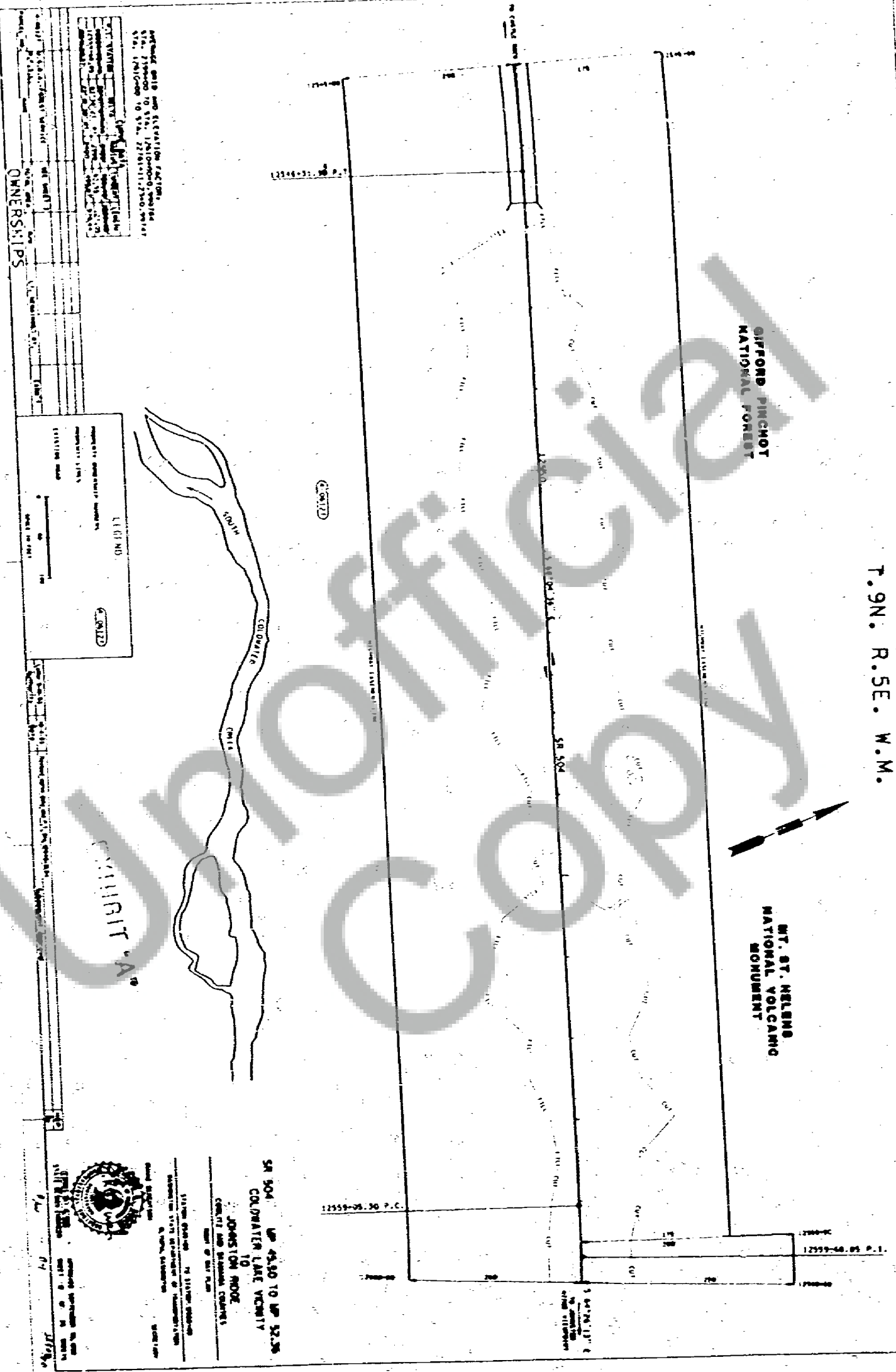

OFFICE OF THE  
BUREAU OF LAND MANAGEMENT  
WASHINGTON, D.C. 20250  
STATIONED TO THE  
BUREAU OF LAND MANAGEMENT  
WASHINGTON, D.C. 20250  
STATIONED TO THE  
BUREAU OF LAND MANAGEMENT  
WASHINGTON, D.C. 20250

OWNERSHIP

UNITED STATES  
DEPARTMENT OF AGRICULTURE  
BUREAU OF LAND MANAGEMENT  
WASHINGTON, D.C. 20250



SECTION 36 TO SECTION 32, T.9N. R.5E. W.M.  
COQUILLA LAKE VICINITY  
TO  
JOHNSON MOOSE  
COUNTY AND BUREAU OF LAND MANAGEMENT  
UNIT OF THE PLAN

STATIONED TO THE  
BUREAU OF LAND MANAGEMENT  
WASHINGTON, D.C. 20250  
STATIONED TO THE  
BUREAU OF LAND MANAGEMENT  
WASHINGTON, D.C. 20250