

117737

BOOK 3 PAGE 128

FILED FOR RECORD
BY SKAMAINIA CO. WASH

Oct 25 11 14 AM '93

AUDITOR
GARY H. OLSON

IN A PORTION OF
THE SW 1/4 SW 1/4 OF
SECTION 32, T2N, R5E, W.M.
SKAMAINIA COUNTY, WA.

SURVEY

TRACT SURVEYED (SEE NARRATIVE)

GELENE STEUDLER TO
STANLEY S. STEUDLER ET AL
DEED BOOK 123, PG. 481
RECORDED 5/30/91

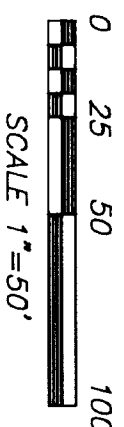
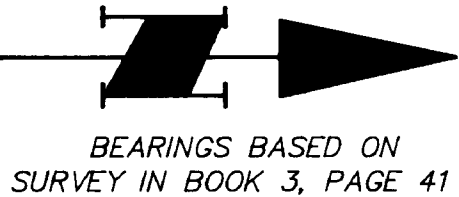

LEGEND

- 1 5/8" IRON ROD AS NOTED ON BOUNDARY AGREEMENT IN DEED BK. 119, PG. 4 & 5. (HERMENS/BROWN) RECOVERED, NOT TIED
- 2 1/2" I.R. AS SET IN SURVEY BK. 3, PG. 41 (NOT TIED, SHOWN FOR ORIENTATION ONLY)
- 3 5/8" I.R. AS SET IN "CLACKAMAS SURGICAL ASSOC. SHORT PLAT" (NOT TIED, SHOWN FOR ORIENTATION ONLY)
- 4 SET 1/2" x 24" IRON REBAR WITH YELLOW PLASTIC CAP STAMPED "RLS 9579"
- 5 STEEL FENCE POST SET
- (D) DEED DISTANCE AS NOTED IN BK. "X", PG. 485 (S 89°06'40"E, 332.00') AS INTERPRETED IN SURVEY BK. 3, PG. 41.

SURVEYOR'S CERTIFICATE

This map correctly represents a survey made by me or under my direction in conformance with the requirements of the Survey Recording Act at the request of STAN STEUDLER in JUNE, 19 93

William Hagedorn

AUDITOR'S CERTIFICATE

Filed for record this 25th day of October, 1993 at 11:14 AM, in Book 3 of surveys at Page 128 at the request of Hagedorn, Inc.

(Signed)

G. Steury

(Deputy County Auditor)

NOTE: Hagedorn, Inc. makes no warranties as to matters of unwritten title such as acquiescence, estoppel, adverse possession, etc.

HAGEDORN, INC.

1924 Broadway Vancouver, Wa. 98663
Ph: (206) 696-4428 (503) 283-6778

SCALE: 1"=50'
DATE: 6/9/93
JOB NO.: 93-086

CALC. BY: CEW
DRAWN BY: CC
CHECKED BY: BPT

SHEET 1 OF 1

NARRATIVE

THE PURPOSE OF THIS SURVEY INITIALLY WAS TO LOCATE THE NORTH AND SOUTH BOUNDARIES OF THE "STEUDLER TRACT" (TRACT B) AS DESCRIBED. IT BECAME EVIDENT THAT THIS WOULD BE UNSATISFACTORY SINCE A STRICT DEED LOCATION DEPENDS ON THE EXTENSION OF LOT LINES IN THE "WASHOUGAL RIVERSIDE TRACTS" (PLAT BOOK "A", PG. 80, 1922). THE LOCATION OF THOSE LOT LINES WOULD BE SUBJECT TO CHALLENGE DUE TO CONFLICTS BETWEEN SCATTERED MONUMENTATION AND "USE LINES" IN ADDITION TO GROSS AMBIGUITIES AND LACK OF "BEARINGS" ON THE ORIGINAL PLAT. IT WAS DECIDED, INSTEAD, TO LOCATE LINES THAT COULD BE AGREED ON AS ACCEPTABLE BY THE ADJOINERS (HERMENS AND BERGMAN). THESE LINES WERE THEN MONUMENTED AND DESCRIBED SO THAT QUIT-CLAIM DEEDS CAN BE EXCHANGED CONFIRMING THEM AS THE PERMANENT SIDELINE BOUNDARIES. FIELD WORK CONSISTED OF RADIAL TIES TO USE LINES & CORNERS ESTABLISHED FROM EXISTING CONTROL POINTS REMAINING FROM THE SURVEY FOR DR. ROBERT BROWN (BK. 3, PG. 41) IN 1990. FIELD EQUIPMENT USED WAS A 5-SECOND "TOTAL STATION" INSTRUMENT WITH DATA COLLECTOR.

