

AFTER RECORDING RETURN TO:

ATTN: REAL ESTATE SERVICES  
DEPARTMENT OF TRANSPORTATION  
KF-01  
P O BOX 4 7338  
OLYMPIA, WA 98504-7338

FILED FOR RECORD  
SKAMANIA CO. WASH  
BY DOT

AUG 25 3 08 PM '93

*P. Lowry*  
AUDITOR  
GARY M. OLSON

117119

QUITCLAIM DEED

BOOK 137 PAGE 598

IN THE MATTER OF SR 14, Skamania County, Prindle to Skamania.

KNOW ALL MEN BY THESE PRESENTS, that the STATE OF WASHINGTON, for and in accordance with that Agreement of the parties entitled TB4-0039, dated the 4th day of November, 1992, hereby conveys and quitclaims unto Skamania County, political subdivision of the State of Washington, all right, title, and interest under the jurisdiction of the Department of Transportation, in and to the following described real property situated in Skamania County, State of Washington:

All that part of Section 6, Township 1 North, Range 6 East, W.M., shown hachured on Exhibit "A" attached hereto and made a part hereof.

The specific details concerning all of which may be found on sheet 3 of that certain plan entitled SR 14, Skamania County, Prindle to Skamania, now of record and on file in the office of the Secretary of Transportation at Olympia, Washington, bearing date of approval October 9, 1925; revised to February 14, 1992.

It is understood and agreed that the above referenced property is transferred for road/street purposes only, and no other use shall be made of said property without obtaining prior written approval of the grantor. Revenues resulting from any vacation, sale, or rental of this property, or any portion thereof, shall be placed in the grantee's road/street fund and used exclusively for road/street purposes, except that the grantee may deduct the documented direct costs of any such vacation, sale, or rental.

The grantee as part consideration herein does hereby agree to comply with all civil rights and anti-discrimination requirements of RCW Chapter 49.60, as to the lands herein described.

The lands herein described are not required for State highway purposes and are conveyed pursuant to the provisions of RCW Chapter 47.12.080.

016048

REAL ESTATE EXCISE TAX

AUG 25 1993

PAGE 1 OF 2

TB4-0039

PAID Exempt  
*W*  
SKAMANIA COUNTY TREASURER

Registered   
Indexed   
Filed   
Mailed

By: *W* Parcel #



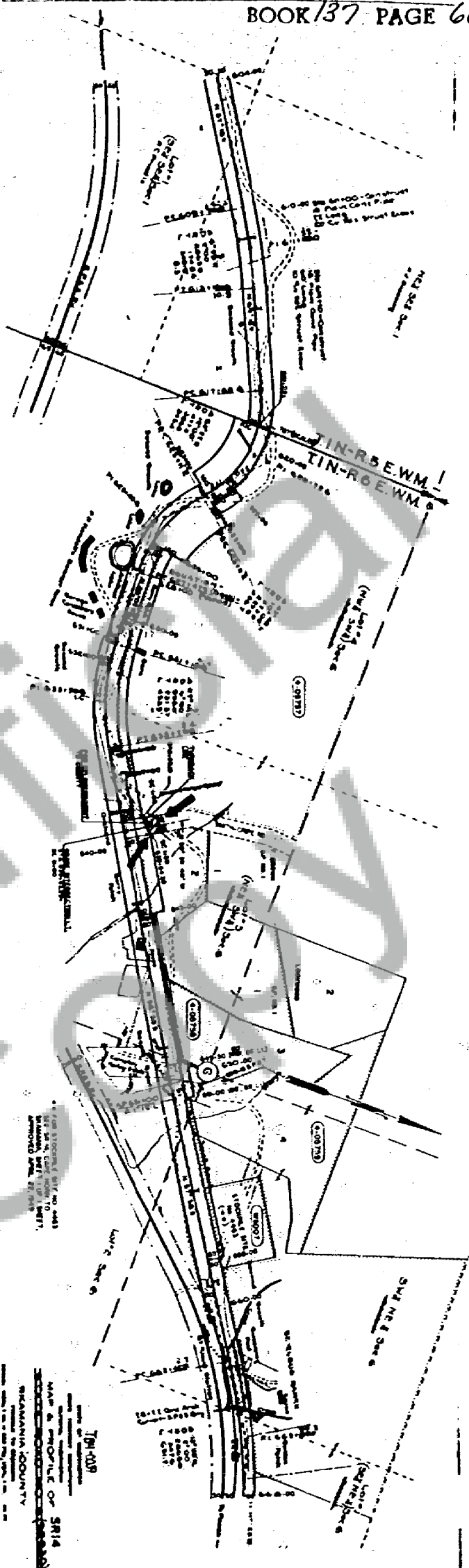

EXHIBIT 'A'

LEGEND

---	Proposed Embankment
---	Proposed Canal
---	Proposed Structure
---	Proposed Road
---	Proposed Fencing
---	Proposed Drainage
---	Proposed Survey
---	Proposed Station
---	Proposed Marker
---	Proposed Boundary
---	Proposed Elevation
---	Proposed Slope
---	Proposed Direction
---	Proposed Distance
---	Proposed Area
---	Proposed Volume
---	Proposed Weight
---	Proposed Length
---	Proposed Width
---	Proposed Height
---	Proposed Depth
---	Proposed Angle
---	Proposed Curvature
---	Proposed Tension
---	Proposed Pressure
---	Proposed Force
---	Proposed Energy
---	Proposed Power
---	Proposed Work
---	Proposed Heat
---	Proposed Mass
---	Proposed Density
---	Proposed Specific Gravity
---	Proposed Viscosity
---	Proposed Surface Tension
---	Proposed Capillary Action
---	Proposed Permeability
---	Proposed Porosity
---	Proposed Coefficient of Friction
---	Proposed Coefficient of Expansion
---	Proposed Coefficient of Contraction
---	Proposed Coefficient of Elasticity
---	Proposed Coefficient of Compressibility
---	Proposed Coefficient of Thermal Expansion
---	Proposed Coefficient of Thermal Contraction
---	Proposed Coefficient of Thermal Elasticity
---	Proposed Coefficient of Thermal Compressibility
---	Proposed Coefficient of Thermal Permeability
---	Proposed Coefficient of Thermal Porosity
---	Proposed Coefficient of Thermal Friction
---	Proposed Coefficient of Thermal Expansion/Contraction
---	Proposed Coefficient of Thermal Elasticity/Compressibility
---	Proposed Coefficient of Thermal Permeability/Porosity
---	Proposed Coefficient of Thermal Friction/Expansion/Contraction
---	Proposed Coefficient of Thermal Elasticity/Compressibility/Permeability/Porosity
---	Proposed Coefficient of Thermal Friction/Expansion/Contraction/Elasticity/Compressibility/Permeability/Porosity

OWNERS RIGHTS

OWNER	ADDRESS	ACRES	SECTION	TOWNSHIP	RANGE
...	...	...	...	...	...

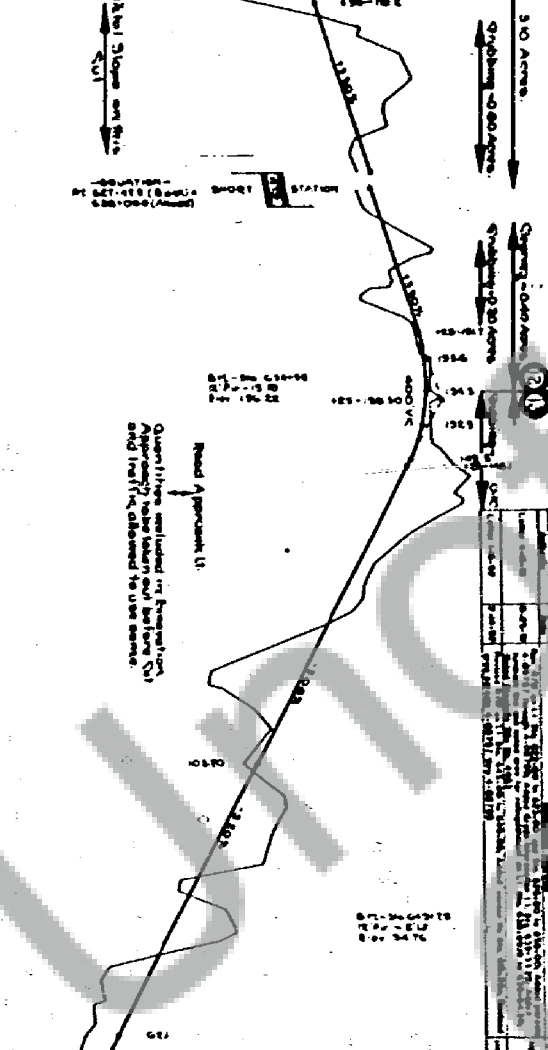

MILEAGE

Station	Distance	Structure
0+00	0.00	...
1+00	1.00	...
2+00	2.00	...
3+00	3.00	...
4+00	4.00	...
5+00	5.00	...
6+00	6.00	...
7+00	7.00	...
8+00	8.00	...
9+00	9.00	...
10+00	10.00	...

Quantities

Excavation	1450
Embankment	1450
Structure	1450
Other	1450
Total	5800

Summary of Quantities

Excavation	1450	Embankment	1450
Structure	1450	Other	1450
Total	5800		

791-028  
SHEET 2 OF 2  
MAY 2 1904  
SHEETS OF 2  
MAY 2 1904