

FILED FOR RECORD
SKAMANIA CO. WASH
BY Robert Glaeser

MAY 4 2 56 PM '93

P. Lowry

GARY M. OLSON

LAND CORNER RECORD

(THIS FORM PRESCRIBED BY THE PUBLIC LAND SURVEY
OFFICE, DEPARTMENT OF NATURAL RESOURCES, PURSUANT
TO RCW 58.09. ALPHA-NUMERIC INDEX DIAGRAM ON
THE BACK.)

116164

Corner Indexing Information:

BOOK 135 PAGE 83

TWP 2N RGE 6E Corner Code X-13
(Willamette Meridian)

ADDITIONAL IDENTIFIER: (e.g., BLM designation
for the corner, street intersection, plat name,
block, lot, etc.)
east quarter corner of Section 33, Township 2 North, Range 6 east,
Willamette Meridian.

Skamania County Washington:

AUDITOR'S USE

Land Surveyor Information: (or Public Officer as per RCW 58.09.090)

This corner record correctly represents work performed by me or
under by direction in conformance with the Survey Recording Act.

Company or agency:
Minister & Glaeser Surveying, Inc.
2208 E. Evergreen Blvd.
Vancouver, WA. 98661
Phone: (206) 694-3313
Fax: (206) 694-8410



Signature *Robert W. Glaeser* Date: 4-20-93 Seal: 15029

Washington Plane Coordinates: N: E:
Order: Zone: Datum (Date of adjustment):

Corner Information: Use the space below to provide the following
information regarding the corner.

(1) Pertinent Corner History:

The original survey was conducted by Deputy Surveyors, Lewis
Vanvleet and John Newsom under contract No. 7, dated April 29,
1859. Set a post at 40.00 chains North of the Southwest corner.
B.T.'s as follows:
8" diameter Dogwood, North 65° West, 40 links.
6" diameter Dogwood, South 20° East, 30 links.

1881 G.L.O. survey of Section 33 by Charles Sears. Found B.T.'s in
good condition, but post was gone. Set new post at corner.

1897 H. Witherell (County Surveyor) set a new stake at corner the
old stake was gone, C.O. Williams was a chainman.

1903 C.O. Williams (County Surveyor) surveyed to corner from East.
He went to 1/4 corner "which is est. by govt. witness
trees". Owners (Carl Lindstrom & P.E. Yettic) of East half,
Northeast quarter, section 33 & Northwest quarter of Section 34.,
were chainman.

Filed
Indexed
Filed
Mailed

In November 1988, Jerry C. Olson had conducted a survey of a portion of Southeast quarter, Northeast quarter, Section 33, Township 2 North, Range 6 East, Willamette Meridian, Skamania County. As detailed in his narrative on the quarter corner 33/34, Township 2 North, Range 6 East, Willamette Meridian. J.C. Olson set a 1" iron pipe with a Brass Cap. B.T.'s as follows:
 20" Fir with R.R. Spike and O.E. Tag, North 37° West, 5.17.
 10" Maple with R.R. Spike and O.E. Tag, East, 28.55
 14" Maple with R.R. Spike and O.E. Tag, South 83° West, 11.66.

(2) Evidence Found at the Corner:

No original evidence was found. Found 2 1/2" Brass cap; stamped Olson. East quarter corner, Section 33, located .30 above ground surface.

(3) Corner Perpetuation Information:

Surveys

Book 2, page 174
 Book 2, page 144
 Book 1, page 97
 Book 1, page 206

	1	2	3	4	5	6	7	8	9	10	11	12	13	14	15	16	17	18	19	20	21	22	23	24	25
A																									
B																									
C																									
D																									
E																									
F																									
G																									
H																									
I																									
J																									
K																									
L																									
M																									
N																									
O																									
P																									
Q																									
R																									
S																									
T																									
U																									
V																									
W																									
X																									
Y																									
Z																									

RCW 58.09.060 (2) requires the following information on this form: an accurate description and location, in reference to the corner position, of all monuments and accessories (a) found at the corner and (b) placed or replaced at the corner; (c) basis of bearings used to describe or locate such monuments or accessories; and (d) corollary information that may be helpful to relocate or identify the corner position.

SPACE FOR ADDITIONAL COMMENTS:

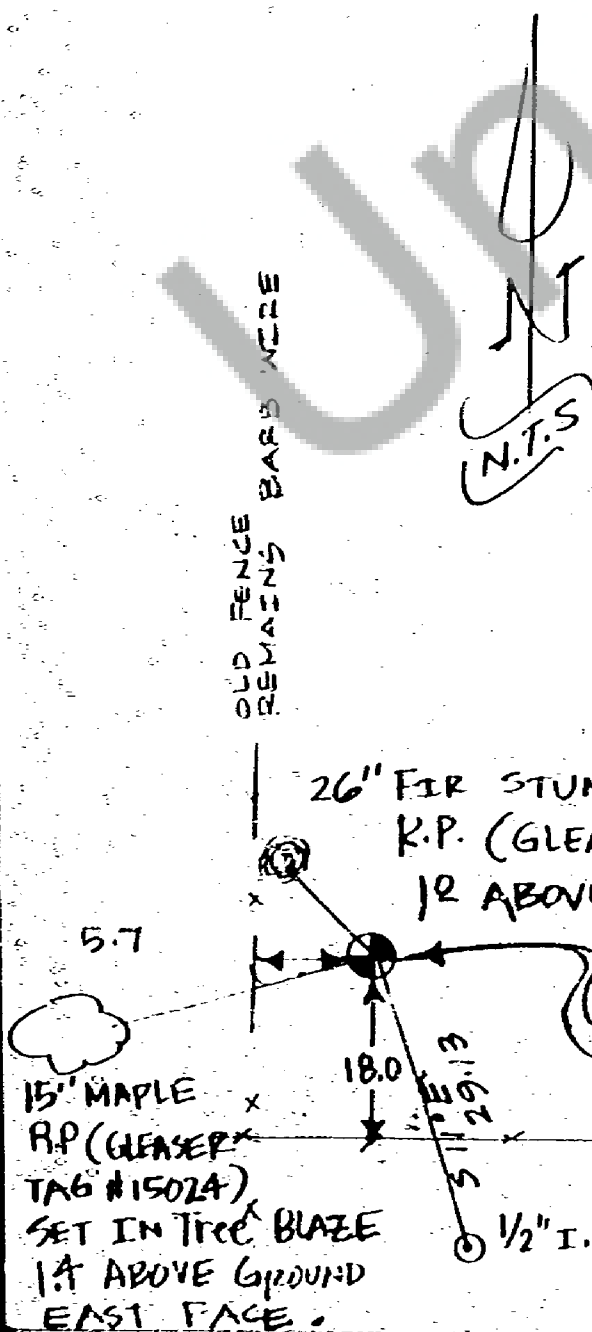

26" FIR STUMP, CUT OFF 3.20 ABOVE GROUND
 R.P. (GLEASER TAG #15024) SET IN BLAZE
 12 ABOVE GROUND 10 ABOVE GROUND.

FOUND 2 1/2" BRASS CAP W/ OLSON
 STAMPED ON IT.
 ALSO E 1/4 COR. SEC. 33.
 .30 ABOVE GROUND

1/2" I.R. W/ MGS (Red Control CAP)

15" MAPLE
 R.P. (GLEASER
 TAG #15024)
 SET IN TREE BLAZE
 1.4 ABOVE GROUND
 EAST FACE.