

Claim #2

FORM No. 830—NOTICE OF VEIN OR LODE LOCATION—WASHINGTON

COPYRIGHT 1991 BY STATE DEPARTMENT OF REVENUE, OREGON, U.S.A.

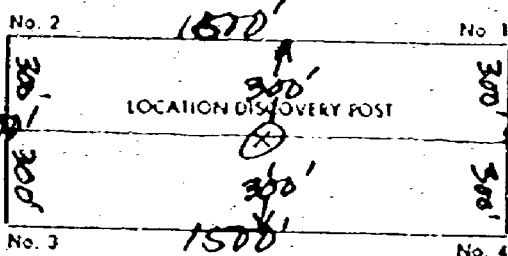

This Diagram Explains Method of Description of Claim

115965

# Notice of Mining Location VEIN OR LODE CLAIM

STATE OF **WASHINGTON**

County of ~~WASHINGTON~~ **SKAMANIA**

**WASHOUBAL River**

Mining District

**BOOK 134 PAGE 520**

NOTICE HEREBY IS GIVEN that the undersigned locators, each a citizen of the United States or one who has declared an intention to become such, have discovered a vein or lode of locatable mineral-bearing rock in place upon the public domain of the United States which is open to mineral entry and location within the above state, county and mining district; and, in accordance with the laws of the United States and of the State of Oregon, have located and do hereby locate a claim upon such vein or lode by posting this notice of such discovery and location on a substantial post or monument at the point of discovery. The name of the claim is:

**HOLE IN THE WALL II (2)**

Claim, further described as follows:

Commencing at a post marked No. 1 then:

1500' feet in a **NW**  
300' feet in a **SW**  
1500' feet in a **SE**  
300' feet in a **NE**

direction to a corner post marked No. 2, then  
direction to a corner post marked No. 3, then  
direction to a corner post marked No. 4, then  
direction to said corner post marked No. 1.

The locators claim

**750'**

feet in a **EASTERN** end line and **750'**

direction from the point of discovery to the

**Northeastern**

feet in the opposite direction from the point of discovery to the

**WESTERN**

feet on each side of the middle of said vein or lode, further claiming all the surface rights, privileges and minerals, with all dips, spurs, angles and variations, and other rights granted by existing laws and customs. This claim is further described as being

**750'**

feet from the following natural object or permanent monument in the vicinity: **at the NE corner a stream flows, a fault occurs with large boulders & outcroppings. This stream enters the East fork of the Skamania River, south of the claim.**

The general course or strike of the vein or lode as nearly as may be determined is **Gold, Copper & Silver Bearing Quartz** with reference to the natural object or permanent monument described above.

This claim is situated in the **WNB 1/4** (designate quarter section) of Section **13**, Township **4N**, Range **5E**, of the **Willamette** Meridian, as surveyed by the U.S. Government or protracted if the land is unsurveyed.

The end lines of the claim are parallel to each other. The adjoining claims are **parallel to each other.**

This notice is placed conspicuously at the discovery post, and posts are placed at each corner of the claim. The location of this claim is distinctly marked on the ground so that the boundaries of the claim may be readily traced.

Located **4-7**, 1993.

FILED FOR RECORD  
SKAMANIA CO. WASH  
By **James Ward**

APR 9 2 18 PM '93

**G. Larry**  
AUDITOR  
**GARY H. OLSON**

**Daniel W. Bilbruck**

Locator(s).

## MINING LOCATION VEIN OR LODE

**HOLE IN THE WALL II (2)**  
Name of Claim

Locators

AFTER RECORDING RETURN TO:

**DANIEL W. BILBRUCK**  
**951 N STREET**  
**WASHOUBAL, WASH**  
**98671**

NAME, ADDRESS, ZIP

SPACE RESERVED  
FOR  
RECORDER'S USE

Registered **2**  
Indexed, Dir **2**  
Indirect **2**  
Filed  
Mined

STATE OF  
County of

I certify that the within instrument was received for record on the day of \_\_\_\_\_, 19\_\_\_\_, at \_\_\_\_\_ o'clock \_\_\_\_\_ M., and recorded in book/reel/volume No. \_\_\_\_\_, on page \_\_\_\_\_ or as fee/file/instrument/microfilm/reception No. \_\_\_\_\_, Record of \_\_\_\_\_ of said County.

Witness my hand and seal of County affixed.

By \_\_\_\_\_ Deputy.