

68-9
Page
PLATS
B
Book

FILED FOR RECORD
BY **JOHN GRANHOLM**
DEC 10 11 17 AM '92
-V. Schram
GARY OLSON

115125

FOURTH ADDITION TO THE PLATS OF RELOCATED NORTH BONNEVILLE

A PLAT OF LANDS IN THE B.B. BISHOP DONATION LAND CLAIM 39
IN SECTION 21, TOWNSHIP 2 NORTH, RANGE 7 EAST, WILLAMETTE MERIDIAN
SKAMANIA COUNTY WASHINGTON

SHEET 1 OF 2 SHEETS

CERTIFICATION

We, the undersigned, do hereby certify that all the land described on this plat is owned in fee by the United States of America under the jurisdiction of the Department of the Army, and Burlington Northern Railroad Company,

a corporation. We further certify that this plat has been made with the free consent, and in accordance with the desires of the owners.

IN WITNESS WHEREOF, I have hereunto set my hand this 26 day of MAY 1981, for The Department of Army Lands.

Terence J. Connell
Terence J. Connell
Colonel, Corps of Engineers District Engineer

ACKNOWLEDGMENT

STATE OF OREGON S.S.
COUNTY OF MULTNOMAH

THIS IS TO CERTIFY that on the 26 day of MAY 1981 before me, the undersigned, a Notary Public in and for the State of Oregon duly commissioned and sworn, personally appeared before me Colonel Terence J. Connell to me known to be the individual described in and who executed the foregoing instrument and acknowledged to me that he signed the same as a free and voluntary act of the United States of America and for the uses and purposes mentioned therein, and on oath states that he is authorized to execute said instrument.

Harry F. Rose
Notary Public for the State of Oregon,
residing at Portland, Oregon
My commission expires 6 December 1982



CERTIFICATION

The same as in CERTIFICATION above

IN WITNESS WHEREOF, I have hereunto set my hand this 18 day of AUGUST 1981, for Burlington Northern Railroad Company lands.

J. S. Kennedy
J. S. Kennedy, Vice President, Burlington Northern Railroad Company

ACKNOWLEDGMENT

STATE OF MINNESOTA S.S.
COUNTY OF RAMSEY

On this 18 day of AUGUST 1981 before me personally appeared J. S. Kennedy known to me as Vice President of Burlington Northern Railroad Company, a Delaware Corporation, and executed the foregoing instrument, acknowledging said instrument to be the free and voluntary act of the said corporation for the uses and purposes therein mentioned, and on oath stated that he is authorized to execute said instrument.

Given under my hand and official seal the day and year first above written.



R. H. Bishop
Notary Public in and for the State of MINNESOTA residing at ST. PAUL
My commission expires APRIL 23, 1983

CERTIFICATION

The State of Washington, by and through its Department of Transportation, is the equitable owner and beneficial occupant of the land depicted on this plat as State Route 14 pursuant to Relocation Contract DACW57-76-C-0241 between the United States of America and the State of Washington. I certify that this plat has been made with the free consent and in accordance with the desires of the State of Washington.

IN WITNESS WHEREOF, I have hereunto set my hand this 3rd day of June 1981

Duane Berentson
Duane Berentson
Title Secretary

ACKNOWLEDGMENT

STATE OF WASHINGTON
COUNTY OF THURSTON

THIS IS TO CERTIFY that on the 3rd day of June 1981 before me personally appeared Duane Berentson to me known to be the Secretary, Washington Department of Transportation, and that he executed the within and foregoing instrument, and acknowledged said instrument to be the free and voluntary act of State of Washington for the uses and purposes therein mentioned, and on oath stated that he was authorized to execute said instrument.

Given under my hand and official seal the day and year first above written.

Rory B. Cooper
Notary Public in and for the State of Washington residing at Olympia
My commission expires June 1, 1983

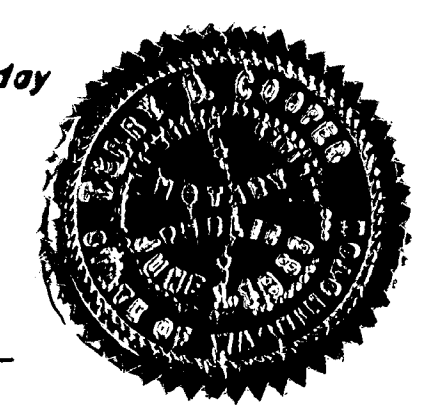

APPROVALS

TREASURER'S CERTIFICATE

I, Sandra Willing, treasurer of Skamania County, Washington, do hereby certify that all taxes and any delinquent assessments on the attached platted property are fully paid including 1992. 2-7-21-1-2-203, 1600, 1900, 2000, 2100, 2200, 3000, 3100, 3200, 1501

Jan R. Wyinger, Deputy
Treasurer, Skamania County

ATTEST this 10 day of DEC 1992.

Gary Olson
Gary Olson, County Auditor and Clerk of County Commissioners Skamania County

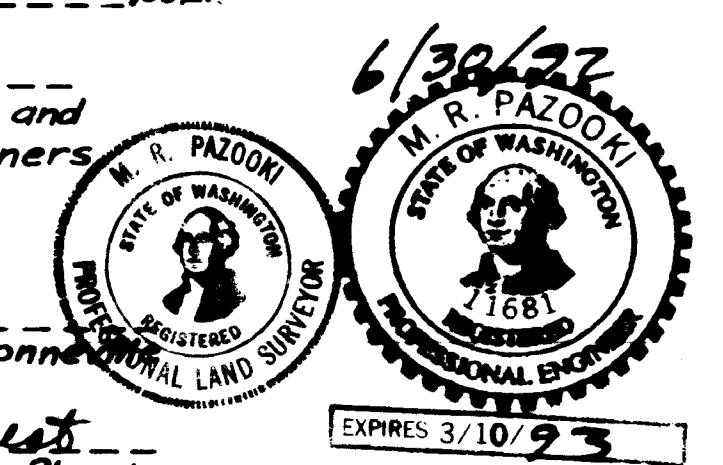

Maurice A. Secrest
Engineer, City of North Bonneville
Chairman, North Bonneville Planning Commission, Maurice Secrest

CITY OF NORTH BONNEVILLE

Henry A. Laham
HENRY A. LAHAM, MAYOR

CITY COUNCIL MEMBERS:

Esther A. Rice
ESTHER A. RICE
Follard R. Dickson
FOLLARD R. DICKSON
Kenneth C. Cole
KENNETH C. COLE
Keith Chamberlain
KEITH CHAMBERLAIN
Clover Duffus
CLOVER DUFFUS

Auditor's Certificate
Filed for record this 10th day of December 1992 at 11:17 A.M. in Volume B of Plats on Page 68-9 of the request of John Granholm.
Gary M. Olson
by P. Lowry, Deputy

A PLAT OF LANDS IN THE B.B.BISHOP DONATION LAND CLAIM 39
IN SECTION 21, TOWNSHIP 2 NORTH, RANGE 7 EAST, WILLAMETTE MERIDIAN
SKAMANIA COUNTY WASHINGTON
SCALE: 1" = 100'

SHEET 2 OF 2 SHEETS

BEGINNING at the initial point, said point being the most southerly corner of the "FIRST ADDITION TO THE PLATS OF RELOCATED NORTH BONNEVILLE", said point also being South 43°35' 18" East 1893.43 feet from the northwest corner of Section 21, Township 2 North, Range 7 East, Willamette Meridian, said point also being on the south line of Cascade Drive;

THENCE along the arc of a 180.00 foot radius curve to the left, through a central angle of 72°42'45" for an arc distance of 228.43 feet to a point on the southerly projection of the centerline of Moffett Hot Springs Road;

THENCE North $42^{\circ}50'37''$ East 76.97 feet;

THENCE North 10°25'27" East 60.00 feet to the north line of West Roosevelt Avenue;

THENCE North $71^{\circ}47'19''$ East 86.64 feet;

THENCE South $78^{\circ}33'47''$ East 108.26 feet;

THENCE North $83^{\circ}20'27''$ East 280.86 feet;

THENCE South 30°00'00" East 402.43 feet to the south line of relocated State Highway No. 14;

THENCE South 60°36'00" West, along the south line of said relocated State Highway No. 14, 471.16 feet to the most easterly corner of the "SECOND ADDITION TO THE PLATS OF RELOCATED NORTH BONNEVILLE":

THENCE North 14°52'43" West 78.86 feet to the south line of Old State Highway No. 14 by plans dated April 24, 1923 ;

THENCE South 75°07'17" West 182.06 feet along
the south line of said Old State Highway No. 14 :

THENCE South $14^{\circ}52'43''$ East 20.00 feet :

THENCE South 75°07'17" West 679.70 feet along the south line of said Old State Highway No. 14 to the southerly projection of the centerline of Greenleaf Lake;

THENCE North $35^{\circ}38'40''$ West 141.83 feet along said southerly projection to the initial point.

All bearings and distances are based on the Oregon State Coordinate System, North Zone.

I, William Hagedorn, registered as a professional land surveyor by the State of Washington, certify that this plat is based on an actual survey of the land described herein, conducted by me or under my supervision, during the period of November 1975 through December 1979 ; that the distances, course and angles are shown thereon correctly, and that perimeter monuments other than those monuments approved for setting at a later date ; have been set ; that those monuments approved for setting at a later date are adequately referenced and will be set by me upon completion of construction.

William F. Hagedorn
WILLIAM F. HAGEDORN
Professional Land Surveyor
No. 9579

Subscribed and sworn before me
this 20th day of December, 1979.
Don J. Hale
Notary Public for the State of Washington
My commission expires August 15, 1982

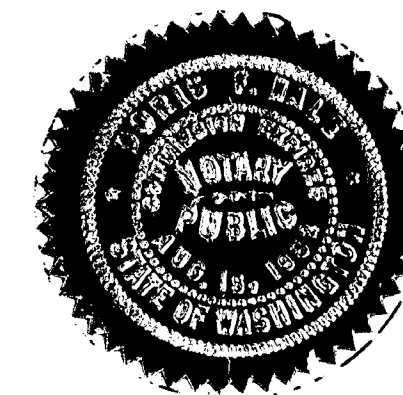

o Indicates concrete monument set with U.S. Corps of Engineers brass cap. Monuments are 4"x4" at the top and 6"x6" at the base, 30" in length with a 1/2" iron rod through the center. Caps are punched with an N.B. number as noted hereon.

S59 - Open Space Lots

M23 } *Municipal Lots*
M26 }

- Indicates 5/8" iron rod 30" in length set with survey cap attached L.S. #9579 unless noted otherwise

INITIAL POINT

Most southerly corner of
the "FIRST ADDITION TO
the PLATS OF RELOCATED
NORTH BONNEVILLE."
N 725 666.459
E 1 627 957.295

