

TR

NO. 4	89496	NO. 3
NO. 5	LOCATION DISCOVERY POST NO. 1	NO. 2
NO. 6		NO. 7

THIS DIAGRAM EXPLAINS METHOD OF
DESCRIPTION OF CLAIM.

AMENDED NOTICE OF LOCATION

Notice of Mining Location

STATE OF ~~OREGON~~ WASH.County of SKAMANIATATOOSH

Mining District

NOTICE HEREBY IS GIVEN that the undersigned locators, each a citizen of the United States or one who has declared his intention to become such, have discovered a vein or lode of mineral bearing rock in place upon the unappropriated public domain of the United States within the State of ~~OREGON~~ ^{WASH} and said Mining District; and, in accordance with the laws of the United States, of the State of ~~OREGON~~ ^{WASH} and the regulations of said Mining District, have located and do hereby locate a claim upon such vein or lode by posting this notice of such discovery and location on a substantial post at the point of discovery, marked Post No. 1. The name of the claim is SILVER ROAD EXTENSION # 16 Claim, further described as follows:

Commencing at a post marked No. 1 (Discovery Post), from thence

300 feet in a SOUTHERLY direction to an end post marked No. 2, thence
300 feet in a EASTERLY direction to a corner post marked No. 3, thence
1500 feet in a NORTHERLY direction to a corner post marked No. 4, thence
300 feet in a WESTERLY direction to an end post marked No. 5, thence
300 feet in a WESTERLY direction to a corner post marked No. 6, thence
1500 feet in a SOUTHERLY direction to a corner post marked No. 7, thence
300 feet in a EASTERLY direction to said end post marked No. 2.

The locators claim 300 feet in a SOUTHERLY direction from point of discovery to the SOUTHERN end line and 1200 feet in the opposite direction from point of discovery to the NORTHERN end line and 300 feet on each side of the middle of said vein or lode, further claiming all the surface rights,

privileges and minerals, with all dips, spurs, angles and variations, and other rights granted by existing laws and customs. This claim is further described as being 3/4 MILE from a natural object or permanent monument in the vicinity, to-wit: SEC. 9 T4N R5E W.M. (use township and range, if possible)

THIS DISCOVERY CONSISTS OF MULTIPLE LODES AND DISSEMINATED COPPER WITH ASSOCIATED MINERALS PERMANENT MONUMENT BM 1159

The general course or strike of the vein or lode as nearly as may be determined is 15° N. of W. with reference to the natural object or permanent monument described above. The adjoining claims are S.R.E. E. # 15 S. # 9

AMENDMENT OF ORIGINAL LOCATION DATED SEPT. 10, 1973
RECORDED AT BOOK L PAGE 741 TO IDENTIFY
INDIVIDUAL CLAIM DESCRIPTIONS.

This notice is placed at discovery post No. 1; posts are placed at each corner and both center ends, and the name of this vein or lode and date of location are placed on all posts so that the boundaries of the claim may be readily traced. In construing this location notice, the singular includes the plural and vice versa, where the context so requires.

Located this

day of

19

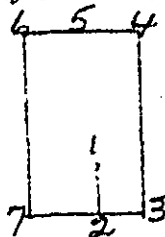
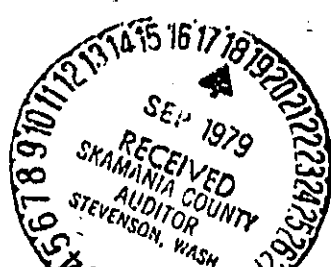
Red N. Richardson

Locator(s).

Caution: This form is applicable to the laws of the State of Oregon. If the claim for which this form is used is situated outside of Oregon, change the name of the state above and, accordingly, carefully check the foregoing location notice with the laws of the state and the regulations of the mining district in which the claim is situated to ensure that the notice contains all things required.