

89489

AMENDED NOTICE OF LOCATION
Notice of Mining Location

NO. 4	NO. 3
NO. 2	NO. 1
NO. 8	NO. 7

THIS DIAGRAM EXPLAINS METHOD OF
DESCRIPTION OF CLAIM.

STATE OF OREGON, WASH.

County of SKAMANIATATOOSH

Mining District

NOTICE HEREBY IS GIVEN that the undersigned locators, each a citizen of the United States or one who has declared his intention to become such, have discovered a vein or lode of mineral bearing rock in place upon the unappropriated public domain of the United States within the State of ^{WASH.} Oregon and said Mining District; and, in accordance with the laws of the United States, of the State of ^{WASH.} Oregon and the regulations of said Mining District, have located and do hereby locate a claim upon such vein or lode by posting this notice of such discovery and location on a substantial post at the point of discovery, marked Post No. 1. The name of the claim is SILVER ROAD EXTENSION # 9 Claim, further described as follows:

Commencing at a post marked No. 1 (Discovery Post), from thence

300 feet in a SOUTHERLY direction to an end post marked No. 2, thence300 feet in a EASTERLY direction to a corner post marked No. 3, thence1500 feet in a NORTHERLY direction to a corner post marked No. 4, thence300 feet in a WESTERLY direction to an end post marked No. 5, thence300 feet in a WESTERLY direction to a corner post marked No. 6, thence1500 feet in a SOUTHERLY direction to a corner post marked No. 7, thence300 feet in a EASTERLY direction to said end post marked No. 2.The locators claim 300 feet in a SOUTHERLYdirection from point of discovery to the SOUTHERN end line and 1200feet in the opposite direction from point of discovery to the NORTHERN end line and300 feet on each side of the middle of said vein or lode, further claiming all the surface rights,

privileges and minerals, with all dips, spurs, angles and variations, and other rights granted by existing laws

and customs. This claim is further described as being 3/4 ^{MILE} feet from a natural object or permanent monu-ment in the vicinity, to-wit: SEC. 9 T4N R5E W.M. (use township and range, if possible)THIS DISCOVERY CONSISTS OF MULTIPLE LODES ANDDISSEMINATED COPPER WITH ASSOCIATED MINERALS.PERMANENT MONUMENT B.M. 1159The general course or strike of the vein or lode as nearly as may be determined is 15° N. of W.

with reference to the natural object or permanent monument described above. The adjoining claims are

S. R. E. E. # 10 N. # 16 S. # 8

AMENDMENT OF ORIGINAL LOCATION DATED SEPT. 10, 1973
RECORDED AT BOOK L PAGE 741 TO IDENTIFY
INDIVIDUAL CLAIM DESCRIPTIONS

This notice is placed at discovery post No. 1; posts are placed at each corner and both center ends, and the name of this vein or lode and date of location are placed on all posts so that the boundaries of the claim may be readily traced. In construing this location notice, the singular includes the plural and vice versa, where the context so requires.

Located this _____ day of _____, 19____

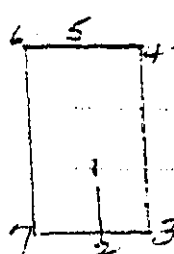
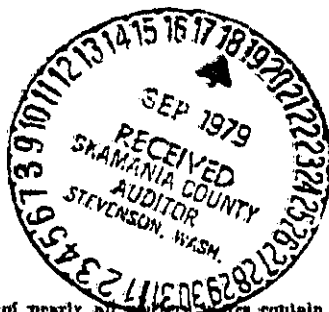
Red N. Richardson

Locator(s).

Caution: The laws of nearly all states contain special requirements for location notices. These requirements differ from state to state. The Oregon requirements appear on the reverse hereof. If the claim for which this form is used is situated outside of Oregon, change the name of the state above and, before recording, carefully check the foregoing location notice with the laws of the state and the regulations of the mining district in which the claim is situated to ensure that the notice contains all things required.