

1B

NO. 4 87516 NO. 3

NO. 6 LOCATION DISCOVERY POST NO. 1 NO. 2

NO. 8 THIS DIAGRAM EXPLAINS METHOD OF DESCRIPTION OF CLAIM. NO. 7

Notice of Mining Location

STATE OF ~~OREGON~~ WASHINGTON

County of SKAMANIA

Unorganized

Mining District

NOTICE HEREBY IS GIVEN that the undersigned locators, each a citizen of the United States or one who has declared his intention to become such, have discovered a vein or lode of mineral bearing rock in place upon the unappropriated public domain of the United States within the State of ~~Oregon~~ WASH and said Mining District; and, in accordance with the laws of the United States, of the State of ~~Oregon~~ WASH and the regulations of said Mining District, have located and do hereby locate a claim upon such vein or lode by posting this notice of such discovery and location on a substantial post at the point of discovery, marked Post No. 1. The

name of the claim is BONANZA #. 2 Claim, further described as follows:

Commencing at a post marked No. 1 (Discovery Post), from thence

50 feet in a Easterly direction to an end post marked No. 2, thence

300 feet in a Northerly direction to a corner post marked No. 3, thence

1500 feet in a Westerly direction to a corner post marked No. 4, thence

300 feet in a Southerly direction to an end post marked No. 5, thence

300 feet in a Southerly direction to a corner post marked No. 6, thence

1500 feet in a Easterly direction to a corner post marked No. 7, thence

300 feet in a Northerly direction to said end post marked No. 2.

The locators claim 50 feet in a Easterly direction from point of discovery to the East end line and 1500 feet in the opposite direction from point of discovery to the West end line and

300 feet on each side of the middle of said vein or lode, further claiming all the surface rights, privileges and minerals, with all dips, spurs, angles and variations, and other rights granted by existing laws and customs. This claim is further described as being feet from a natural object or permanent monument in the vicinity, to-wit: (use township and range, if possible)

Located in the S. 1/2 of Section 26, T9N R9E of Willamette Meridian located 175 ft. above a 75 ft. falls on Boulder Creek and Approximately 5/8 Mile above Road N90 where road N90 Crosses Boulder Creek. This notice is on the west side of Boulder Creek

The general course or strike of the vein or lode as nearly as may be determined is Westerly with reference to the natural object or permanent monument described above. The adjoining claims are This claim adjoins the Bonanza # 1 Claim on the West end Line of the Bonanza # 1 Claim.

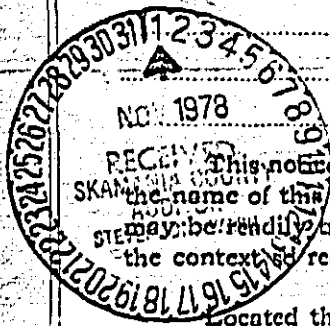

This notice is placed at discovery post No. 1; posts are placed at each corner and both center ends, and the name of the vein or lode and date of location are placed on all posts so that the boundaries of the claim may be readily traced. In construing this location notice, the singular includes the plural and vice versa, where the context so requires.

Located this 7 day of October, 1978

William W. Rambo

STATE OF OREGON

County of Clackamas

ss.

October 7, 1978

William Rambo

Personally appeared the above named WILLIAM W. RAMBO, and acknowledged the foregoing instrument to be his voluntary act and deed.

Before me:

Rebecca A. Rulon
Notary Public My Commission Expires: 10/16/82

Locator(s).

Caution: The laws of nearly all western states contain special requirements for location notices. These requirements differ from state to state. The Oregon requirements appear on the reverse hereof. If the claim for which this form is used is situated outside of Oregon, change the name of the state above and, before recording, carefully check the foregoing location notice with the laws of the state and the regulations of the mining district in which the claim is situated to ensure that the notice contains all things required.

Sec. 23—"A mining claim * * * may equal but shall not exceed 1500 feet in length along the vein or lode; but no location of a claim shall be made until the discovery of the vein or lode within the limits of the claim located. No claim shall extend more than 300 feet on each side of the middle of the vein at the surface * * *. The end lines of each claim shall be parallel to each other."

Sec. 24—" * * * All records of mining claims * * * shall contain the name or names of the locators, the date of the location, and such a

description of the claim or claims located by reference to some natural object or permanent monument as will identify the claim."

Sec. 35—"Placer claims, including all forms of deposit excepting veins and lodes or other rock in place shall be subject to entry and possession * * * upon similar proceedings as are provided for vein and lode claims. * * * no such location shall include more than twenty acres for each individual claimant."

Excerpts from Chapter ~~XXX~~ Revised Statutes Re: Location—Vein and Lode Claims

517.010. Location of mining claims upon veins or lodes. (1) Any person, a citizen of the United States, or one who has declared his intention to become such, who discovers a vein or lode of mineral-bearing rock in place upon the unappropriated public domain of the United States within this state, may locate a claim upon such vein or lode by posting thereon a notice of such discovery and location. The notice shall contain:

- The name of the lode or claim.
- The names of the locators.
- The date of the location.
- The number of linear feet claimed along the vein or lode each way from the point of discovery, with the width on each side of the lode or vein.

(5) The general course or strike of the vein or lode as nearly as may be, with reference to some natural object or permanent monument in the vicinity, and by defining the boundaries upon the surface of each claim so that the same may be readily traced.

(2) Such boundaries shall be marked within 30 days after posting of such notice by six substantial posts, projecting not less than three feet above the surface of the ground, and not less than four inches square or in diameter, or by substantial mounds of stone, or earth and stone, at least two feet in height, to wit: one such post or mound of rock at each corner and at the center ends of such claims.

517.030. Recording copy of discovery notice; fee. The locator shall, within 60 days from the posting of the location notice by him upon the

lode or claim, file for record with the recorder of conveyances, if there is one, who shall be the custodian of mining records and miners' liens, otherwise with the clerk of the county where the claim is situated, a copy of the notice posted by him upon the lode or claim and shall pay the recorder or clerk a fee of \$1 for such record, which sum the recorder or clerk shall immediately pay over to the treasurer of the county and shall take his receipt therefor, as in case of other county funds coming into the possession of such officer. The recorder or clerk shall immediately record the location notice.

517.040. Abandoned claims. Abandoned claims are unappropriated mineral lands, and titles thereto shall be obtained as specified in ORS 517.010 to 517.030, without reference to any work previously done thereon.

517.060. Correcting defective notice of location. If at any time an individual who has located a mining claim within the meaning of ORS 517.010 or 517.040, or his assigns, apprehends that the original notice of location of the mining claim was defective, erroneous, or that the requirements of the law had not been complied with before the filing of the notice, such locator or assigns may post and file for record in the manner now provided by law, an amended notice of the location which shall relate back to the date of the original location; provided, that the posting and filing of the amended notice of location shall not interfere with the existing rights of others at the time of posting the amended notice.

The following is a quotation from information furnished the publisher by the State of ~~Oregon~~ Department of Geology and Mineral Industries.

Necessary steps in locating a vein or lode claim.

1. Post notice of location at point of discovery.
2. Stake claim within 30 days of date of discovery.
3. File copy of notice of location with county clerk or recorder for the county in which the claim is located. Filing fee is \$1.00 per claim. Notice may be mailed in for recording. Notice should be recorded within 60 days from the posting of the notice on the claim.

Area and shape of a vein or lode claim.

A vein or lode claim can be not more than 1500 feet in length and can extend not more than 300 feet on either side of the vein or lode (Fig. 1-A). A full sized vein or lode claim embraces an area of slightly more than 20 1/2 acres. Although most claims are rectangular they may have a variety of shapes, the only requirement being that the end-lines be parallel. In the case of non-rectangular claims it should be noted that the end-lines need not be limited to 600 feet in length. (Fig. 1-B).

Requirements of a vein or lode claim (Fig. 1-C).

1. Location notice posted at or near point of discovery.
2. Four claim corner posts, or monuments, and two center end posts, or monuments. All posts must be at least 4 inches square or in diameter, and must project at least 3 feet above the ground. Monuments of stone, or earth and stone, must be at least 2 feet in height.

Vein or lode or placer location.

Vein or lode claims are located where minerals occur in place in veins or lodes. Most metal mines are vein or lode locations.

Placer claims are located where minerals have been derived from rocks or veins to form deposits such as stream gravels and gold-bearing alluvium. Massive deposits of nonmetallic minerals such as limestone, building stone, and pumice are generally located as placer claims.

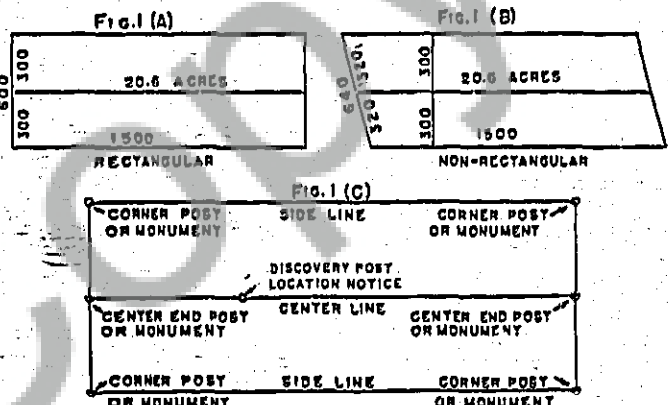

Mining Location

VEIN OR LODE

(FORM No. 830)

STEVENS-NESS LAW PUB. CO., PORTLAND, ORE.

BOUAN 3A

Name of Claim.

WILLIAM RAMBO

Locators.

AFTER RECORDING RETURN TO

WILLIAM W RAMBO
3236 SE HARVEY #32
MILW ORE 97222

87516

SPACE RESERVED
FOR
RECORDERS USE

REGISTERED
INDEXED: DIR.
INDEXED:
RECORDED:
COMPARED
FILED

WASH
STATE OF OREGON,
County of ~~Shammas~~

I certify that the within instrument was received for record on ~~November~~ November, 1978, at 11:20 o'clock A.M., and recorded in book 2 on page 16, or as file/reel number 2, of said County. Witness my hand and County affixed.

E. J. Tsch
Recording Officer.
By J. W. Washburn Deputy.