

## CERTIFICATE OF MINING LOCATION

THE STATE OF WASHINGTON)

COUNTY OF SKAMANIA )

NOTICE is hereby given that the undersigned Locator, who is a citizen of the United States, having complied with the requirements of the United States and this State, located the hereinafter described Lode Mining Claim on the 21<sup>st</sup> day of July, 1978, and hereby certifies as follows:

- The name of the claim is Judy 12.
- The claim is situated in the Green River/St. Helen's Mining District and is in the Southeast quarter ~~and of the~~ northwest quarter of Section 17, Township 10 North, Range 6 East, Willamette Meridian, Washington.
- This claim is 1200 feet long and 600 feet wide, to-wit: Along the general course of the vein 1100 feet in a west direction and 100 feet in a east direction at which the location notice is posted, and in width 300 feet <sup>north</sup> of the centerline and 300 feet South of the centerline.
- The claim is described as follows:  
Beginning at the west endline, 100 feet west of the location notice  
Thence north, 300 feet to the northwest corner  
Thence east, 1200 feet to the northeast corner  
Thence South, 600 feet to the southeast corner  
Thence West, 1200 feet to the Southwest corner  
Thence north, 300 feet to point of beginning
- All monuments are marked to designate the date of the location and the name of the claim.
- The discovery monument marked D.P. Judy 12 is about 1480 feet in a N46°W direction from the Center (1/4 corner) of Section 17.

WITNESS:

Harmon C. LehmanLOCATOR: DIVAL CORPORATIONBY: John Taylor

SKETCH OF CLAIM:

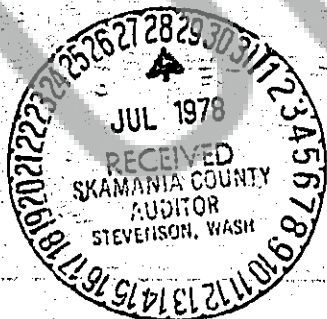
4715 E. Fort Lowell Rd.Tucson, Arizona 85712

GERMANIA GP.

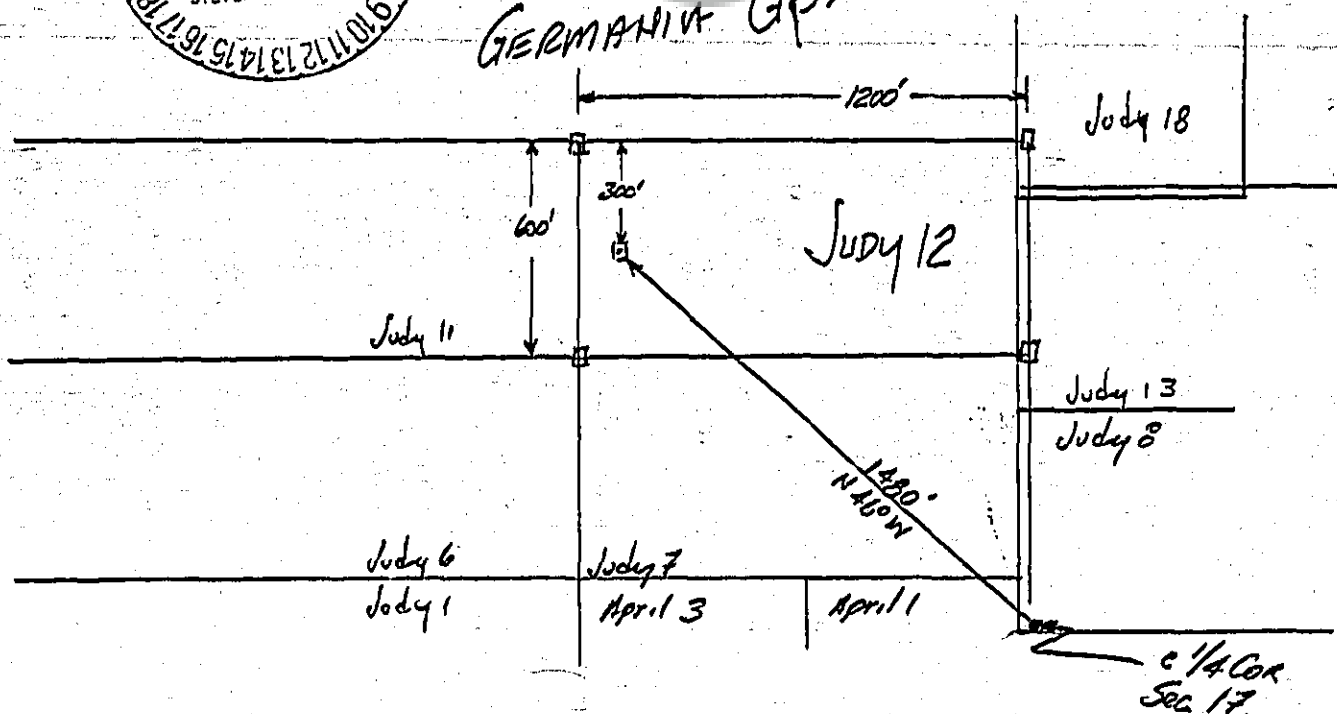
c 1/4 Cor  
Sec 17.