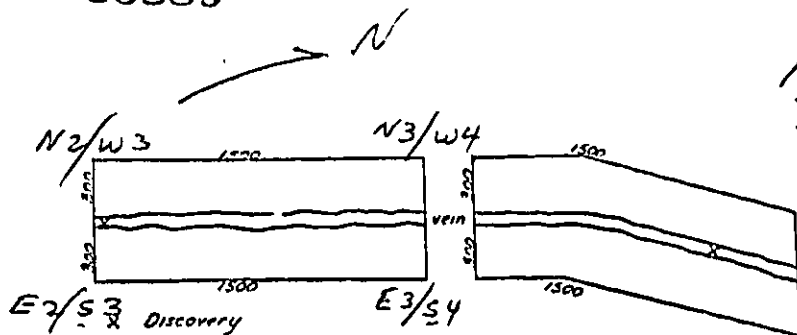

86880

AMERICAN GOLCONDA #3
Notice of Mining Location

This diagram explains method of description of claim.

WASHINGTON State
SKAMANIA County
ST. HELENS Mining District

NOTICE IS HEREBY GIVEN That the undersigned, having complied with the requirements of Chapter six of Title thirty-two of the Revised Statutes of the United States, and the laws of the above State, and the local customs and regulations of said District, have located and do

hereby locate 1500 linear feet in length, and 600 feet in width on the

AMERICAN GOLCONDA lode, vein, ledge or deposit (or placer ground), situated in the above State, County and Mining District, and further described as follows: Commencing at a post marked No. 1 at the Discovery shaft (cut or tunnel),

N2/W3 1500 feet in a NORTH EASTERLY direction to an end post marked

No. 2, thence 600 feet in a SOUTH EASTERLY direction to a corner post marked

E3/S4 1500 feet in a SOUTH WESTERLY direction to a corner post marked

E2/S3 600 feet in a NORTH WESTERLY direction to a corner post marked

N2/W3 No. 5, thence feet in a direction to a corner post marked

No. 6, thence feet in a direction to said end post No. 2;

hereby locating and intending to claim 1500 feet in a NORTH EASTERLY

direction from discovery to the THE NORTH EAST END LINE OF AMERICAN GOLCONDA end line.

#2 AND ADJOINING TO IT ALONG THE N.E. END LINE, and feet in the opposite direction from discovery to the

end line and 300 feet on each side of the middle of said lode or ledge, for the purpose of mining the same and claiming all surface rights, privileges, and minerals, with all dips, spurs, angles and variations, and other rights granted by existing laws and customs.

This claim is further described as follows: COMMENCING AT THE NORTH EAST END OF AMERICAN GOLCONDA #2 AND EXTENDING 1500 FEET ALONG SAID VEIN, 300 FEET ON EITHER SIDE OF THE VEIN IN A NORTHEASTERLY DIRECTION. THIS CLAIM IS LOCATED IN SECTION 16, T10N, R6E. ALL OR PART OF THIS LOCATION IS RELOCATED AND LOCATED AS ABANDONED PROPERTY KNOWN AS GOLCONDA OR AMERICAN GOLCONDA OR SOME OTHER NAME CLAIM, ALL ABANDON PROPERTY

This notice is placed at Discovery on post No. 1; posts are placed at each corner, and the name of this lode, and date of location, are placed on all posts.

Located 21 day of JULY, A. D. 1978



Vern R. ...
Locators.