

79795

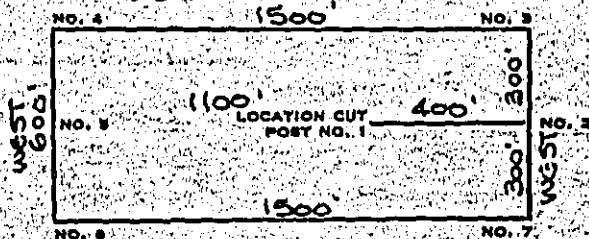

THIS DIAGRAM EXPLAINS METHOD OF DESCRIPTION OF CLAIM.

Notice of Mining Location

STATE OF WASHINGTONCounty of SKAMANIACOPPER CREEK Mining District

NOTICE IS HEREBY GIVEN That the undersigned, having complied with the requirements of Chapter Six of Title Thirty-Two, of the revised statutes of the United States, and the laws of the above State, and the local customs and regulations of said District has..... located and does..... hereby locate 1500 linear feet in length, and 600 feet in width on the KELSEY lode, (Name of) vein, ledge or deposit situated in the above State, County and Mining District, and further described as follows:

Commencing at a post marked No. 1 at the Discovery shaft (cut or tunnel), from thence.....
400 feet in a NORTH direction to an end post marked No. 2, thence
300 feet in a EAST direction to a corner post marked No. 3, thence
1500 feet in a SOUTH direction to a corner post marked No. 4, thence
300 feet in a WEST direction to an end post marked No. 5, thence
300 feet in a WEST direction to a corner post marked No. 6, thence
1500 feet in a NORTH direction to a corner post marked No. 7, thence
300 feet in a EAST direction to said end post marked No. 2; hereby locating and intending to claim 400 feet in a NORTH direction from discovery to the NORTH end line and 1100 feet in the opposite direction from discovery to the SOUTH end line and 300 feet on each side of the middle of said lode or ledge, for the purpose of mining the same and claiming all the surface rights, privileges and minerals, with all dips, spurs, angles and variations, and other rights granted by existing laws and customs. This claim is further described as follows (and state distance from natural object or permanent monument, Section, Township and Range, if possible):

West appx 2700 from the intersection of Copper & Miners Creeks
This claim is located in the NE 1/4 of Sec 5, T. 3 N. R. 5 E. (unsurveyed)

The adjoining claims are.....

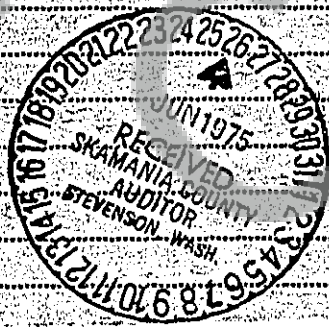

This notice is placed at discovery on post No. 1; posts are placed at each corner and both center ends, and the name of this lode and date of location are placed on all posts.

Located this 29th day of April AD 1975.

Witnesses:

Robert M. C. Jones

Harvey E. McEwen

STAR RT. BOX 27A
YACOLT, WASH.

Locator.

98675