

THE TWO COYOTE MINE

LOCATION NOTICE

C-152

Know All Men by These Presents That ANTON V. EVAULT
OF 8603 NE 107TH AVE VANCOUVER,
WASH. 98662

the undersigned citizen of the United States, haS this 26 TH day of
APRIL 1976, located and claimed, and by these presents do ES

locate and claim, by right of discovery and location, in compliance with the Mining Act of Congress,

approved May 10, 1872, and all subsequent Acts, and with local customs, laws and regulations, CLAIMS
600' BY 1500' linear feet and horizontal measurement on the MO AG AU

MIN 238 CU TZN lode, vein, ledge or deposit along the vein thereof, with all its dips,

angles and variations, as allowed by law, together with 300 feet ON EACH

side and 1500 feet on the EAST TO WEST side of the middle
of said vein at the surface, so far as can be determined from present developments; and all veins,

lodes, ledges or deposits and surface ground, within the lines of said claim 300 feet

running EAST from center of discovery WEST, and 1200

feet running WEST from center of discovery NORTH 300 FT., said discovery

& CLAIM IS being situated upon said lode, vein, ledge or deposit, and within the lines

of said claim, in SECTION 8 Mining District, PINCHOT NATIONAL

FOREST described by metes and
bounds as follows, to-wit:

BEGINNING at Cor. No. 1 (the SE corner), running thence 1500 FT
feet WEST, to a post marked SW COR; thence 600 FT
feet NORTH, to a post marked NW corner (Cor. No. 2); thence 1500 FT
feet EAST, to a post marked NE corner (Cor. No. 3); thence 600 FT
feet SOUTH, to a post marked SE COR; thence _____ feet
_____ to a post marked _____ corner (Cor. No. 4); thence _____ feet
_____ to a post marked _____ corner, the place beginning.

This claim is further described as follows: The point of discovery upon which this notice is
posted is in a NORTH WEST direction from the center of the CANYONER
line, distant _____ feet. From Cor. No. _____ CAMPGROUND
bears _____ distant _____ and _____ distant _____

THIS CLAIM IS LOCATED IN A GRAVEL
PIT THE ORE IS CU MO AG AU
TU 238 & ZN
This claim to be known as the TWO COYOTE MINE.

Discovered SEE SECTION CLAIM 19 _____ (Seal)

Located SEE SECTION CLAIM 19 _____ (Seal)

Witnesses: _____ (Seal)

_____ (Seal)

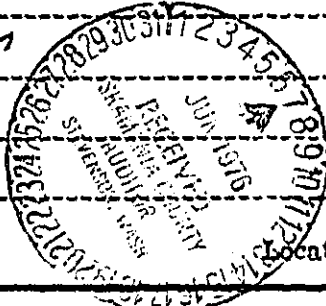

Locator Anton V. Evaault

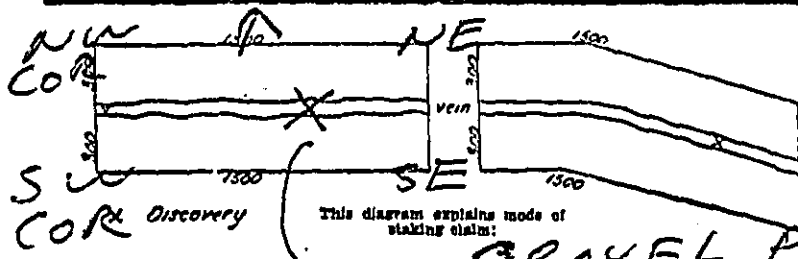

PRIMARY ORE
IS SILVER & CU,

GRAVEL PIT LOADED WITH
SILVER & U 238 &
CU MO