

NOTICE OF LOCATION
LODE MINING CLAIM

TO ALL WHOM IT MAY CONCERN:

This mining claim, the name of which is the Duv 42, was located by the undersigned on the 1st day of July, 1975. Said claim is 1500 feet long and 600 feet wide, 300 feet on each side of the centerline of said claim, the course of which is from east to west. A NOTICE OF LOCATION is posted on the centerline 100 feet from the east end and 1400 feet from the west end. This claim is located in the Green River (St. Helen's) Mining District, in Skamania County, State of Washington, about 2940 feet in an approx. S32°W direction from the WEST 1/4 corner of Section 18, Township 10 North, Range 6 East, W.M. and is located on the south of the Green River in Section 13, Township 10N, Range 5E.

This claim is described as follows:

Beginning at a point on the EAST end line being 100 feet from where the location notice is posted; thence SOUTH, 300 feet to the SOUTHEAST corner, a Blazed Tree; thence WEST, 1500 feet to the SOUTHWEST corner, a Blazed Tree; thence NORTH, 600 feet to the NORTHWEST corner, a Blazed Tree; thence EAST, 1500 feet to the NORTHEAST corner, a Blazed Tree; thence SOUTH, 300 feet to the point of beginning.

This claim is bounded on the north by Duv 44, and on the northeast by Duv 43.

LOCATED BY:

DUVAL CORPORATION

Witness:

Rodney Z. Smith

by: Johnnie P. Taylor
4715 East Fort Lowell Road
Tucson, Arizona 85712

Sketch of Claim:

Duv 41	Duv 40
Duv 39	Duv 38
Duv 37	Duv 36
Duv 35	Duv 34

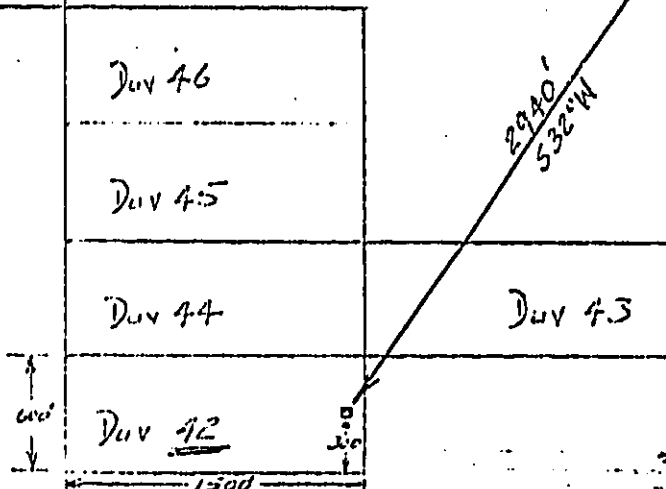

0 1/4 Sec 16