

77054

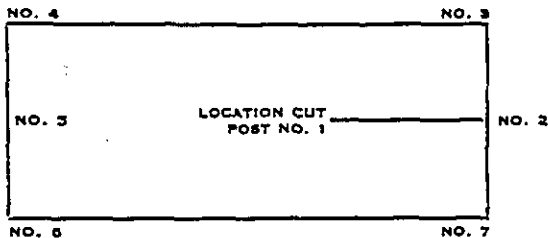

Notice of Mining Location

STATE OF WashingtonCounty of SkamaniaConger Rock

Mining District

NOTICE IS HEREBY GIVEN That the undersigned, having complied with the requirements of Chapter Six of Title Thirty-Two, of the revised statutes of the United States, and the laws of the above State, and the local customs and regulations of said District have located and do hereby locate 5280' linear feet in length, and 2640' feet in width on the Cat's Paw lode, (Name of) vein, ledge or deposit situated in the above State, County and Mining District, and further described as follows:

Commencing at a post marked No. 1 at the Discovery shaft (cut or tunnel), from thence 880' feet in a Westerly direction to an end post marked No. 2, thence 2640' feet in a Southerly direction to a corner post marked No. 3, thence 2640' feet in a Easterly direction to a corner post marked No. 4, thence 2640' feet in a Northerly direction to an end post marked No. 5, thence 2640' feet in a Northerly direction to a corner post marked No. 6, thence 2640' feet in a Westerly direction to a corner post marked No. 7, thence 2640' feet in a Southerly direction to said end post marked No. 2; hereby locating and intending to claim 2640' feet in a Northerly direction from discovery to the North end line and 2640' feet in the opposite direction from discovery to the South end line and 2640' feet on each side of the middle of said lode or ledge, for the purpose of mining the same and claiming all the surface rights, privileges and minerals, with all dips, spurs, angles and variations, and other rights granted by existing laws and customs. This claim is further described as follows (and state distance from natural object or permanent monument, Section, Township and Range, if possible):

ROB. E. Sec. 18 Point of discovery app; 200' S of NW 1/4, T. 30N. R. 30E. S. 18
W. border of Sec. 18, T. 30N. R. 30E.

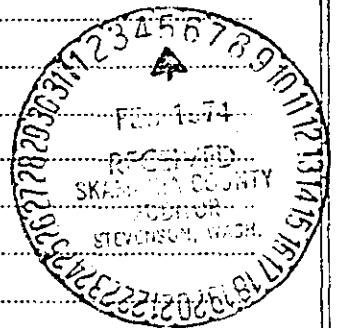
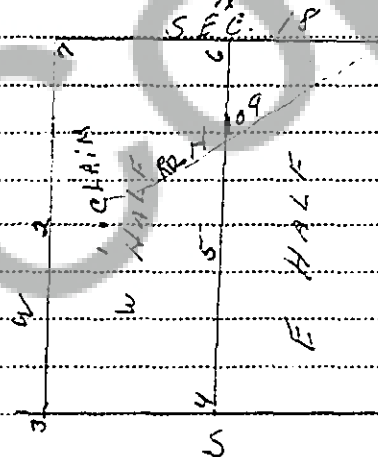
The adjoining claims are None

This notice is placed at discovery on post No. 1; posts are placed at each corner and both center ends, and the name of this lode and date of location are placed on all posts.

Located this 12th day of April, A.D. 1973

Witnesses:

Orville D. Garrett
Wm. F. Garrett

Wm. W. Richardson
Garry E. McEwen
Robert H. Williams

7635 SE 82nd Ave
Portland, Ore Locator.
97266