

75783

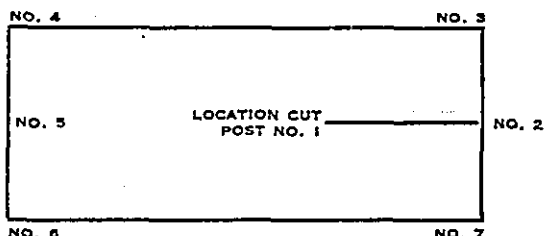

Notice of Mining Location

STATE OF WASHINGTON
 County of SKAMANIA
Mt ST. HELENS Mining District

NOTICE IS HEREBY GIVEN That the undersigned, having complied with the requirements of Chapter Six of Title Thirty-Two, of the revised statutes of the United States, and the laws of the above State, and the local customs and regulations of said District ha..... located and do..... hereby locate..... linear feet in length, and..... feet in width on the Mt St. Helens lode, (Name of)

Commencing at a post marked No. 1 at the Discovery shaft (cut or tunnel), from thence.....
 feet in a..... direction to an end post marked No. 2, thence
 feet in a..... direction to a corner post marked No. 3, thence
 feet in a..... direction to a corner post marked No. 4, thence
 feet in a..... direction to an end post marked No. 5, thence
 feet in a..... direction to a corner post marked No. 6, thence
 feet in a..... direction to a corner post marked No. 7, thence
 feet in a..... direction to said end post marked No. 2; hereby
 locating and intending to claim..... feet in a.....

direction from discovery to the..... end line and.....
 feet in the opposite direction from discovery to the..... end line and.....
 feet on each side of the middle of said lode or ledge, for the purpose of mining the same and claiming all the surface rights, privileges and minerals, with all dips, spurs, angles and variations, and other rights granted by existing laws and customs. This claim is further described as follows (and state distance from natural object or permanent monument, Section, Township and Range, if possible):

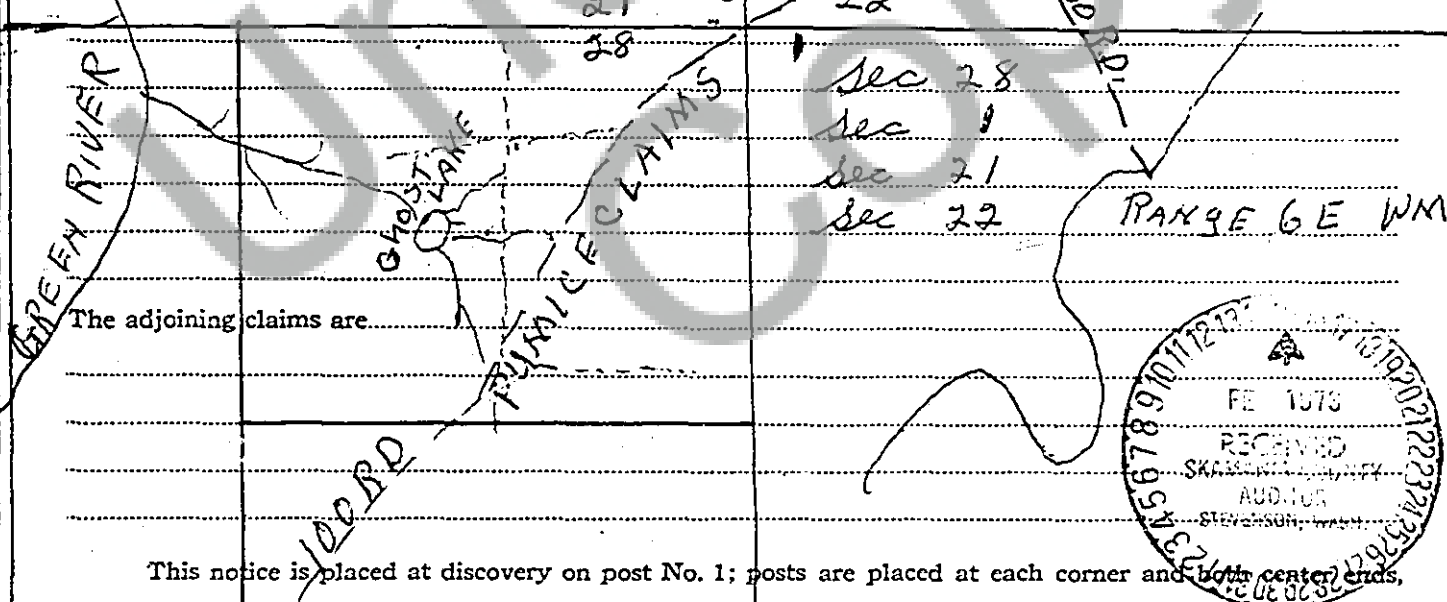

This notice is placed at discovery on post No. 1; posts are placed at each corner and both center ends, and the name of this lode and date of location are placed on all posts.

Located this June 15 day of....., A.D. 1972.

Witnesses:

a group of 14 claims

J. R. Pope

Wm. W. W. W.

R. L. Schmitt

Box 381

Napauna Wash.

R. C. Townsend Sec

Mt St Helens Mining Assn Locator.

Box 245

Mt St Helens Napauna, Ore 98565