

73565

## Notice of Mining Location

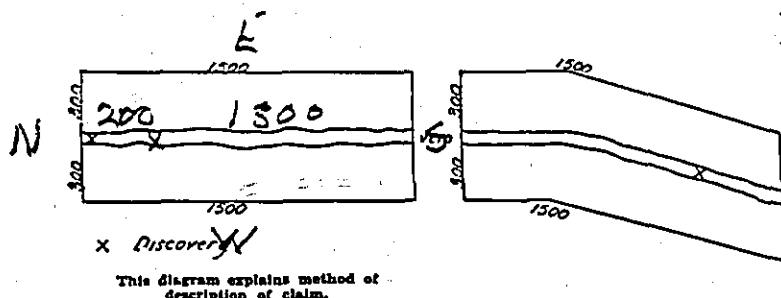

WASHINGTON State

SKAMANIA County

Sec 13 T4N R5E Mining District

NOTICE IS HEREBY GIVEN That the undersigned, having complied with the requirements of Chapter six of Title thirty-two of the Revised Statutes of the United States, and the laws of the

above State, and the local customs and regulations of said District, ha\_\_\_\_\_ located and do. ☒

hereby locate 1500 linear feet in length, and 600 feet in width on the

HADA #3 lode, vein, ledge or deposit (or placer ground), situated in the above State, County and Mining District, and further described as follows: Commencing at a post marked No. 1 at the Discovery shaft (cut or tunnel),

from thence APPROX 200 feet in a NORTHERLY direction to an end post marked

No. 2, thence APPROX 300 feet in a EAST-ELY direction to a corner post marked

No. 3, thence 1500 feet in a SOUTHERLY direction to a corner post marked

No. 4, thence 600 feet in a WESTERLY direction to a corner post marked

No. 5, thence 1500 feet in a NORTHERLY direction to a corner post marked

No. 6, thence APPROX 300 feet in a EAST-ELY direction to said end post No. 2;

hereby locating and intending to claim APPROX 200 feet in a NORTHERLY

direction from discovery to the BOUNDARY end line.

and 1300 feet in the opposite direction from discovery to the SOUTHERN

BOUNDARY end line and 300 E + W feet on each side of the middle of said lode or ledge, for the purpose of mining the same and claiming all surface rights, privileges, and minerals, with all dips, spurs, angles and variations, and other rights granted by existing laws and customs.

This claim is further described as follows:

Borders CLAIM #2 on the west side + will include FOREST SERVICE ROAD N413 + GREEN FORK CREEK IN PART.

ZIG ZAG AREA Lewis River Mine in 9 DIST.

This notice is placed at Discovery on post No. 1; posts are placed at each corner, and the name of this lode, and date of location, are placed on all posts.

Located FIFTEENTH day of JUNE, A. D. 1971.

WITNESSES:

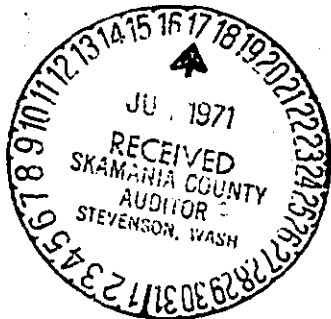

Horace L. Atton  
Art Dennis

HADA ENTERPRISES

Locators.