

AMENDMENT to Richardson Lode registered Nov. 2, 1970

Notice of Mining Location

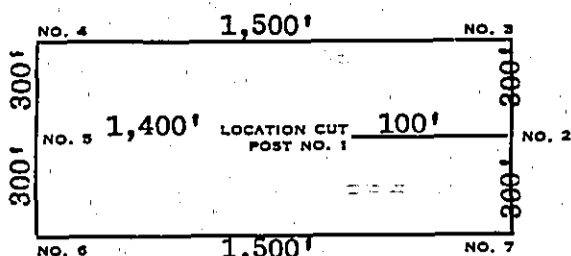

STATE OF ~~OREGON~~, Washington

County of Skamania

..... Mining District

NOTICE IS HEREBY GIVEN That the undersigned, having complied with the requirements of Chapter Six of Title Thirty-Two, of the revised statutes of the United States, and the laws of the above State, and the local customs and regulations of said District ha^s..... located and do^{es}..... hereby locate 1,500' linear feet in length, and 600' feet in width on the Richardson lode, vein, ledge or deposit situated in the above State, County and Mining District, and further described as follows:

Commencing at a post marked No. 1 at the Discovery shaft (cut or tunnel), from thence 100' feet in a Southeasterly direction to an end post marked No. 2, thence 300' feet in a Northeasterly direction to a corner post marked No. 3, thence 1,500' feet in a 50° Northwest direction to a corner post marked No. 4, thence 300' feet in a Westerly direction to an end post marked No. 5, thence 300' feet in a Westerly direction to a corner post marked No. 6, thence 1,500' feet in a 50° Southeasterly direction to a corner post marked No. 7, thence 300' feet in a Northeasterly direction to said end post marked No. 2; hereby locating and intending to claim 1,400' feet in a Northwest 50° direction from discovery to the #5 end line and 100' feet in the opposite direction from discovery to the #2 end line and 300'

feet on each side of the middle of said lode or ledge, for the purpose of mining the same and claiming all the surface rights, privileges and minerals, with all dips, spurs, angles and variations, and other rights granted by existing laws and customs. This claim is further described as follows (and state distance from natural object or permanent monument, Section, Township and Range, if possible): Sec. 17 T4N R5E WM Discovery point 600' S. W. of Slide Creek Bridge along Lewis River Rd. Center line to start at center of Lewis River, thence in an Easterly direction 300' to post #3, thence to join Little Trinkle #1 claim, thence 1,500' at a Northwesterly 50° angle, thence 300' in a Westerly direction to post #5, thence 300' Westerly to post #6, thence 1,500' in a Southeasterly 50° direction, thence 300' Northeasterly to post #2

The adjoining claims are Big Trinkle placer to the North on Slide Creek and Little Trinkle #1 & #2 on the N. E. side of Lewis River, 600' from River center, with all lodes claimed within boundary.

This notice is placed at discovery on post No. 1; posts are placed at each corner and both center ends, and the name of this lode and date of location are placed on all posts.

Located this 1st day of March, A.D. 1971.....

Barbara A. Jones
Notary Public in and for the State of Washington residing at Stevenson, Wash.

Ned. N. Richardson

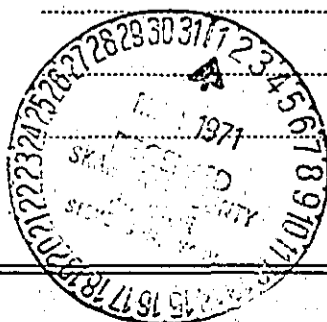

Locator.