

NOTICE OF LOCATION
LODE MINING CLAIM

TO WHOM IT MAY CONCERN:

This mining claim, the name of which is the Anne 26 was located by the undersigned on the 8th day of October, 1970. Said claim is 1500 feet long and 600 feet wide, 300 feet on each side of the centerline of said claim, the course of which is from North West to South East. This NOTICE OF LOCATION is posted on the centerline 50 feet from the South end and 1450 feet from the North end. This claim is located in the Green River Mining District, in Skamania County, State of Washington, about 2900 feet in a Westerly direction from the E. 1/4 Cor. Sec. 8, T10N, R6E, W3M.

and is described as follows:

Beginning at the South East corner, a wooden post,
thence Northerly, 1500 feet to the North East corner,
a wooden post,
thence Westerly, 600 feet to the North West corner,
a wooden post,
thence Southenly, 1500 feet to the South West corner
a blazed tree,
thence Easterly, 600 feet to the point of beginning.

Joseph E. Shann
agent for Deval Corp

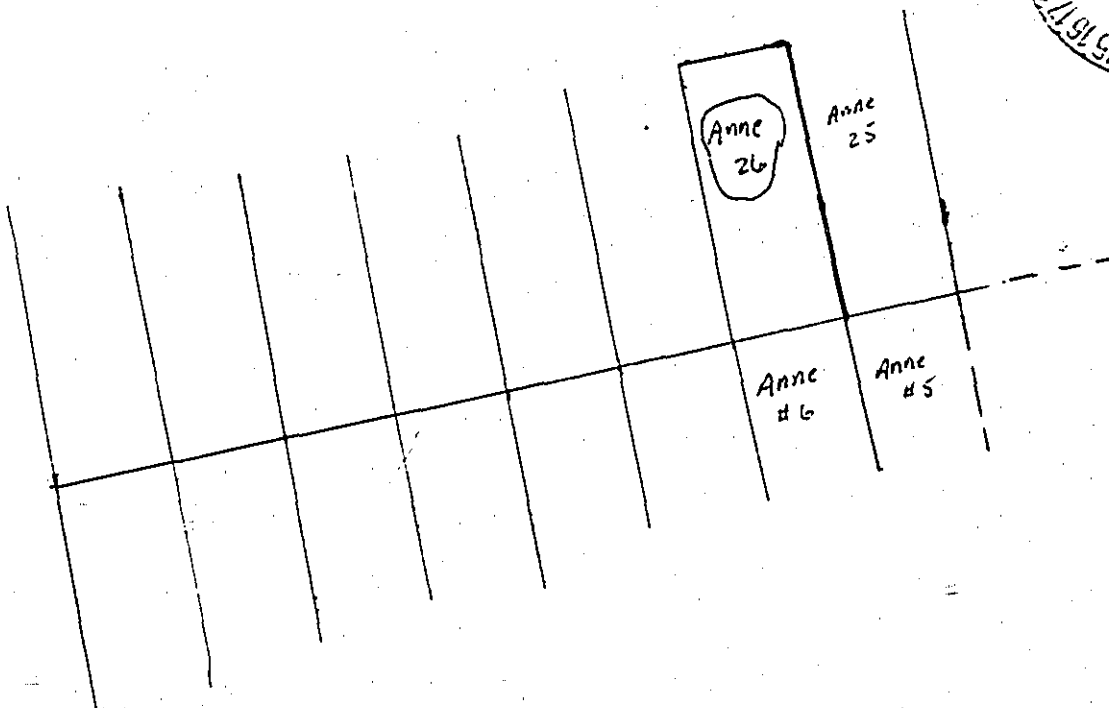
Witness: Harren C. ShannSketch of ClaimE 1/4 Cor.
Sec. 8