

LOCATION NOTICE

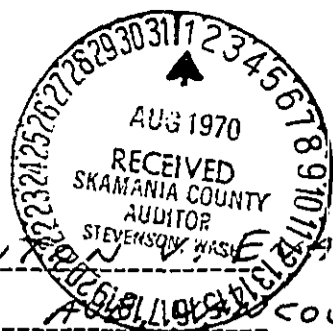

Know All Men by These Presents That ROY EVALT & ANTON
& RALPH D. EVALT 8603 NE 107TH
WASHINGTON 98662

the undersigned citizens YES of the United States, has this FIRST day of
AUGUST 1970, located and claimed, and by these presents do ES
 locate and claim, by right of discovery and location, in compliance with the Mining Act of Congress,

approved May 10, 1872, and all subsequent Acts, and with local customs, laws and regulations, CLAIMS
SINGLE CLAIM

1,320 FT. linear feet and horizontal measurement on the ORE SILVER
NO OTHER INDICATIONS SHOWING.

CERARGRITE lode, vein, ledge or deposit along the vein thereof, with all its dips,
 angles and variations, as allowed by law, together with 660 feet ONE EACH SOUTH

NORTH side and 1,320 FT 660 feet on the 1,320 FT RUNNING NORTH TO SOUTH side of the middle
 of said vein at the surface, so far as can be determined from present developments; and all veins,

lodes, ledges or deposits and surface ground, within the lines of said claim 15 330 feet
 running DUE EAST from center of discovery 330 FT, and 1,320 FT,

feet running DUE SOUTH from center of discovery 1,320 FT; said discovery

15 being situated upon said lode, vein, ledge or deposit, and within the lines

of said claim, in T4N R5E Mining District, SECTION 17 SW 40 NE 4 APPROX. PINCHOT NATIONAL FOREST

SECTION 4 CLAIM IS LOCATED SOUTH OF JUNCTION OF SLIDE CR. & EAST FORK OF
 bounds as follows, to-wit: LEWIS RIVER

BEGINNING at Cor. No. 1 (the EAST corner), running thence DUE WEST
 feet 330, to a post marked CENTERLINE EVALT'S CLAIM; thence 330
 feet DUE WEST, to a post marked NWEST corner (Cor. No. 2); thence DUE SOUTH
 feet 1,320 FT, to a post marked SOUTH WEST corner (Cor. No. 3); thence DUE EAST
 feet 660 FT, to a post marked SOUTHEAST CORNER; thence 1,320 feet
DUE NORTH, to a post marked EAST corner (Cor. No. 4); thence _____ feet
 to a post marked _____ corner, the place beginning.

This claim is further described as follows: The point of discovery upon which this notice is
 posted is in a EASTERLY direction from the center of the SUNSET FALLS end
 line, distant ONE MILE & 4 FEET. From Cor. No. NORTH WEST CORNER CLAIM
 bears 660 FT DUE distant 70 NE CORNER and DUE SOUTH 1,320 FT TO THE
SOUTHEAST CORNER EAST AND bears WEST 660 FT TO WEST distant BORDERED.

THE ORE VEIN & CENTER OF CLAIM IS DIRECTLY SOUTH OF
THE JUNCTION OF SLIDE CREEK & THE EAST FORK OF THE LEWIS
RIVER & THE CLAIM LAYS SOUTH FROM CENTER OF LEWIS RIVER 1320 FT

This claim to be known as the EVALT'S SILVER MINE #4 CLAIM

Discovered JULY 23 1970

Located AUGUST 1ST 1970

Black V. Becker (Seal) 3920

James H. Lencow (Seal)

Witnesses:

Billie L. Mathews

Ralph D. Walt (Seal)

Anton V. Evalt (Seal)

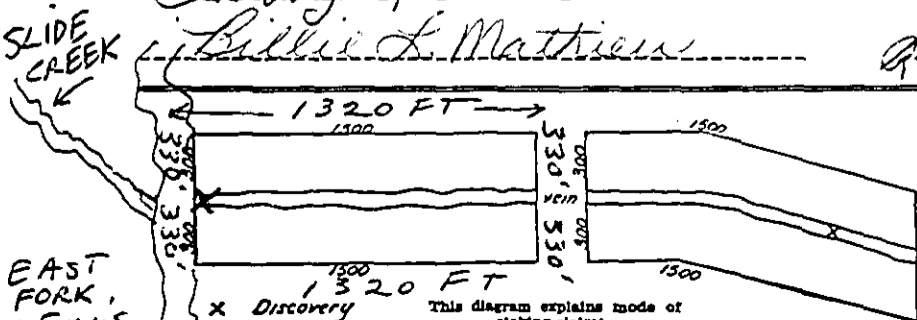

THIS CLAIM BORDERS & PARALLELS
 EVALT'S CLAIM # 3
 ON ITS EAST BORDER,
 & EXTENDS INTO SECTION
 SUBDIVISION NW 40 SW 4
 R 5E, SLIGHTLY