

## EXPLANATION OF TERMS USED IN STAND DESCRIPTION

Inventory information is based on random samples, and is not reliable as a source for accurate appraisals of merchantable volumes or values. The information is usable as a preliminary management tool, which should be followed by more intensively gathered information as the need for it becomes apparent.

Stand Number: Areas of some degree of uniformity in species, age and stocking density are assigned a number for later reference in referring to specific stand types.

Acres: Acreage is an approximate, as are most stand type boundaries.

Species: The most abundant species or combination of two species in the stand is used to describe the type:

DF = Douglas-fir	TF = True Firs	WP = White Pine	BLM = Big Leaf Maple
WH = Western Hemlock	PP = Ponderosa Pine	L = Larch	BC = Black Cottonwood
RC = Western Red Cedar	LP = Logdepole Pine	RA = Red Alder	HWD = Other Hardwood
Other _____ = _____		Other _____ = _____	

Site Index: This is measure of the suitability of the area for tree growth:  
Low = poor site, Medium = fair site, High = good site.

Age: Average age of the trees in the stand.

Percent Stocking: This is an indication of the relationship between potential full stocking and the actual stand stocking.  
e.g., 50% =  $\frac{1}{2}$  of potential stocking.

Volume per acre: This is the estimated amount of wood in thousands of board feet per acre. This volume is an estimate only and is not reliable for any use other than as a general reference. Any proposed commercial sale will require a much more thorough examination to determine volume.

Additional information to be included with this plan and provided to landowner. Check \_\_\_\_.

_____ Tax Information - Specific _____	
_____ Forest Practice Application	_____ Consulting Foresters List
_____ Forest Practice Booklet	_____ Glossary of Forest Terms
_____ Reforestation Brochure	_____ Sample Contracts
_____ Planting Guide	_____ Current Log Prices
_____ Forestry With Confidence Booklet	_____ Forest Fire Protection Laws Booklet
_____ Cost-Share Information	
_____ Insect and Disease Information - Specific _____	
_____ T.S.I. Information - Specific _____	
_____ Other _____	
_____ Other _____	

~~Page~~ G PAGE 866

DEPARTMENT OF NATURAL RESOURCES - FOREST MANAGEMENT PLAN

Landowner John Dalen

Address M.P. 17.74 L S.R. 140

Phone: Work \_\_\_\_\_ Home (206) 837-3183

Washougal, WA 98671

Topographic Symbols

Property Boundary=

Improved Road =

Unimproved Road=

Stand Boundary=

Stand Number= ③

Year-Round Stream=

Intermittent Stream=

Swamp or Marsh=

Buildings=

Other =

Other =

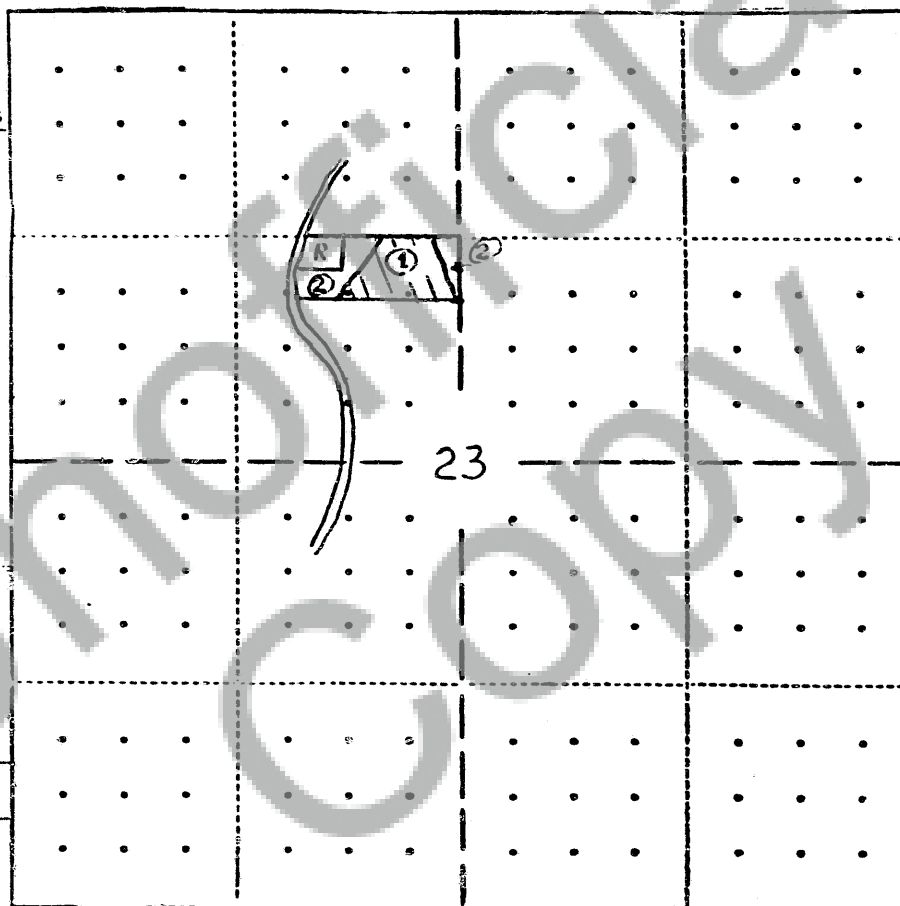

Legal:

Section

23

Township

3N

Range

8E

County

SKAMANIA



Scale

1"=1,000'

Cost-Share

Yr. \_\_\_\_\_

ACP \_\_\_\_\_

FIP \_\_\_\_\_

LTA \_\_\_\_\_

STAND DESCRIPTION  
(Explained on Reverse Side)

Stand Number	Acres	Species	Site Low-Med High	Age	Percent Stocking	Volume/Acre MBF Estimated	Other Stand Description: logged, field, brush, etc
1	3	DF	Med	80	100	35	
2	2	DF	Med	12	60	N/A	Some scattered dead trees.
idental	1 1/2						Cleared home site

Landowner: John Dalen

Examiner: Dexter McPherson

Landowners management objectives: Manage timber land for sustained timber yield.

Stand #1: Thin to 25' x 25' spacing, leaving dominant trees to grow to final harvest.

Stand #2: Remove scattered seed trees leaving young stand to grow. Young stand should be thinned to 12' x 12' spacing sometime before age 20.

Examiner Dexter McPherson Area Southwest Date Examined 11-22-83

Title Local Manager Phone (206) 577-2025

Checked by \_\_\_\_\_