

74261

APPLICATION FOR CLASSIFICATION AS FARM AND AGRICULTURAL LAND  
FOR CURRENT USE ASSESSMENT UNDER RCW 84.34

FILE WITH THE COUNTY ASSESSOR

Name of Applicant Walter C. Baker Phone 493-1764Address UnderwoodProperty Location Skamania Co - Underwood Heights1. Interest in Property: Fee Owner Fee yes Contract Purchaser

Other (Describe Interest)

2. Legal description of land to be classified: 42-34Assessor's Parcel or Account Numbers 3-10-21-C 4003. Total acres in application 15.764. Total acres in cultivation 15.76

5. Total acres of grazing land

6. Is grazing land cultivated?

7. Total acres in farm woodlot

8. List property rented to others which is not affiliated with agricultural use and show the location on the map.none9. Is land subject to lease or agreement which permits any other use than its present use?  
Yes No no (If yes, attach copy of lease or agreement.)

10. Describe the present current use of each parcel of land that is the subject of this application:

Orchard 4AHay 11.76 A

11. Describe the present improvements on this property (buildings, etc.)

2 cabins1 machine shed

12. Attach a map of the property or use the map on page 4 to show an outline of the current use of each acre of the property such as: livestock (type), row crops, hay land, pasture, wasteland, woodlots, etc.

Include on the map, if available, the soil qualities and capabilities also indicate the location of buildings.

PTF 86 (7/73)



- A. Show boundary of land which application applies to and outline the current uses of the property.
- B. Show buildings as ☒ house ☐ barn, etc. also sketch in roads and rivers.

FILE WITH THE COUNTY ASSESSOR

Name of Applicant \_\_\_\_\_

Address \_\_\_\_\_

Property Location \_\_\_\_\_

1. Interest in Property: \_\_\_\_\_

Other (Describe Interest) \_\_\_\_\_

2. Legal description of \_\_\_\_\_

Assessor's Parcel or \_\_\_\_\_

3. Total acres in applic \_\_\_\_\_

4. Total acres in culti \_\_\_\_\_

5. Total acres of grazin \_\_\_\_\_

6. Is grazing land culti \_\_\_\_\_

7. Total acres in farm w \_\_\_\_\_

8. List property rented the location on the \_\_\_\_\_

9. Is land subject to le  
Yes \_\_\_\_\_ No h

10. Describe the present application: \_\_\_\_\_

11. Describe the present \_\_\_\_\_  
\_\_\_\_\_

12. Attach a map of the use of each acre of wasteland, woodlots, \_\_\_\_\_

Include on the map, location of building \_\_\_\_\_

PTF 86 (7/73)

Stamania County Washington

N9 2071

Stevenson, Washington

Date Dec. 24, 1974

RECEIVED FROM

Stamania County

25.00

For \_\_\_\_\_ Dollars

For your application

3-10-71-8-400

Stamania County TreasurerDavid O. Russell  
County TreasurerBy Beverly O. Russell  
Deputy Treasurer

Stamania County Printer - Astoria, Wash.

CREDIT TO	
State School	
County School	
Public & Private	
Game	
Motor Vehicle	
Dr. Education	
Co. Current Expense	
County Road	
Equip. & R. & Rd.	
Fire Insur.	25.00
School Dist.	
PUD No. 1	
TOTAL	25.00



13. NOTE: To qualify for agricultural classification, an application on land of less than 20 acres must meet certain minimum income standards (see definition of agricultural land (b) and (c)). Please supply the following or any other pertinent data to show that the land will qualify for classification.
14. What is the yield per acre for last five (5) years Fruit & Veg. Hay 3 T  
(bushels, pounds, tons, etc.)
15. List the annual gross income per acre for the last five (5) years : 215<sup>00</sup> per acre.
16. If land is rented or leased list the annual gross rental fee for the last five (5) years.

**PAST AND AGRICULTURAL LAND MEANS EITHER:**

- (a) Land in any contiguous ownership of twenty or more acres devoted primarily to the production of livestock or agricultural commodities for commercial purposes; or
- (b) Any parcel of land five acres or more but less than twenty acres devoted primarily to agricultural uses which has produced a gross income from agricultural uses equivalent to one hundred dollars or more per acre per year for three of the five calendar years preceding the date of application for classification under this chapter; or
- (c) Any parcel of land of less than five acres devoted primarily to agricultural uses which has produced a gross income of one thousand dollars or more per year for three of the five calendar years preceding the date of application for classification under this chapter.
- (d) Agricultural lands shall also include any parcel of land of one to five acres, which is not contiguous, but which otherwise constitutes an integral part of farming operations being conducted on land qualifying under this section as "farm and agricultural lands."
- (e) Agricultural lands shall also include farm woodlots of less than twenty and more than five acres and the land on which appurtenances necessary to the production, preparation or sale of the agricultural products exist in conjunction with the lands producing such products.

**NOTICE:** The assessor may require the owners to submit pertinent data regarding the use of the classified land, productivity of typical crops, income, etc.

1. Upon removal of the county treasurer's additional:
  - (a) The difference between the amount had the
  - (b) Interest charged
  - (c) A penalty applied
  - (2) be requested
2. The additional if the removal:
  - (a) Transferred to State
  - (b) A taking to an of such
  - (c) Sale of least
  - (d) A natural rather than proper
  - (e) Official city with land.
  - (f) Transferred pursuant

As owner(s)  
that I am aware  
under the provi  
I also decl  
accompanying do  
correct, and co

Subscribed and  
day of *12*

Notary Public in

Working

Residing at 0

FOR ASSESSOR'S

Date application

Date application

Amount of fee or

Date application \_\_\_\_\_

Owner notified

**Auditor's File**

1997, 1998, 1999, 2000, 2001, 2002, 2003, 2004, 2005, 2006, 2007, 2008, 2009, 2010, 2011, 2012, 2013, 2014, 2015, 2016, 2017, 2018, 2019, 2020, 2021, 2022, 2023, 2024, 2025, 2026, 2027, 2028, 2029, 2030, 2031, 2032, 2033, 2034, 2035, 2036, 2037, 2038, 2039, 2040, 2041, 2042, 2043, 2044, 2045, 2046, 2047, 2048, 2049, 2050, 2051, 2052, 2053, 2054, 2055, 2056, 2057, 2058, 2059, 2060, 2061, 2062, 2063, 2064, 2065, 2066, 2067, 2068, 2069, 2070, 2071, 2072, 2073, 2074, 2075, 2076, 2077, 2078, 2079, 2080, 2081, 2082, 2083, 2084, 2085, 2086, 2087, 2088, 2089, 2090, 2091, 2092, 2093, 2094, 2095, 2096, 2097, 2098, 2099, 2100, 2101, 2102, 2103, 2104, 2105, 2106, 2107, 2108, 2109, 2110, 2111, 2112, 2113, 2114, 2115, 2116, 2117, 2118, 2119, 2120, 2121, 2122, 2123, 2124, 2125, 2126, 2127, 2128, 2129, 2130, 2131, 2132, 2133, 2134, 2135, 2136, 2137, 2138, 2139, 2140, 2141, 2142, 2143, 2144, 2145, 2146, 2147, 2148, 2149, 2150, 2151, 2152, 2153, 2154, 2155, 2156, 2157, 2158, 2159, 2160, 2161, 2162, 2163, 2164, 2165, 2166, 2167, 2168, 2169, 2170, 2171, 2172, 2173, 2174, 2175, 2176, 2177, 2178, 2179, 2180, 2181, 2182, 2183, 2184, 2185, 2186, 2187, 2188, 2189, 2190, 2191, 2192, 2193, 2194, 2195, 2196, 2197, 2198, 2199, 2200, 2201, 2202, 2203, 2204, 2205, 2206, 2207, 2208, 2209, 2210, 2211, 2212, 2213, 2214, 2215, 2216, 2217, 2218, 2219, 2220, 2221, 2222, 2223, 2224, 2225, 2226, 2227, 2228, 2229, 2230, 2231, 2232, 2233, 2234, 2235, 2236, 2237, 2238, 2239, 2240, 2241, 2242, 2243, 2244, 2245, 2246, 2247, 2248, 2249, 2250, 2251, 2252, 2253, 2254, 2255, 2256, 2257, 2258, 2259, 2260, 2261, 2262, 2263, 2264, 2265, 2266, 2267, 2268, 2269, 2270, 2271, 2272, 2273, 2274, 2275, 2276, 2277, 2278, 2279, 2280, 2281, 2282, 2283, 2284, 2285, 2286, 2287, 2288, 2289, 2290, 2291, 2292, 2293, 2294, 2295, 2296, 2297, 2298, 2299, 2300, 2301, 2302, 2303, 2304, 2305, 2306, 2307, 2308, 2309, 2310, 2311, 2312, 2313, 2314, 2315, 2316, 2317, 2318, 2319, 2320, 2321, 2322, 2323, 2324, 2325, 2326, 2327, 2328, 2329, 2330, 2331, 2332, 2333, 2334, 2335, 2336, 2337, 2338, 2339, 2340, 2341, 2342, 2343, 2344, 2345, 2346, 2347, 2348, 2349, 2350, 2351, 2352, 2353, 2354, 2355, 2356, 2357, 2358, 2359, 2360, 2361, 2362, 2363, 2364, 2365, 2366, 2367, 2368, 2369, 2370, 2371, 2372, 2373, 2374, 2375, 2376, 2377, 2378, 2379, 2380, 2381, 2382, 2383, 2384, 2385, 2386, 2387, 2388, 2389, 2390, 2391, 2392, 2393, 2394, 2395, 2396, 2397, 2398, 2399, 2400, 2401, 2402, 2403, 2404, 2405, 2406, 2407, 2408, 2409, 2410, 2411, 2412, 2413, 2414, 2415, 2416, 2417, 2418, 2419, 2420, 2421, 2422, 2423, 2424, 2425, 2426, 2427, 2428, 2429, 2430, 2431, 2432, 2433, 2434, 2435, 2436, 2437, 2438, 2439, 2440, 2441, 2442, 2443, 2444, 2445, 2446, 2447, 2448, 2449, 2450, 2451, 2452, 2453, 2454, 2455, 2456, 2457, 2458, 2459, 2460, 2461, 2462, 2463, 2464, 2465, 2466, 2467, 2468, 2469, 2470, 2471, 2472, 2473, 2474, 2475, 2476, 2477, 2478, 2479, 2480, 2481, 2482, 2483, 2484, 2485, 2486, 2487, 2488, 2489, 2490, 2491, 2492, 2493, 2494, 2495, 2496, 2497, 2498, 2499, 2500, 2501, 2502, 2503, 2504, 2505, 2506, 2507, 2508, 2509, 2510, 2511, 2512, 2513, 2514, 2515, 2516, 2517, 2518, 2519, 2520, 2521, 2522, 2523, 2524, 2525, 2526, 2527, 2528, 2529, 2530, 2531, 2532, 2533, 2534, 2535, 2536, 2537, 2538, 2539, 2540, 2541, 2542, 2543, 2544, 2545, 2546, 2547, 2548, 2549, 2550, 2551, 2552, 2553, 2554, 2555, 2556, 2557, 2558, 2559, 2560, 2561, 2562, 2563, 2564, 2565, 2566, 2567, 2568, 2569, 2570, 2571, 2572, 2573, 2574, 2575, 2576, 2577, 2578, 2579, 2580, 2581, 2582, 2583, 2584, 2585, 2586, 2587, 2588, 2589, 2590, 2591, 2592, 2593, 2594, 2595, 2596, 2597, 2598, 2599, 2600, 2601, 2602, 2603, 2604, 2605, 2606, 2607, 2608, 2609, 2610, 2611, 2612, 2613, 2614, 2615, 2616, 2617, 2618, 2619, 2620, 2621, 2622, 2623, 2624, 2625, 2626, 2627, 2628, 2629, 2630, 2631, 2632, 2633, 2634, 2635, 2636, 2637, 2638, 2639, 2640, 2641, 2642, 2643, 2644, 2645, 2646, 2647, 2648, 2649, 2650, 2651, 2652, 2653, 2654, 2655, 2656, 2657, 2658, 2659, 2660, 2661, 2662, 2663, 2664, 2665, 2666, 2667, 2668, 2669, 2670, 2671, 2672, 2673, 2674, 2675, 2676, 2677, 2678, 26



BOOK E PAGE 572

STATEMENT OF ADDITIONAL TAX, INTEREST AND PENALTY DUE  
UPON REMOVAL FROM CLASSIFICATION UNDER RCW 84.34

1. Upon removal, an additional tax shall be imposed which shall be due and payable to the county treasurer on or before April 30 of the following year. The amount of such additional tax shall be equal to:
  - (a) The difference between the property tax paid as "Farm and Agricultural Land" and the amount of property tax otherwise due and payable for the seven years last past had the land not been so classified; plus
  - (b) Interest upon the amounts of the difference (a), paid at the same statutory rate charged on the delinquent property taxes.
  - (c) A penalty of 20% shall be applied to the additional tax if the classified land is applied to some other use, except through compliance with the property owner's request for removal process, or except as a result of those conditions listed in (2) below.
2. The additional tax, interest and penalty specified in (1) above, shall not be imposed if the removal resulted solely from:
  - (a) Transfer to a government entity in exchange for other land located within the State of Washington;
  - (b) A taking through the exercise of the power of eminent domain, or sale or transfer to an entity having the power of eminent domain in anticipation of the exercise of such power;
  - (c) Sale or transfer of land within two years after the death of the owner of at least a fifty percent interest in such land.
  - (d) A natural disaster such as a flood, windstorm, earthquake, or other such calamity rather than by virtue of the act of the landowner changing the use of such property.
  - (e) Official action by an agency of the State of Washington or by the county or city within which the land is located which disallows the present use of such land.
  - (f) Transfer to a church and such land would qualify for property tax exemption pursuant to RCW 84.36.020.

AFFIRMATION

As owner(s) of the land described in this application, I hereby indicate by my signature that I am aware of the potential tax liability involved when the land ceases to be classified under the provisions of RCW 84.34.

I also declare under the penalties for false swearing that this application and any accompanying documents have been examined by me and to the best of my knowledge it is a true, correct, and complete statement.

Subscribed and sworn to before me this 24<sup>th</sup>  
day of December 19 74.

Shirley A. Little  
Notary Public in and for the State of  
Washington  
Residing at Stevenson

OWNER(S) or CONTRACT PURCHASER(S)

Gordon C. Baker  
Gordon C. Baker

(All owners & purchasers must sign)

FOR ASSESSOR'S USE ONLY:

Date application received 12-4-74 By Elmer J. [Signature]  
Amount of fee collected \$ 4-24-75  
Date application approved \_\_\_\_\_ Approved in part \_\_\_\_\_ Denied \_\_\_\_\_  
Owner notified on \_\_\_\_\_ Fee returned on \_\_\_\_\_  
Auditor's File Number # \_\_\_\_\_ Elmer J. [Signature]  
Assessor



LAND INC.

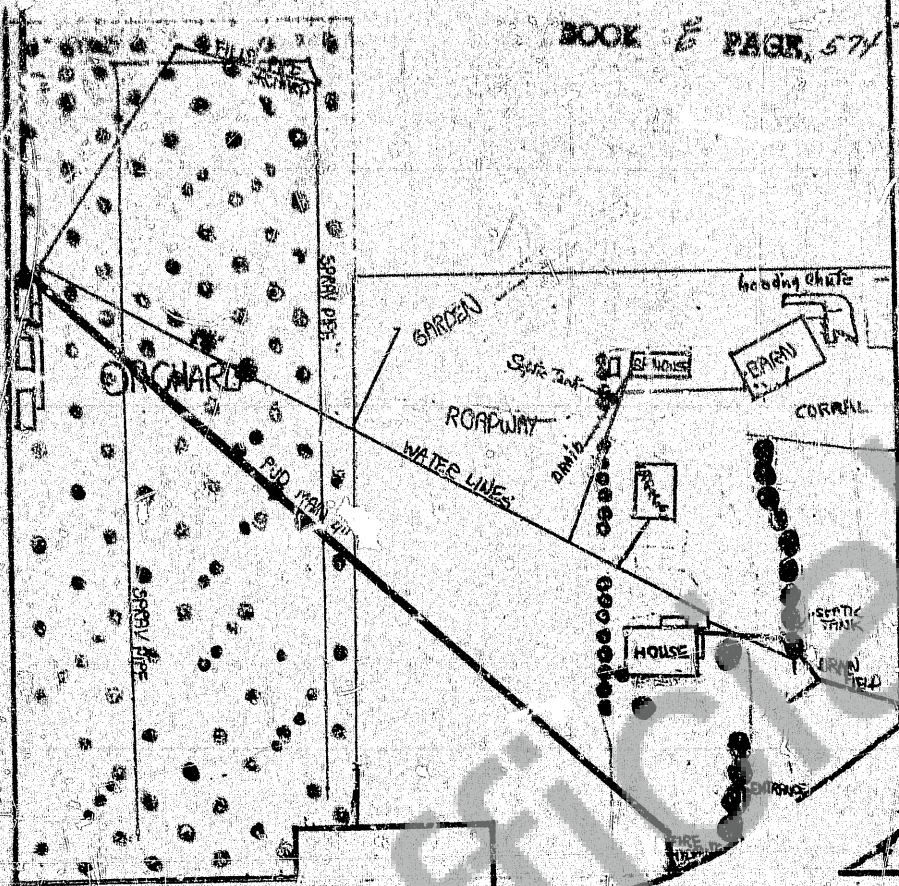

WEST 1/2 OF THE TOWNSHIP 3 N

30 GAL. WATER SERVOIR

PHELPS

GARRETT

UNDERWOOD-COOK HWY

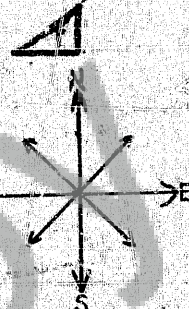

MAP BY CREG BAKER

Columbia Crest Farm  
OWNERS - GORDON AND BETTY BAKER

ACREAGE DATA - APPROXIMATE

1/4 ACRE - FARMSTEAD AREA - INCLUDES HOUSE, GARAGE, BATHHOUSE AND ROADWAYS

1/4 ACRE - CORRAL AREA - INCLUDES BARN AND LOADING CHUTE

1 ACRE - ORCHARD

1/2 ACRE - GRASS FIELD EAST OF HOUSE

1/4 ACRE - UNDERWOOD COOK HWY AND WASTE LAND IN SOUTHEAST CORNER OF PROPERTY

1/2 ACRE - GARDEN, WIND BREAK, AND FENCE LAND LOSS

3 ACRES - HAY

1 INCH = 100 FEET

1976 ACTUAL ACRES

ORCHARD DATA - 125 TREES

125 TREES  
125 TREES  
125 TREES  
125 TREES

ORCHARD LEGEND  
125 TREES  
125 TREES  
125 TREES  
125 TREES





WEST 1/2  
TOWNSHIP

000 GAL.  
WATER  
RESERVOIR



H.  
TERNAHAN

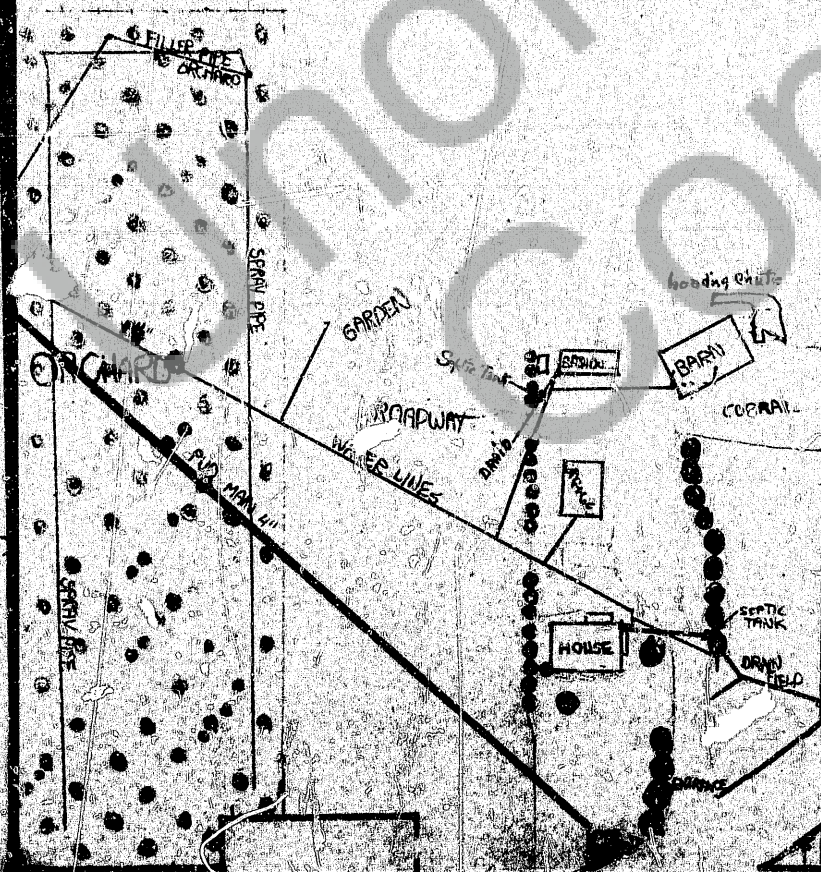

~~ORIGINAL~~



LOCATION

WEST 1/2 OF THE NORTHWEST 1/4 OF SOUTHWEST 1/4 OF SECTION 21  
TOWNSHIP 3 NORTH, RANGE 10 E. W. M.

1,000 GAL.  
WATER  
RESERVOIR

