

RES 20-1809(9-77)

LAND CORNER RECORD

SKAMANIA County
T. 7 N, R. 5E, W.M. Corner Code No. Q/R 8
Segregated Surveys:
Name: C-S SE 1/64 Section 20 Corner No.: C-S SE 1/64 S20
DLC, MES, Tract, Mining Claim, Indian Allotment, Federal Reserve, Townsite.

1. History of Corner Establishment and Subsequent Restoration:

NONE

2. Description of Evidence Found:

NONE

3. Describe Monument, Accessories and Corollary Data to Perpetuate this Corner Location. Diagram corner and indicate meridian and reference to map of record. Surveyor's Field Book No. 259-C Page No. 18 Date of work 8-8-84

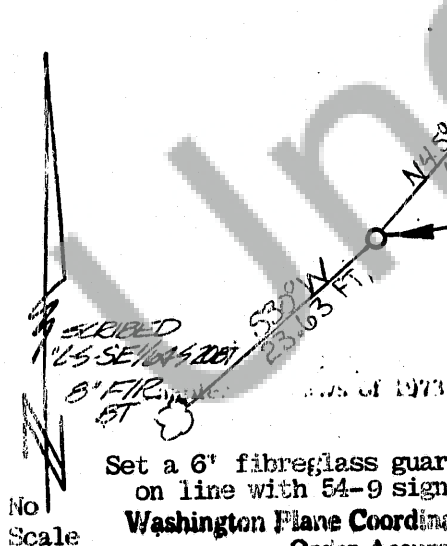

Set a 2 1/2" x 30" Aluminum Pipe, 26" in the ground with an aluminum cap. No stones available within 250' for stone mound. Cleared a 12" circle around monument.

Painted a 6" orange band around all BT's and painted faces.

Attached USFS 54-3 and 54-9 signs on all BT's.

Nailed brass survey washers LS 20898 in the top circle of newly scribed "B"'s and also a point of measurement on side of trees.

Set a 6' fiberglass guard post West 4.20' on line with 54-9 sign.

Washington Plane Coordinates: Zone, Y

Order Accuracy. Derived From:

Pin Pointed on Photo No. Date Located at

SURVEYOR'S CERTIFICATE

This corner record correctly represents work performed by me or under my direction in compliance with the provisions of Chapter 50, Laws of 1973. Date August 10, 1984

Signature: [Signature] Certificate No. 20898



AUDITOR'S CERTIFICATE

Filed for record this 23RD day of AUGUST 1985 at 11:45 A.M. In Book 7/5 of MONUMENTS at page 70 at the request of BUTLER & ZENKER LAND SURVEYORS INC.

Registered S

Indexed, Cir

Incise

Filmed

Mailed

[Signature] County Auditor

Form prescribed by Bureau of Surveys and Maps pursuant to the provisions of Section 5 (2), Chapter 50, Laws of 1973.