

LAND CORNER RECORD

Skamania

County

T. 3 N. R. 7 E. W.M.

Corner Code No. E-25

Segregated Surveys:

Name:

N/A

Corner No.: N/A

DLC, HES, Tract, Mining Claim, Indian Allotment, Federal Reserve, Townsite.

1. History of Corner Establishment and Subsequent Restoration:

G.L.O. Survey by Robert Whitham in 1903

D.N.R. set monument from B.T. stump pattern in 1977.

2. Description of Evidence Found:

Found D.N.R. concrete monument

Down cedar bearing tree N. $43\frac{1}{2}^{\circ}$ W. 52.8 feet40" fir stump S. 60° W. 13.2 feet18" fir N. 44° W. 37.37 to nail in root crown22" fir N. 51° E. 8.52 feet to nail in root crown14" fir S. 24° W. 32.89 feet to nail in root crown

3. Describe Monument, Accessories and Corollary Data to Perpetuate this Corner Location. Diagram corner and indicate meridian and reference to map of record. Surveyor's Field Book No. _____ Page No. _____ Date of work July 10, 1984.

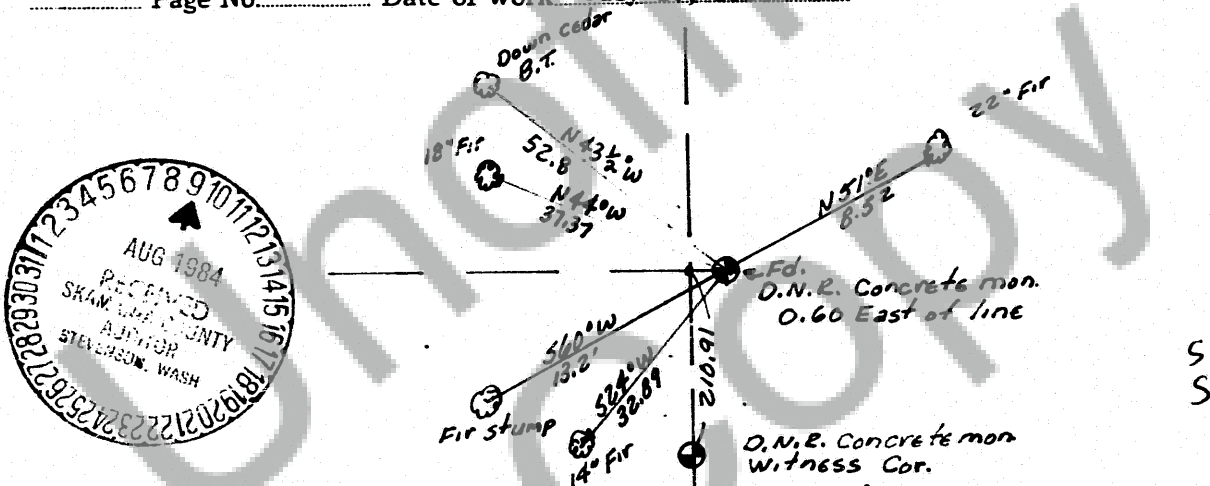
Washington Plane Coordinates: _____ Zone, Y _____, X _____
Order Accuracy. Derived From: _____

Pin Pointed on Photo No. _____ Date _____ Located at _____

SURVEYOR'S CERTIFICATE

This corner record correctly represents work performed by me or under my direction in compliance with the provisions of Chapter 50, Laws of 1973. Date July 31, 1984

Signature _____

11733
Certificate No.

98024

AUDITOR'S CERTIFICATE

Filed for record this 9th day of AUGUST 1984 at 2:20 P.M. In Book 3/7 of MONUMENTS at page 45 at the request of

TENNESON ENGINEERING CORP.

Jill Olson by J. Davis, Dep.
County Auditor

Form prescribed by Bureau of Surveys and Maps pursuant to the provisions of Section 5 (2), Chapter 50, Laws of 1973.

