

RES 20-1803(9-77)

LAND CORNER RECORD

T. 3 N, R. 7 1/2 W.M. Segregated Surveys: SKAMANIA County Corner Code No. D-22

Name: Corner No.:
DLC, RES, Tract, Mining Claim, Indian Allotment, Federal Reserve, Townsite.

1. History of Corner Establishment and Subsequent Restoration:

N/A

2. Description of Evidence Found:

N/A

3. Describe Monument, Accessories and Corollary Data to Perpetuate this Corner Location. Diagram corner and indicate meridian and reference to map of record. Surveyor's Field Book No.

2 Page No. 13 Date of work 6/84

SET 2 1/2" X 30" CONCRETE
MONUMENT WITH
BRASS CAP

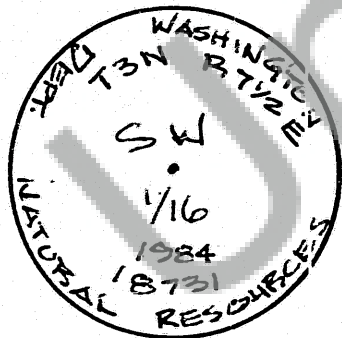

TREES SCRIBED
UPPER BLAZE: SW 1/16 S1
LOWER BLAZE: BT

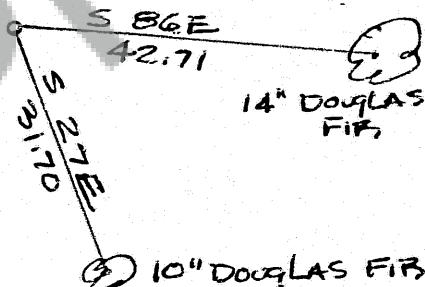

3/4" BRASS DISK "PLS 18731"
NAILED TO LOWER BLAZE

Washington Plane Coordinates: Zone, Y, X
Order Accuracy. Derived From:

Pin Pointed on Photo No. Date Located at

SURVEYOR'S CERTIFICATE

This corner record correctly represents work performed by me or under my direction in compliance with the provisions of Chapter 50, Laws of 1973. Date 6/24/84

Signature Roy O. Gaylord, 18731 Certificate No. 97304



AUDITOR'S CERTIFICATE

Filed for record this 28 day of June 1984 at 12:00 P.M. In Book 3 7 1/2 of Monuments at page 7 at the request of Roy O. Gaylord

Signature Gary M. Olson
County Auditor