

State of Washington  
DEPARTMENT OF NATURAL RESOURCES  
BUREAU OF SURVEYS AND MAPS  
**LAND CORNER RECORD**

Skamania County

T 3 N, R 6 E, W.M.

Corner Code No. A-25

Segregated Surveys:

Name: N/A

Corner Number: N/A

1. History of Corner Establishment and Subsequent Restoration: Originally set by G.L.O. Surveyor, Robert F. Whitham, during 1903 survey.

2. Description of Evidence Found:

2 B.T.'s

1 47" fir snag, 50 feet tall at N61°W - 21.1 feet.

1 40" hemlock stub, at 57°W - 48.8 feet.



3. Describe Monument, Accessories and Corollary Data to Perpetuate this Corner Location. Diagram corner and indicate meridian and reference to map of record. Surveyor's Field Book No. 600.23A, Page No. 56. Date of work 9-14-83.

Shown on D.N.R. F.M. #489

See corner diagram on reverse side.

Set std. D.N.R. concrete monument with stamped brass cap from 2 found B.T.'s.

Washington Plane Coordinates: South Zone, Y 166,117.06, X 1,616,533.21  
Third Order Accuracy. Derived from ties to "Swanberg Photo Control" Tgt's 100 & 101.  
Pin Pointed on Photo No. \_\_\_\_\_, Date \_\_\_\_\_, Located at \_\_\_\_\_.

SURVEYOR'S CERTIFICATE

This corner record correctly represents work performed by me or under my direction in compliance with the provisions of Chapter 50, Laws of 1973.  
Date 2-6-84.

H. Thomas Laird Jr.  
Signature

21490

Certificate No.

[Seal]

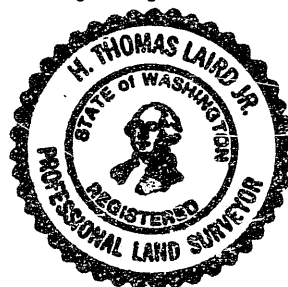

AUDITOR'S CERTIFICATE

Filed for record this 9TH day of FEBRUARY 1984 at 115 P.M.  
In Book 3/6 of MONUMENTS at page 36 at the request  
of Washington State Department of Natural Resources.

J. M. Olson by J. New, Dep.  
County Auditor

G.L.O. 1903

NORTH. 64.65 CH. Creek S.L. WIDE West.  
64.95 Hcm. Post; FROM WHICH  
40" Dead Hemlock S7W 74L.  
40" Dead fir N61 1/4 W 32L

TOWNSHIP

Section CORNER: T4 N 6E 34  
T3 N 1

FOUND: BURNED fir SNAG  
47" Dia, 30 FT. TALL. N61W.  
21.1 Feet. NO SCRIBE

Remains 40" Hcm. STUB

NOW 2 FT. High + VERY DECAYED  
S7W 48.8 Feet. NO SCRIBE

9-14-83

GORDON  
DRESSLER  
Netherton  
GORDMAN

56

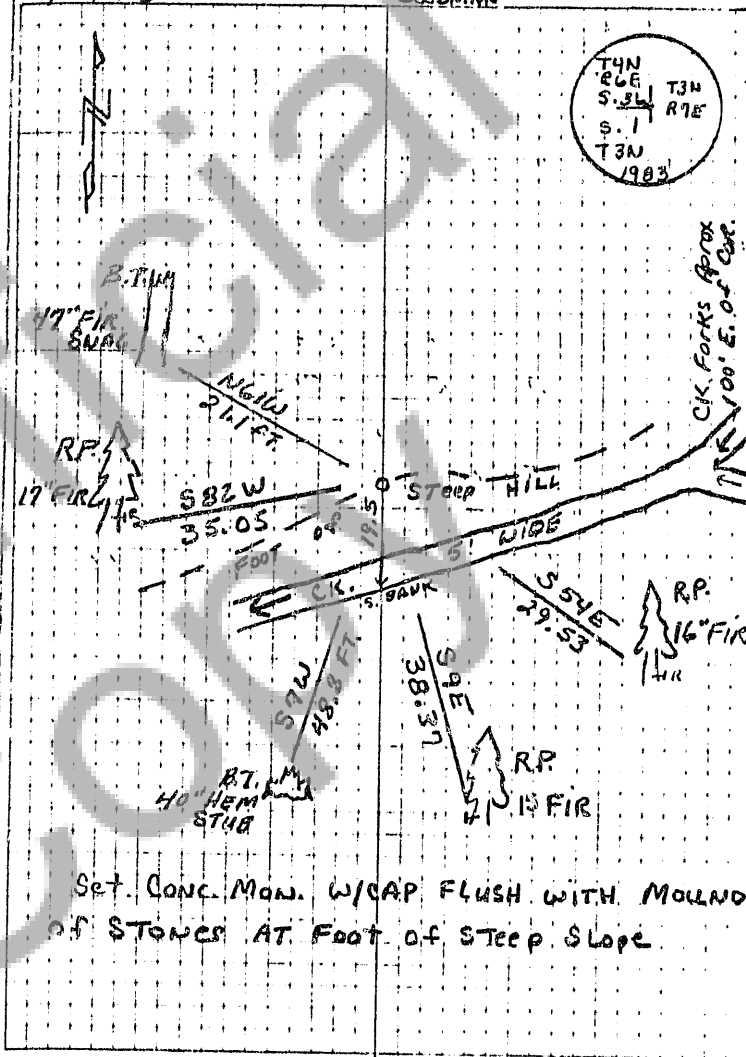

Set. CONC. MON. W/CAP FLUSH WITH MOUND  
OF STONES AT FOOT OF STEEP SLOPE