

LAND CORNER RECORD

Skamania County
 T 3 N, R 10 W, W.M. Corner Code No. J-9
 Segregated Surveys:
 Name: n/a Corner No.: n/a
 DLC, HES, Tract, Mining Claim, Indian Allotment, Federal Reserve, Townsite.

1. History of Corner Establishment and Subsequent Restoration:

Originally set by G.L.O. surveyors, Smith and Spray, in 1875.

A 1" Iron pipe, date and by whom set is unknown. Pipe and bearing trees called by the B.P.A. in 1939.

2. Description of Evidence Found:

Above described 1" iron pipe (replaced).

30" Fir B.T. with bottom of burned face and axe marks at N 60 E, 28.5 feet.

44" Fir B.T. with visible scribing at S 47 E, 24.3 feet.

25" Fir bark collar with axe marks and burned face at S 24 W, 8.4 feet.

20" downed & rotted Fir snag at N 10 W, 31.4 feet.

(2 B.T.'s to south were switched in G.L.O. notes)

3. Describe Monument, Accessories and Corollary Data to Perpetuate this Corner Location. Diagram corner and indicate meridian and reference to map of record. Surveyor's Field Book No. 603.26A Page No. 58 Date of work 10-14-82

Replaced pipe with standard D.N.R. concrete monument with stamped brass cap.

Shown on D.N.R. Final Map # 483.

See corner diagram on reverse side.

Washington Plane Coordinates: South Zone, Y. 155,114.49, X 1,727,484.16
 3rd Order Accuracy. Derived From: Ties to USC & GS "Brought"

Pin Pointed on Photo No. Date Located at

SURVEYOR'S CERTIFICATE

This corner record correctly represents work performed by me or under my direction in compliance with the provisions of Chapter 50, Laws of 1973. Date Dec. 27, 1983

Signature M. A. Kinnaman 11977 Certificate No.



AUDITOR'S CERTIFICATE

Filed for record this 3 day of Jan 1984 at M. In Book 3/10 of Monument at page 31 at the request of Washington State Department of Natural Resources

Gary M. Olson
 County Auditor

to the Department of Natural Resources (2),
 (1) to the Department of Natural Resources (3).

G.L.O. of 1875 by Smith + Spray
 20.00 CH. Set Dogwood Post from which
 36" FIR S50W 37L 24.42
 24" FIR N6SE 47L 31.02
 30" FIR S70E 13L 8.58
 24" FIR N10E SIL 33.66

N.W. CORNER S.16 T3N R10E
 Fd 1st I.P. by F. Post.
 44" FIR STUMP w/UIS. SCRIBE
 S47E 24.3 FT
 35" FIR BACK COLLAR S24W 8.4 FT
 AXE MARK + BURNED FACE
 N60E 30" FIR STUMP 28.5
 Bottom of BURNED FACE + AXE MARK
 20" FIR SNAG, DOWN + ROTTEN N10W
 31.4' NO SCRIBE OR MARKS FD.

In 1939, BPA Colled on iron pine
 and bearing trees

10-14 82

GORDON
 CROSSER

58
 603.26A

T3N
 S8 59
 S17 51L
 R10E
 A82

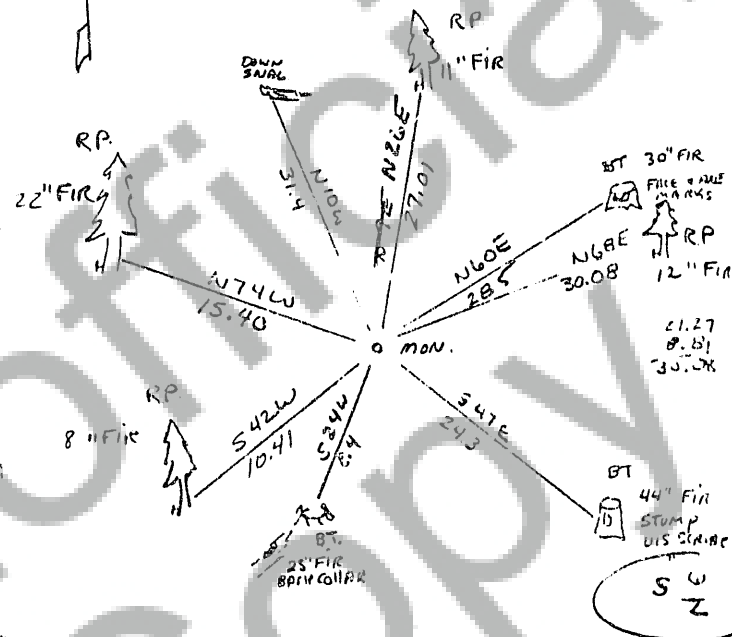

Replaced 1" ID x 18" I.P. WITH CONC. MON
 W/D.N.R. BRASS CAP 6" ABOVE GROUND

RP DIST TO ALUM NAILS BT TAGS UP.