

RES 20-1808(9-77)

LAND CORNER RECORD

Skamania Clark County
 T 2 N, R 4 East, W.M. Corner Code No. V-21
 Segregated Surveys:
 Name: n/a Corner No.: n/a
DLC, HES, Tract, Mining Claim, Indian Allotment, Federal Reserve, Townsite.

1. History of Corner Establishment and Subsequent Restoration:

Originally set by John Truten during 1857 G.L.O. survey. Restored with 3/4" iron pipe set by Fred Law in 1962 from corner 1 mile west. Pipe replaced by John Lawson, L.S. 11989, in 1981 with 2-1/2" iron pipe. In 1938, B.P.A. found 1-1/2" pipe. In 1949, Hwy. Dept. found 1-1/2" pipe. In 1962, Bert Mason used 3/4" pipe. In 1977, Wallace & Assoc. used 3/4" pipe. (See Book 7 pg. 106) In 1979, Alpha Engineers used 3/4" pipe. (See Book 10 pg. 199)

2. Description of Evidence Found:

Above mentioned 2-1/2" iron pipe and stamped brass cap. 3/4" x 36" iron pipe laying alongside Lawson monument. 1-1/2" iron pipe at N 88 W, 125.66 ft. from Lawson monument. Not accepted this survey.

Accepted corner.

3. Describe Monument, Accessories and Corollary Data to Perpetuate this Corner Location. Diagram corner and indicate meridian and reference to map of record. Surveyor's Field Book No. 607.07A Page No. 50 Date of work 19 Jan. '82

Shown on D.N.R. Final Map 441.
 See sketch on back.

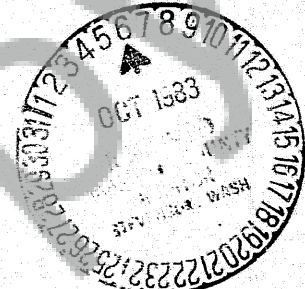

Washington Plane Coordinates: South Zone, Y 110,179.03 - X 1,547,487.71 -
 3rd Order Accuracy. Derived From: USC & GS 'Ells' and DNR 3-3N-4E

Pin Pointed on Photo No. Date Located at

SURVEYOR'S CERTIFICATE

This corner record correctly represents work performed by me or under my direction in compliance with the provisions of Chapter 50, Laws of 1973. Date Sept. 27, 1983

Signature M. O. Kinnaman Certificate No. 11977



AUDITOR'S CERTIFICATE

Filed for record this 6th day of OCTOBER 1983 at 3:00 P.M. In Book 2/4 of MONUMENTS at page 17 at the request of Washington State Department of Natural Resources

M. M. Alton County Auditor

610 survey of 1897
 77.00 Foot of descent & intersect Washougal River
 78.60 Across river
 80.00 Set a post
 Balsm gilead 3" SWW 69L
 Willow 4" N78W 30L
 Alder 3" N42E 15L
 Alder 4" S81E 56L

Section Corner $\frac{26}{25} \frac{125}{36}$ T 2N R 4E

Found 2 1/2" iron pipe w/ brass cap in mound of conc. set by J. Lawson. Pipe sticks up 11". A 3/4" x 36" iron pipe is laying beside mound. The ~~5.00~~ ^{creep coll} 5.00 ch east fits perfectly, as does the 60.50 ch foot of descent coll, which is 20.04 ch west of this corner. The dist. to the S bank of the Washougal (77.00) is within 15' of 610, which is within limits for an even chain coll. We also found a 1 1/2" iron pipe 126' west of Lawsons pipe.

- 1938 - BPA found the 1 1/2" pipe
 - 1949 Highway Dept. notes finding the 1 1/2" pipe.
 - 1962 Fred Laws set 3/4" pipe record dist from corner 1/4 mile west.
 - 1962 Bert Mason used the 1 1/2" pipe
 - 1971 Game Dept used the 3/4" pipe
 - 1977 Wallace & Assoc. used 3/4" pipe book 7 pg 106
 - 1979 Alpha Engrs. used 3/4" pipe book 10 pg 199
- See also LCR by Lawson on file w/ Clark Co. Public Works
 1981 Lawson set 2 1/2" pipe 15' west of 3/4" pipe. book 13 pg 10

1-19-82 Laird Gordon Bressler 50
607.07A

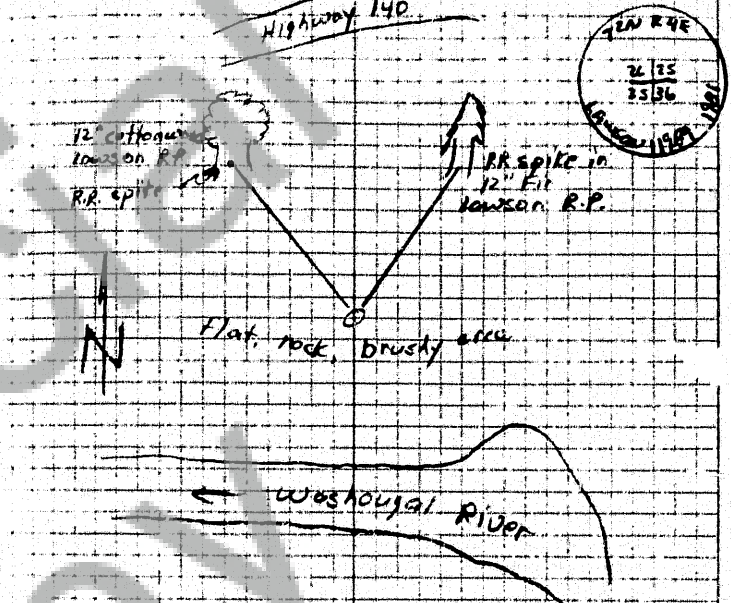

Corner is a 2 1/2" pipe cap set by Lawson. Sometimes covered for high water.

Corner is trav. sta 700, pg 1.
 See pg 1-3 for river mapping south
 See pg 5-10 for river mapping west
 See pg 11-14 for creek mapping east.