

LAWSON
 LAND SURVEYING
 LICENSED WASHINGTON AND OREGON
 (206) 256-8008

JOHN G. LAWSON
 Registered Professional Land Surveyor
 Registered Professional Engineer

Y-Plaza
 14612-A 4th Plain Rd.
 Vancouver, WA 98662

LAND CORNER RECORD

T 3 N, R 8 E, W.M.; Skamania county

Corner Code Number: N-17

Page 1 of 1

Name: Section corner common to Sections 14, 15, 22, 23 ; Corner Number N-17
 DLC, HES Mining Claim, Indian Allotment, Federal Reserve, Townsite

1. History of Corner Establishment and Subsequent Restoration; description of Evidence Found:

No sign of original corner. A fence put in from a compass line from the South bears about 20 feet West. This corner falls on a hillside sloping South. About 20 feet East there is a sharp drop.

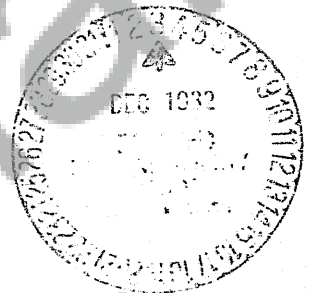

2. Describe Monument, Accessories and Corollary Data to Perpetuate this Corner Location. Diagram corner and indicate meridian and reference to map of record.

LAWSON LAND SURVEYING Job # 25-82-150308 ; Date of Work: June, 1982

Set brass cap in 1-inch galvanized Iron Pipe 3 feet long and referenced it as follows:

- 6-inch Fir, North 53° West, 5.4 feet (scribed)
- 10-inch Fir, North 26° East, 4.2 feet (scribed)
- 8-inch Fir, South 31° East, 8.1 feet (scribed)
- 6-inch Fir, South 5° West, 8.0 feet (scribed)

Washington Plane Coordinates: _____ Zone, Y _____, X _____

Order of Accuracy. Derived from: _____

Pin printed on Photo No. _____ Date _____ Located at _____

SURVEYOR'S CERTIFICATE

This corner record correctly represents work performed by me or under my direction in compliance with the provisions of Chapter 50, Laws of 1973.

Signature John G. Lawson Date Oct 1982
 Certificate Number 11989

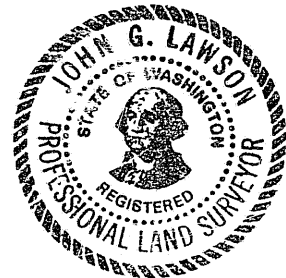

AUDITOR'S CERTIFICATE

Filed for record this 3RD day of DEC., 1982 at 4:00 P.M.
 In book 3/8 of MONUMENTS at Page 39 at the request
 of LAWSON LAND SURVEYING

J. M. C. [Signature]
 County Auditor