

LAWSON
 LAND SURVEYING
 LICENSED WASHINGTON AND OREGON
 (206) 256-8008

JOHN G. LAWSON
 Registered Professional Land Surveyor
 Registered Professional Engineer

Y-Plaza
 14612 A 4th Plain Rd
 Vancouver, WA 98662

LAND CORNER RECORD

T 1 N, R 4 E, W.M.; Clark (Skamania) County

Corner Code Number: C-25

Page 1 of 1

Name: One-quarter corner common to Section 1, Township 1 North, Range 4 Corner East and Section 6, Township 1 North, Range 5 East; Number C-25
 DLC, HES Mining Claim, Indian Allotment, Federal Reserve, Townsite

1. History of Corner Establishment and Subsequent Restoration; description of Evidence Found:

Found the remains of a 36-inch diameter Fir North 10° East 214.5 feet.

The point for the corner falls in an old East-West fence at about record distance from the DLC line to the West

2. Describe Monument, Accessories and Corollary Data to Perpetuate this Corner Location. Diagram corner and indicate meridian and reference to map of record.

LAWSON LAND SURVEYING Job # 13 - 80 - 130104 ; Date of Work: November, 1980

Set a 1-inch galvanized iron pipe with brass cap on the West side of a 40-inch Fir.

Washington Plane Coordinates: _____ Zone, Y _____, X _____

Order of Accuracy. Derived from: _____

Pin Pointed on Photo No. _____ Date _____ Located at _____

SURVEYOR'S CERTIFICATE

This corner record correctly represents work performed by me or under my direction in compliance with the provisions of Chapter 50, Laws of 1973.

Signature John G. Lawson Date Oct 1981
 Certificate Number 11989

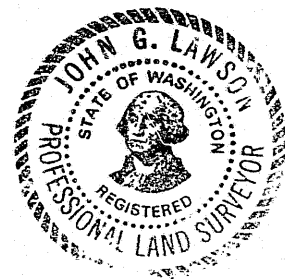

AUDITOR'S CERTIFICATE

Filed for record this 3RD day of DEC., 1982 at 3:35 p.m.
 In book 1/5 of MONUMENTS at Page 18 at the request of LAWSON LAND SURVEYING