

LAND CORNER RECORD

SKAMANIA

County

1615
2122

T 7 N. R 5 E . W.M.
Segregated Surveys:

Corner Code No. N-13

Name:

Corner No.:

DLC, HES, Tract, Mining Claim, Indian Allotment, Federal Reserve, Townsite.

1. History of Corner Establishment and Subsequent Restoration: GLO . STATE DNR Monument set 26 June 1970 by M. Lucas and R. Hardev at position of original stone.

2. Description of Evidence Found: DNR Concrete Monument stamped 1970

- ① 20" Fir stump 6' high S44E 22.0 BT.
 - ② 24" Fir stump 5' high S22W 7.2 BT
 - ③ 30" Fir N6SE 7.5 BT
 - 34" Fir N68W 20.85
 - ① GLO 8" Fir S68 1/2 E 34 links
 - ② 8" Fir S17 1/4 W 12 1/2 links
 - ③ 12" Fir N6SE 13 links
- } FACE OF BT'S

3. Describe Monument, Accessories and Corollary Data to Perpetuate this Corner Location. Diagram corner and indicate meridian and reference to map of record. Surveyor's Field Book No. 9-81 Page No. 17 Date of work 31 Aug 82

- DNR REFERENCE PLATE
- ALUMINUM NAIL

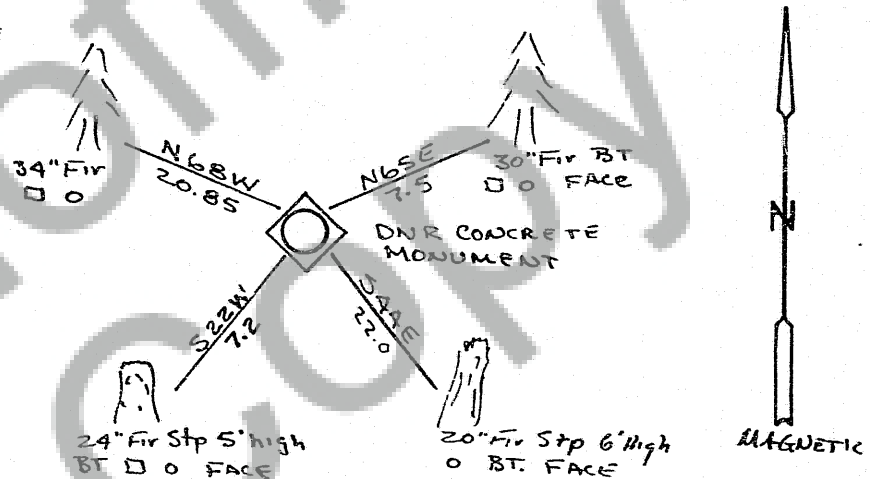

Washington Plane Coordinates: Zone, Y, X
Order Accuracy. Derived From:

Pin Pointed on Photo No. Date Located at

SURVEYOR'S CERTIFICATE

This corner record correctly represents work performed by me or under my direction in compliance with the provisions of Chapter 50, Laws of 1973. Date 8 Nov 82

Signature Archie B Carpenter

Certificate No. 16196



AUDITOR'S CERTIFICATE

Filed for record this 16 day of Nov 1982 at M. In Book 7/5 of Monument at page 54 at the request of

County Auditor