

RES 20-1808(9-77)

95308

LAND CORNER RECORD

SKAMANIA

County

T 4 N, R. 9E W.M.

Corner Code No. V-21

Segregated Surveys:

Name: SECTION COR

Corner No.:

DLC, HES, Tract, Mining Claim, Indian Allotment, Federal Reserve, Townsite.

1. History of Corner Establishment and Subsequent Restoration:

COR. WAS ORIGINALLY SET BY DEPUTY SURVEYOR JACOB RICHARDSON IN OCT.-NOV. 1892 UNDER CONTRACT # 383. IN 1990 WASH. DNR REMON. COR.

2. Description of Evidence Found:

FD BRASS CAP IN CONG. & B.T.'S

3. Describe Monument, Accessories and Corollary Data to Perpetuate this Corner Location. Diagram corner and indicate meridian and reference to map of record. Surveyor's Field Book No.

2 Page No. 13 Date of work 12/83

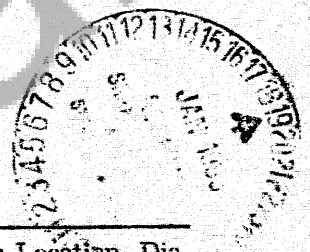
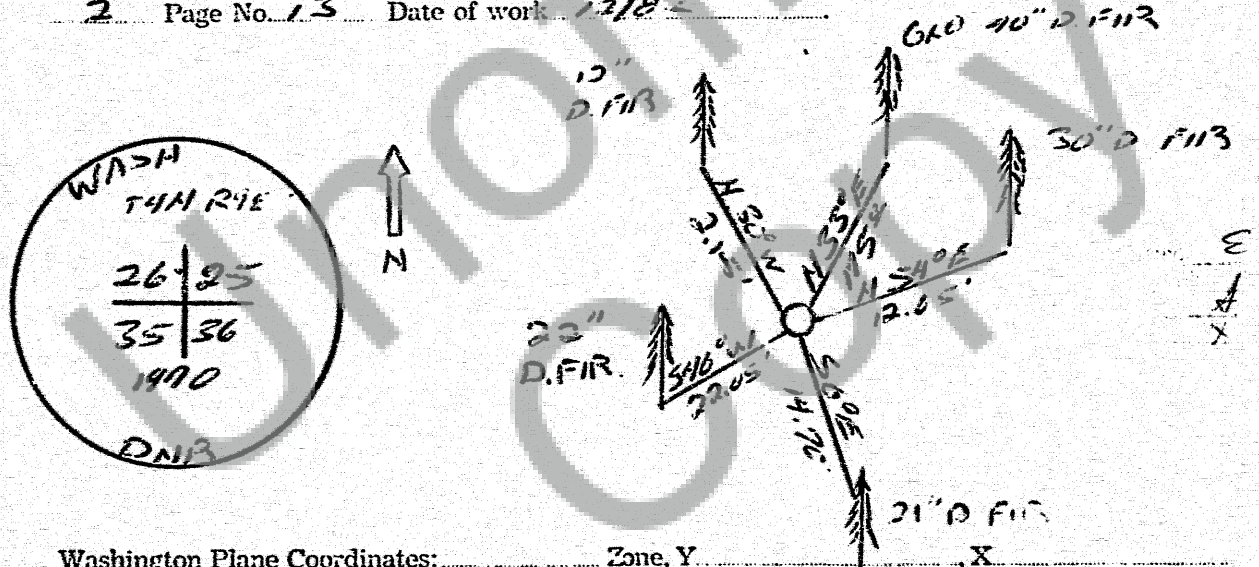

Washington Plane Coordinates: Zone, Y, X

Order Accuracy. Derived From:

Pin Pointed on Photo No. Date Located at

SURVEYOR'S CERTIFICATE

This corner record correctly represents work performed by me or under my direction in compliance with the provisions of Chapter 50, Laws of 1973, Date 1-18-83

Signature [Handwritten] Certificate No. 18731



AUDITOR'S CERTIFICATE

Filed for record this 19 day of Jan 1983 at 10:42 A.M. In Book 4/7 of Washington at page 48 at the request of

[Handwritten signature] County Auditor