

RES 20-180S(9-77)

95306

LAND CORNER RECORD

SKAMANIA

County

T 4 N. R. 9E W.M.
Segregated Surveys:

Corner Code No. X-13

Name: WEST ONE-QUARTER

Corner No.:

D.L.C. HES, Tract, Mining Claim, Indian Allotment, Federal Reserve, Townsite.

1. History of Corner Establishment and Subsequent Restoration:

CORNER WAS ORIGINALLY SET BY EDWIN RICHARDSON IN 1879 UNDER CONTRACT DATED 12/7/1878. WASH. STATE DNR REMON. COR. IN 1970

2. Description of Evidence Found:

FD BRASS CAP IN CONC. & B.T.'S



3. Describe Monument, Accessories and Corollary Data to Perpetuate this Corner Location: Diagram corner and indicate meridian and reference to map of record. Surveyor's Field Book No. 4 Page No. 17 Date of work 12/82

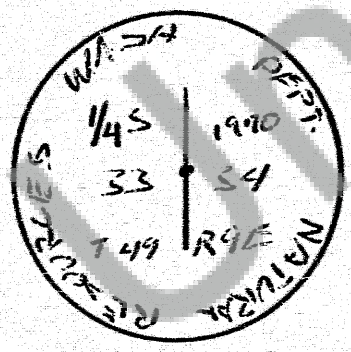
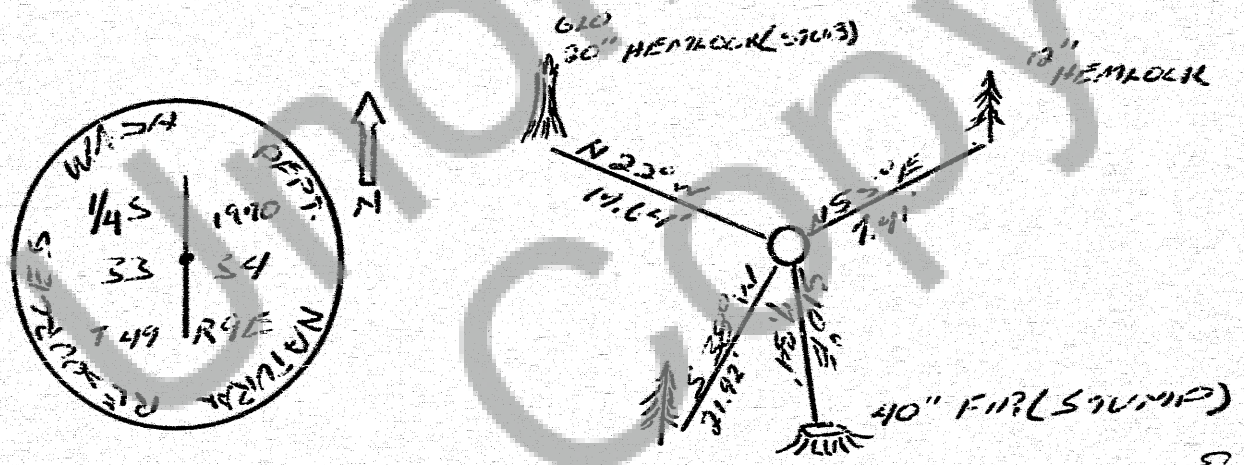

Washington Plane Coordinates: Zone, Y, X
Order Accuracy. Derived From:

Pin Pointed on Photo No. Date Located at

SURVEYOR'S CERTIFICATE

This corner record correctly represents work performed by me or under my direction in compliance with the provisions of Chapter 50, Laws of 1973. Date 1-18-83

Signature [Handwritten Signature]

Certificate No. 18731

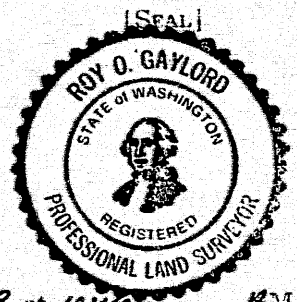

AUDITOR'S CERTIFICATE 95306

Filed for record this 19th day of January 1983 at 10:50 A.M. In Book 4/9 of Monuments at page 46 at the request of Terra Surveying

Signature [Handwritten Signature] County Auditor