

95302

LAND CORNER RECORD

T. 4 N, R. 9E W.M. SIRAMANIA County
 Segregated Surveys: Corner Code No. V-13
 Name: SECTION CORNERS Corner No.:
DLC, HES, Tract, Mining Claim, Indian Allotment, Federal Reserve, Townsite.

1. History of Corner Establishment and Subsequent Restoration:

CORNER WAS ORIGINALLY SET BY EDWIN RICHARDSON IN OCT.-NOV. 1879 UNDER CONTRACT DATED 12/17/1878. IN 1990 WASH DNR. REMOV. CORN.

2. Description of Evidence Found:

FD BRASS CAP IN CONC. WITH B.T.S AS DIAGRAMED BELOW.

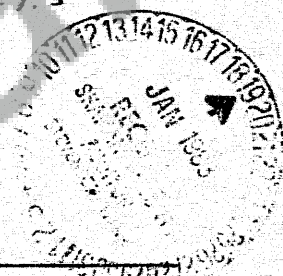

3. Describe Monument, Accessories and Corollary Data to Perpetuate this Corner Location: Diagram corner and indicate meridian and reference to map of record. Surveyor's Field Book No.

9 Page No. 3 Date of work 12/02

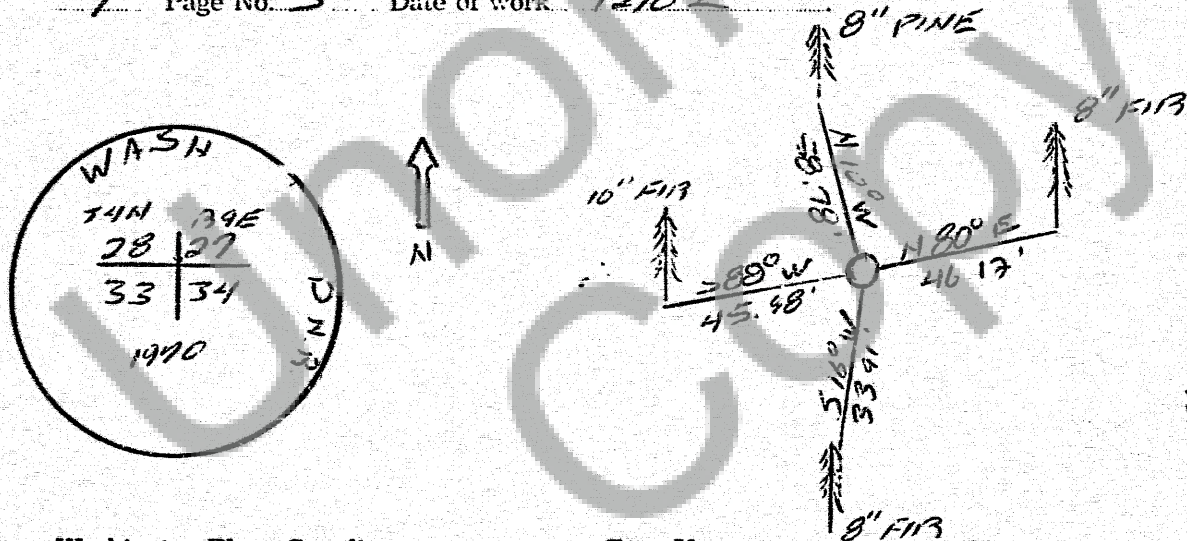

Washington Plane Coordinates: _____ Zone, Y _____
 Order Accuracy. Derived From: _____
 Pin Pointed on Photo No. _____ Date _____ Located at _____

SURVEYOR'S CERTIFICATE

This corner record correctly represents work performed by me or under my direction in compliance with the provisions of Chapter 50, Laws of 1973. Date 1-18-83

Signature Roy S. Gaylord 18731
95302



AUDITOR'S CERTIFICATE

Filed for record this 19 day of Jan 1983 at 10:40 A.M. In Book 419 of Washington at page 42 at the request of _____

Roy S. Gaylord
Harvey W. Gibson County Auditor