

95293

LAND CORNER RECORD

SKAMANIA

County

1 4 N. R. 9 E . W.M.

Corner Code No. W-17

Segregated Surveys:

Name. N 1116

Corner No.:

D.C. HES. Tract Mining Claim, Indian Allotment, Federal Reserve, Townsite.

1. History of Corner Establishment and Subsequent Restoration:

N/A

2. Description of Evidence Found:

N/A

3. Describe Monument, Accessory and Corollary Data to Perpetuate this Corner Location. Diagram corner and indicate meridian and reference to map of record. Surveyor's Field Book No.

10 Page No. 7 Date of work 12/82

SET A 2 1/2" X 30" ALUM PIPE WITH A 2 1/2" ALUM. CAP.

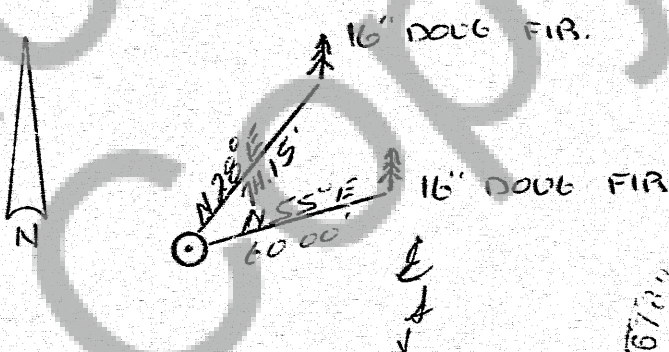

Washington Plane Coordinates: Zone, Y, X
Order Accuracy. Derived From:

Pin Pointed on Photo No. Date Located at

SURVEYOR'S CERTIFICATE

This corner record correctly represents work performed by me or under my direction in compliance with the provisions of Chapter 50, Laws of 1973. Date 1-6-1983

Signature: Ross Gaylord

Certificate No. 18751

95293



AUDITOR'S CERTIFICATE

Filed for record this 19 day of Jan 1983 at 10:40 P.M. In Book 4/4 of Manuscript at page 33 at the request of

Signature: Ross Gaylord

Signature: Gary M. Olson
County Auditor