

LAND CORNER RECORD

SKAMANIA

County

T. 4 N. R. 9 E, W.M.

Corner Code No. 11-19

Segregated Surveys:

Name: C-S 1/16

Corner No.:

DLC, HES, Trust Mining Claim, Indian Allotment, Federal Reserve, Townsite.

1. History of Corner Establishment and Subsequent Restoration:

CORNER WAS SET BY H.F. DONNELLY IN 1953

2. Description of Evidence Found:

FOUND A 1 3/4" WATER PIPE SET BY H.F. DONNELLY IN 1953 WHICH BEARS N 53-21-21 E A DISTANCE OF 12.90'

3. Describe Monument, Accessories and Corollary Data to Perpetuate this Corner Location. Diagram corner and indicate meridian and reference to map of record. Surveyor's Field Book No.

5 Page No. 18 Date of work 12/82

SET A 2 1/2" x 30" ALUM. PIPE WITH A 2 1/2" ALUM. CAP.

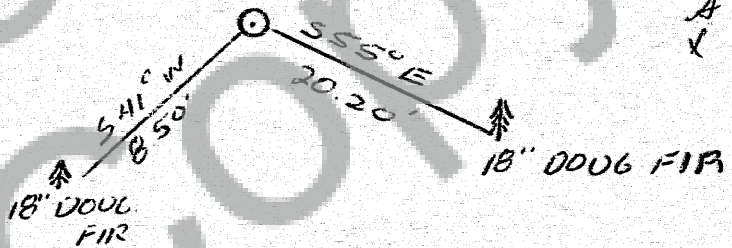
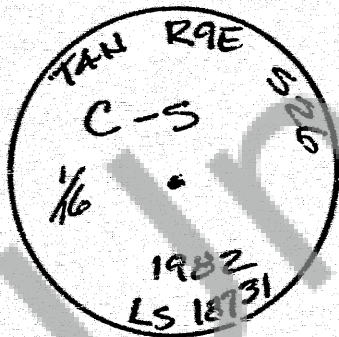

1
2
3
4
5
6
7
8
9
10
11
12
13
14
15
16
17
18
19
20
21
22
23
24
25
26
27
28
29
30
31
32

Washington Plane Coordinates: Zone, Y, X
Order Accuracy: Derived From:

Pin Pointed on Photo No. Date Located at

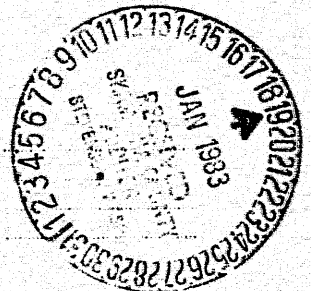

SURVEYOR'S CERTIFICATE

This corner record correctly represents work performed by me or under my direction in compliance with the provisions of Chapter 50, Laws of 1973. Date 1-6-1983

Signature: Roy O. Gaylord

Certificate No. 18731

95286

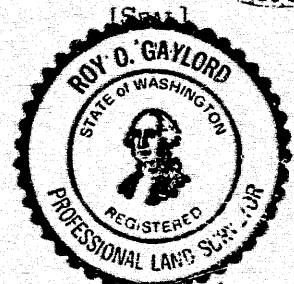

AUDITOR'S CERTIFICATE

Filed for record this 19th day of January 1983 at 10:30 A.M. In Book 4/9 of Monuments at page 26 at the request of Terra Surveying

Signature: Gary M. Olson by B. Babcock
County Auditor