

95284

LAND CORNER RECORD

SKAMANIA

County Corner Code No. U-17

T 4 N, R 9 E, W.M. Segregated Survey:

Name: SOUTH 1116

Corner No.: P.L.C., H.L.S., Trust, Mining Claim, Indian Allotment, Federal Reserve, Township

1. History of Corner Establishment and Subsequent Restoration:

OLSEN ENGINEERING SET CORNER IN 1971

2. Description of Evidence Found:

FOUND ABOVE MENTIONED CORNER (A 9/8" x 30" I.P.A) BEARING N 88° W A DISTANCE OF 1.99 FEET FROM OUR SET POINT.

3. Describe Monument, Accessories and Circumary Data to Perpetuate this Corner Location. Diagram corner and indicate meridian and reference to map, record, Surveyor's Field Book No. 6 Page No. 9 Date of work 12/82

SET A 2 1/2" x 30" ALLUM PIPE WITH A 2 1/2" ALLUM. CAP.

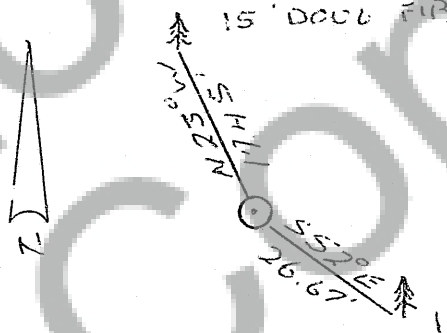
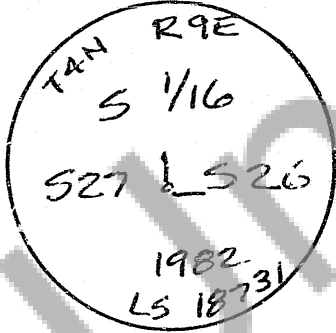

Washington Plane Coordinates: Zone Y... X... Order Accuracy: Derived From: Pr. Pointed on Plane No. Date Located at

SURVEYOR'S CERTIFICATE

This corner record correctly represents work performed by me or under my direction in compliance with the provisions of Chapter 50, Laws of 1973, Date 1-6-1983

Signature: Roy C. Gaylord

Certificate No. 18731

95284



AUDITOR'S CERTIFICATE

Filed for record this 14th day of January, 1983 at 10:40 A. M. In Book 4/9 of Monument at page 274 at the request of Terra Surveying

County Auditor: Gary M. Olson by B. Babcock Dep