

93659

BOOK 3/6 PAGE 8

RES 20-1808(9-77)

STATE OF WASHINGTON
DEPARTMENT OF NATURAL RESOURCES
BUREAU OF SURVEYS AND MAPS

LAND CORNER RECORD

T 3 N. R. 6 East, W.M. Skamania County
Segregated Surveys: Corner Code No. E - 17
Name: N/A Corner No.: N/A
DLC, HES, Tract, Mining Claim, Indian Allotment, Federal Reserve, Townsite.

1. History of Corner Establishment and Subsequent Restoration:
Originally set by 1903 G. L. O. survey.

No restoration found.

2. Description of Evidence Found:
4 Bearing Tree remains pattern:

- 1-18" Fir B.T. stub 3 feet tall at S. 52 W., 38 feet from corner location.
- 1-30" Fir B.T. snag 30 feet tall at S. 12 E., 61 feet from corner location.
- 1-28" Fir B.T. snag 30 feet tall at N. 47 E., 18.5 feet from corner location.
- 1-16" Fir B.T. stub 1 foot tall at N. 68 W., 41 feet from corner location.

3. Describe Monument, Accessories and Corollary Data to Perpetuate this Corner Location. Diagram corner and indicate meridian and reference to map of record. Surveyor's Field Book No. 600.20 Page No. 53 Date of work 30Sept'80

Set 3" cylindrical D. N. R. concrete monument with stamped brass cap 3" above ground on hillside sloping east.

See sketch on back.



Washington Plane Coordinates: South Zone, Y 162,072.31, X 1,606,076.78
3rd Order Accuracy Derived From: USC & GS "Mowich" and USC & GS
"Lookout Mtn. R.M. #1"
Pin Pointed on Photo No. Date Located at

SURVEYOR'S CERTIFICATE

This corner record correctly represents work performed by me or under my direction in compliance with the provisions of Chapter 50, Laws of 1973. Date 1/28/82

Signature

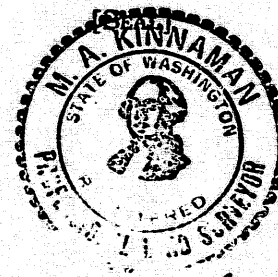
11977
Certificate No.

93659

AUDITOR'S CERTIFICATE

Filed for record this 1 day of Feb 1982 at 12 P.M. In Book 3/6 of 11977 at page 8 at the request of Washington State Department of Natural Resources.

Shirley M. Olson & E. M. Mifflin
County Auditor

Form prescribed by Bureau of Surveys and Maps pursuant to the provisions of Section 5 (2), Chapter 50, Laws of 1973.

ROLL 282.1
DAILY RECORDINGS
BOARD OF COUNTY COMMISSIONERS
MARRIAGE APPLICATIONS

GLO of 1903

80.00 Set post

Fir 28' N47E 28 L.

18.48

Fir 30 S11°45'E 93 L

61.38

Fir 18 S52W 57 L

37.42

Hemlock 16 N67°45'W 62 L

110.92

NE corner Section 10 T3N R6E

Found remains (stumps & snags) of
4 BT's.

corner falls within photo search area

9-30-80

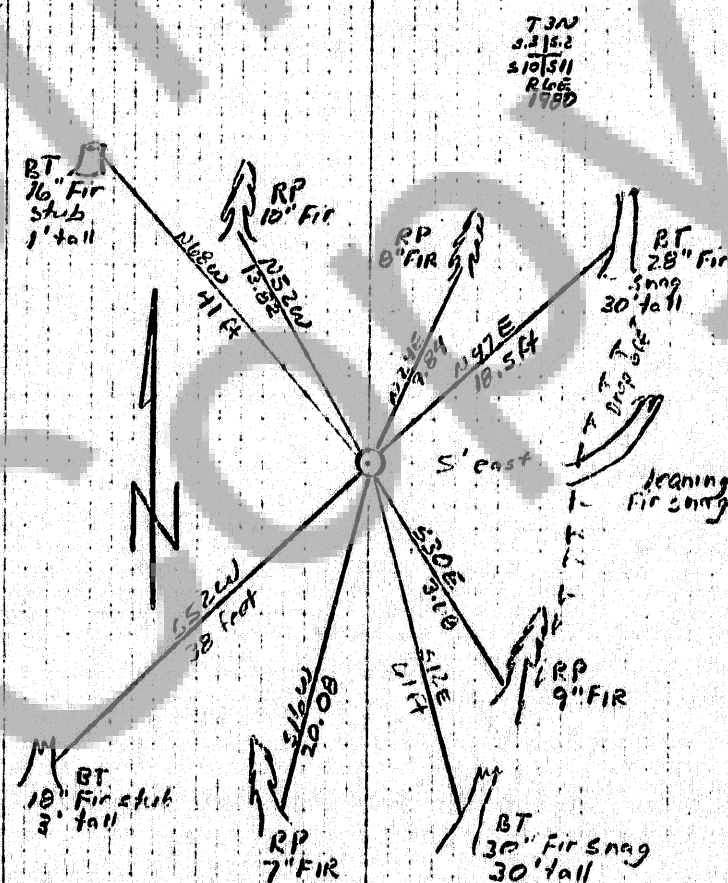
Hemlock
Land
Gordon
Bress for
WilkinS. 3
600.20T3N
S. 3
600.20
R6E
1980