

83432

BOOK 72 PAGE 141
Corrected... be a... and
filed in... original
Dated May 21, 1976
EDGAR SCOTT, Clerk
By *[Signature]* Deputy

UNITED STATES DISTRICT COURT FOR THE
WESTERN DISTRICT OF WASHINGTON

UNITED STATES OF AMERICA,

Plaintiff,

vs.

1.39 ACRES OF LAND, MORE OR LESS,
SITUATE IN SKAMANIA COUNTY, STATE
OF WASHINGTON, AND ZENABEE D. WRIGHT,
ET AL, AND OTHER UNKNOWN OWNERS,

Defendants.

Original Filed

DECLARATION
OF
TAKING

Civil No. *[Handwritten]* T

TO THE HONORABLE
THE UNITED STATES DISTRICT COURT:

I, *Martin R. Hoffmann*, Secretary of the

Army, do hereby declare that:

1. The land hereinafter described is taken under and in
accordance with the authority set forth in Schedule "A" annexed hereto and
made a part hereof.

2. The public uses for which said land is taken are also set
forth in said Schedule "A".

3. A general description of the tract of land being taken,
the estimated just compensation therefor, and the estate taken for said
public uses are set forth in Schedule "B" annexed hereto and made a part
hereof.

4. A plan showing the land taken is annexed hereto as Schedule
"C" and made a part hereof.

5. The gross sum estimated by me as just compensation for all
of said land, which aggregates 1.39 acres, with all buildings and
improvements thereon and all appurtenances thereto and including any and all
interests hereby taken in said land is TEN THOUSAND AND NO/100 DOLLARS
(\$10,000.00) which sum I cause to be deposited herewith in the registry of
the court for the use and benefit of the persons entitled thereto. I am
of the opinion that the ultimate award for said land probably will be
within any limits prescribed by law on the price to be paid therefor.

1 IN WITNESS WHEREOF, the United States of America, by its Secretary
2 of the Army, thereunto authorized, has caused this declaration to be signed
3 in its name by said *Martin R. Hoffmann*, Secretary of
4 the Army, this *20th* day of *August*, A.D., 19 *76*, in the
5 City of Washington, District of Columbia.

6
7
8 */s/ Martin R. Hoffmann*
9 Secretary of the Army
10
11
12
13
14
15
16
17
18
19
20
21
22
23
24
25
26
27
28
29
30
31
32

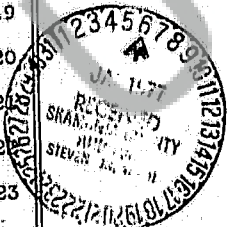

SCHEDULE "A"

AUTHORITY FOR TAKING:

The authority for the taking of the land is under and in accordance with the Act of Congress approved February 26, 1931 (46 Stat. 1421, 40 U.S.C. 258a), and acts supplementary thereto and amendatory thereof, and under the further authority of the Acts of Congress approved April 24, 1888 (25 Stat. 94, 33 U.S.C. 591), and March 1, 1917 (39 Stat. 948, 33 U.S.C. 701), which authorize the acquisition of land for flood control projects; the Act of Congress approved August 30, 1935 (49 Stat. 1028), which act authorizes the construction of the Bonneville Lock and Dam; the Act of Congress approved August 20, 1937 (50 Stat. 731), which act authorized completion, maintenance and operation of the project and the Act of Congress approved December 26, 1975 (Public Law 94-180), which act appropriated funds for such purposes.

PUBLIC USES:

The public uses for which said land is taken are as follows: The said land is necessary to provide for the construction of a river improvement for the purposes of flood control, navigation and for other uses incident thereto. The said land has been selected by me for acquisition by the United States for use in connection with the construction and maintenance of the Second Powerhouse which must be provided at the Bonneville Dam, and for such other uses as may be authorized by Congress or by Executive Order.

SCHEDULE "B"

Tract 2727

A tract of land situated in Section 21, Township 2 North, Range 7 East of the Willamette Meridian, Skamania County, Washington, being more particularly described as follows:

Beginning at a point 450.00 feet North of the North right-of-way line of the Evergreen Highway (State Highway No. 14) and 1,574.00 feet West of the East line of said Section 21; thence North to the Northerly Section line of said Section 21; thence West along said Section line 100.00 feet; thence South to a point 450.00 feet North of the North right-of-way line of said Evergreen Highway (State Highway No. 14); thence Easterly parallel to the North right-of-way of said highway to the point of beginning.

Also, commencing at a point on the North right-of-way line of the Evergreen Highway (State Highway No. 14) which is 1,574.00 feet West of the East line of Section 21; thence North 250.00 feet; thence North 74°51'00" West 88.60 feet to the point of beginning; thence North 74°51'00" West 15.00 feet; thence North 200.00 feet; thence South 74°51'00" West 103.60 feet; thence South 100.00 feet; thence North 74°51'00" West 88.60 feet; thence South 100.00 feet to the point of beginning.

Also including one-half of the adjacent streets and alleys.

The tract of land herein described contains 1.39 acres, more or less.

Estimated compensation deposited in the registry of the court for the above described property: \$10,000.00

Estate Taken: The fee simple title to Tract 2727, subject, however, to existing easements for public roads and highways, public utilities, railroads and pipelines.

Name and address of purported owners: Ralph E. and Rae A. Craig,
Husband and Wife
38510 S.E. Moffett Road
Washougal, Washington 98671

Zenabee D. Wright
Rural Route Skamania
Box 359
Stevenson, Washington 98648

TRACT REGISTER					
TRACT NO.	LAND OWNER	ACRES	SECTION	TOWNSHIP	REMARKS
2700	STATE OF OREGON	0.10	36	12N	FOR HIGHWAY 30
2701	STATE OF OREGON	0.10	36	12N	FOR HIGHWAY 30
2702	STATE OF OREGON	0.10	36	12N	FOR HIGHWAY 30
2703	STATE OF OREGON	0.10	36	12N	FOR HIGHWAY 30
2704	STATE OF OREGON	0.10	36	12N	FOR HIGHWAY 30
2705	STATE OF OREGON	0.10	36	12N	FOR HIGHWAY 30
2706	STATE OF OREGON	0.10	36	12N	FOR HIGHWAY 30
2707	STATE OF OREGON	0.10	36	12N	FOR HIGHWAY 30
2708	STATE OF OREGON	0.10	36	12N	FOR HIGHWAY 30
2709	STATE OF OREGON	0.10	36	12N	FOR HIGHWAY 30
2710	STATE OF OREGON	0.10	36	12N	FOR HIGHWAY 30
2711	STATE OF OREGON	0.10	36	12N	FOR HIGHWAY 30
2712	STATE OF OREGON	0.10	36	12N	FOR HIGHWAY 30
2713	STATE OF OREGON	0.10	36	12N	FOR HIGHWAY 30
2714	STATE OF OREGON	0.10	36	12N	FOR HIGHWAY 30
2715	STATE OF OREGON	0.10	36	12N	FOR HIGHWAY 30
2716	STATE OF OREGON	0.10	36	12N	FOR HIGHWAY 30
2717	STATE OF OREGON	0.10	36	12N	FOR HIGHWAY 30
2718	STATE OF OREGON	0.10	36	12N	FOR HIGHWAY 30
2719	STATE OF OREGON	0.10	36	12N	FOR HIGHWAY 30
2720	STATE OF OREGON	0.10	36	12N	FOR HIGHWAY 30

TRACT REGISTER (Cont)					
TRACT NO.	LAND OWNER	ACRES	SECTION	TOWNSHIP	REMARKS
2721	STATE OF OREGON	0.10	36	12N	FOR HIGHWAY 30
2722	STATE OF OREGON	0.10	36	12N	FOR HIGHWAY 30
2723	STATE OF OREGON	0.10	36	12N	FOR HIGHWAY 30
2724	STATE OF OREGON	0.10	36	12N	FOR HIGHWAY 30
2725	STATE OF OREGON	0.10	36	12N	FOR HIGHWAY 30
2726	STATE OF OREGON	0.10	36	12N	FOR HIGHWAY 30
2727	STATE OF OREGON	0.10	36	12N	FOR HIGHWAY 30
2728	STATE OF OREGON	0.10	36	12N	FOR HIGHWAY 30
2729	STATE OF OREGON	0.10	36	12N	FOR HIGHWAY 30
2730	STATE OF OREGON	0.10	36	12N	FOR HIGHWAY 30
2731	STATE OF OREGON	0.10	36	12N	FOR HIGHWAY 30
2732	STATE OF OREGON	0.10	36	12N	FOR HIGHWAY 30
2733	STATE OF OREGON	0.10	36	12N	FOR HIGHWAY 30
2734	STATE OF OREGON	0.10	36	12N	FOR HIGHWAY 30
2735	STATE OF OREGON	0.10	36	12N	FOR HIGHWAY 30
2736	STATE OF OREGON	0.10	36	12N	FOR HIGHWAY 30
2737	STATE OF OREGON	0.10	36	12N	FOR HIGHWAY 30
2738	STATE OF OREGON	0.10	36	12N	FOR HIGHWAY 30
2739	STATE OF OREGON	0.10	36	12N	FOR HIGHWAY 30
2740	STATE OF OREGON	0.10	36	12N	FOR HIGHWAY 30

TRACT REGISTER (Cont)					
TRACT NO.	LAND OWNER	ACRES	SECTION	TOWNSHIP	REMARKS
2741	STATE OF OREGON	0.10	36	12N	FOR HIGHWAY 30
2742	STATE OF OREGON	0.10	36	12N	FOR HIGHWAY 30
2743	STATE OF OREGON	0.10	36	12N	FOR HIGHWAY 30
2744	STATE OF OREGON	0.10	36	12N	FOR HIGHWAY 30
2745	STATE OF OREGON	0.10	36	12N	FOR HIGHWAY 30
2746	STATE OF OREGON	0.10	36	12N	FOR HIGHWAY 30
2747	STATE OF OREGON	0.10	36	12N	FOR HIGHWAY 30
2748	STATE OF OREGON	0.10	36	12N	FOR HIGHWAY 30
2749	STATE OF OREGON	0.10	36	12N	FOR HIGHWAY 30
2750	STATE OF OREGON	0.10	36	12N	FOR HIGHWAY 30
2751	STATE OF OREGON	0.10	36	12N	FOR HIGHWAY 30
2752	STATE OF OREGON	0.10	36	12N	FOR HIGHWAY 30
2753	STATE OF OREGON	0.10	36	12N	FOR HIGHWAY 30
2754	STATE OF OREGON	0.10	36	12N	FOR HIGHWAY 30
2755	STATE OF OREGON	0.10	36	12N	FOR HIGHWAY 30
2756	STATE OF OREGON	0.10	36	12N	FOR HIGHWAY 30
2757	STATE OF OREGON	0.10	36	12N	FOR HIGHWAY 30
2758	STATE OF OREGON	0.10	36	12N	FOR HIGHWAY 30
2759	STATE OF OREGON	0.10	36	12N	FOR HIGHWAY 30
2760	STATE OF OREGON	0.10	36	12N	FOR HIGHWAY 30

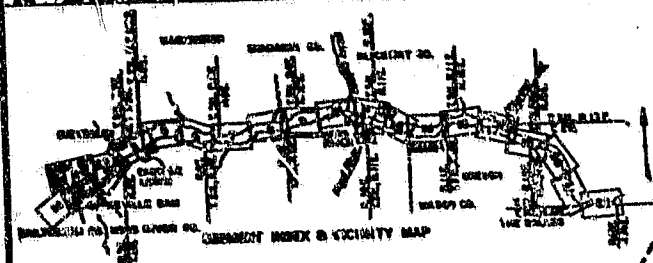

NOTE: The boundary of this project was surveyed from topographical, aerial, and ground surveys, and from the original survey.

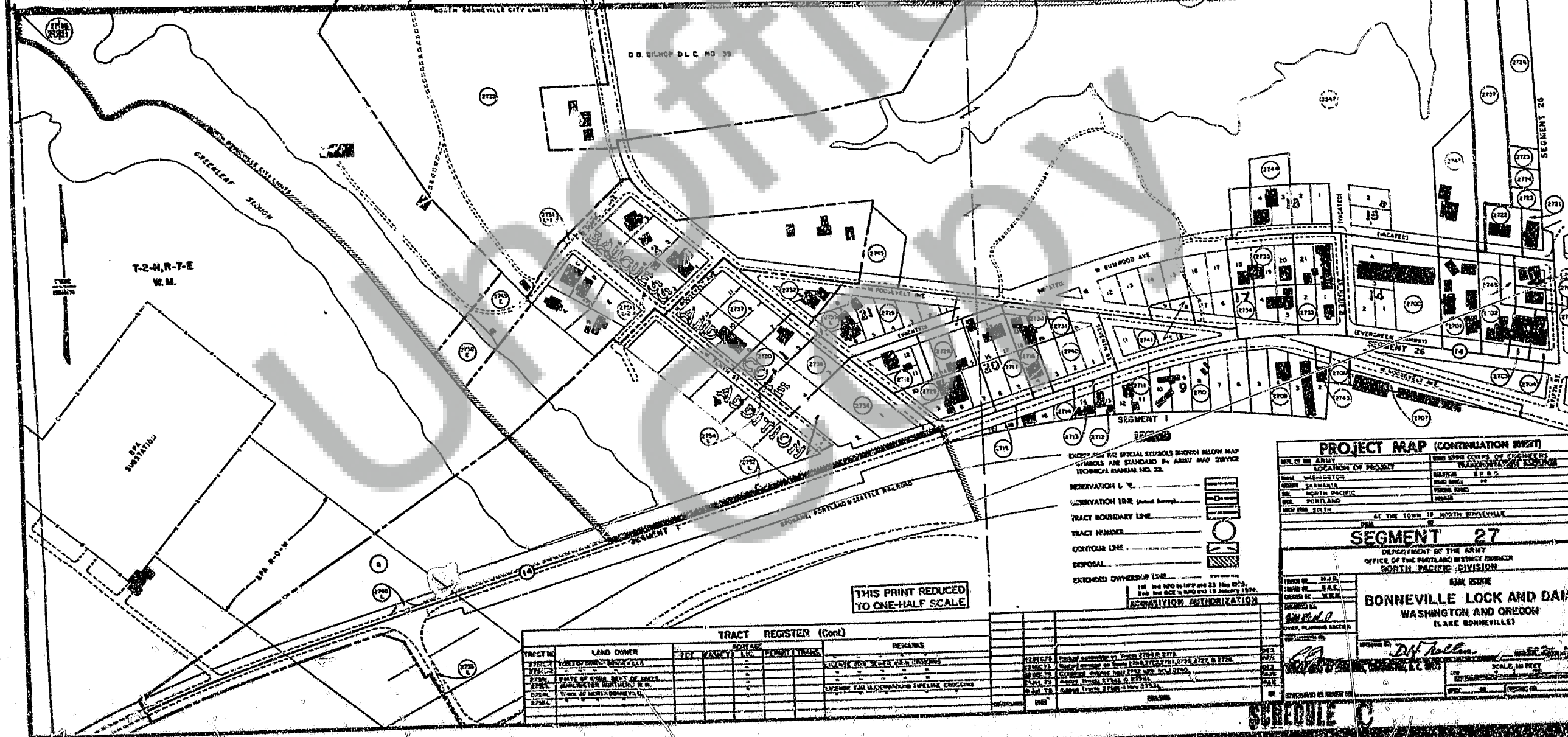

THIS PRINT REDUCED TO ONE-HALF SCALE

TRACT REGISTER (Cont)					
TRACT NO.	LAND OWNER	ACRES	SECTION	TOWNSHIP	REMARKS
2761	STATE OF OREGON	0.10	36	12N	FOR HIGHWAY 30
2762	STATE OF OREGON	0.10	36	12N	FOR HIGHWAY 30
2763	STATE OF OREGON	0.10	36	12N	FOR HIGHWAY 30
2764	STATE OF OREGON	0.10	36	12N	FOR HIGHWAY 30
2765	STATE OF OREGON	0.10	36	12N	FOR HIGHWAY 30
2766	STATE OF OREGON	0.10	36	12N	FOR HIGHWAY 30
2767	STATE OF OREGON	0.10	36	12N	FOR HIGHWAY 30
2768	STATE OF OREGON	0.10	36	12N	FOR HIGHWAY 30
2769	STATE OF OREGON	0.10	36	12N	FOR HIGHWAY 30
2770	STATE OF OREGON	0.10	36	12N	FOR HIGHWAY 30
2771	STATE OF OREGON	0.10	36	12N	FOR HIGHWAY 30
2772	STATE OF OREGON	0.10	36	12N	FOR HIGHWAY 30
2773	STATE OF OREGON	0.10	36	12N	FOR HIGHWAY 30
2774	STATE OF OREGON	0.10	36	12N	FOR HIGHWAY 30
2775	STATE OF OREGON	0.10	36	12N	FOR HIGHWAY 30
2776	STATE OF OREGON	0.10	36	12N	FOR HIGHWAY 30
2777	STATE OF OREGON	0.10	36	12N	FOR HIGHWAY 30
2778	STATE OF OREGON	0.10	36	12N	FOR HIGHWAY 30
2779	STATE OF OREGON	0.10	36	12N	FOR HIGHWAY 30
2780	STATE OF OREGON	0.10	36	12N	FOR HIGHWAY 30

PROJECT MAP (CONTINUATION SHEET)

U.S. ARMY
ENGINEERING DISTRICT
PORTLAND DISTRICT
NORTH PACIFIC DIVISION

SEGMENT 27

BONNEVILLE LOCK AND DAM
WASHINGTON AND OREGON
(LAKE BONNEVILLE)

Scale: 1" = 1000'

Drawn by: [Signature]
Checked by: [Signature]
Approved by: [Signature]

SCHEDULE C