

June 3, 1936

I hereby certify that the
 annexed exhibits are a true
 and correct copy of the original
 on file in my office
 ASST. CLERK, U.S. District Court
 Western District of Washington
 By M. J. [Signature] Dennis Clerk

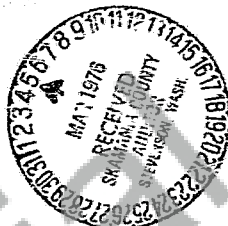

IN THE
 UNITED STATES DISTRICT COURT
 FOR THE WESTERN DISTRICT OF WASHINGTON

UNITED STATES OF AMERICA,
 Plaintiff,

vs.

0.40 ACRES OF LAND, MORE OR LESS,
 SITUATE IN SRAMANIA COUNTY, STATE
 OF WASHINGTON, AND JERRY L.
 RANDALL, ET UX AND UNKNOWN OWNERS,
 Defendants

DECLARATION

OF

CIVIL NO. 073-131

No. 3888

TRANSACTION EXCISE TAX

MAR 5 1936

Amount Paid Amount
Amount
 By R. A. [Signature]
Spring

TO THE HONORABLE,
 THE UNITED STATES DISTRICT COURT:

I, Howard N. [Signature], Secretary of
 the Army, do hereby declare that:

1. (a) The land hereinafter described is taken under and
 in accordance with the Act of Congress approved February 26, 1931
 (45 Stat. 1421, 40 U.S.C. 258a), and acts supplementary thereto and
 amendatory thereof, and under the further authority of the Acts of
 Congress approved April 24, 1888 (25 Stat. 94, 33 U.S.C. 591), and

March 1, 1917 (39 Stat. 943, 33 U.S.C. 701), which authorize the acquisition of land for flood control projects; the Act of Congress approved August 30, 1935 (49 Stat. 1028), which act authorizes the construction of the Bonneville Dam (Oregon and Washington); the Act of Congress, approved August 20, 1937 (50 Stat. 731), which act authorized completion, maintenance and operation of the project and the Act of Congress approved August 23, 1974 (Public Law 93-393), which act appropriated funds for such purposes.

(b) The public uses for which said land is taken are as follows: The said land is necessary to provide for the construction of a river improvement for the purposes of flood control, navigation and for other uses incident thereto. The said land has been selected by me for acquisition by the United States for use in connection with the construction and maintenance of the Second Powerhouse which must be provided at the Bonneville Dam, and for such other uses as may be authorized by Congress or by Executive Order.

2. A general description of the land being taken is set forth in Schedule "A", attached hereto and made a part hereof, and is a description of the same land described in the complaint in the above entitled cause.

3. The estate taken for said public uses is the fee simple title, subject, however, to existing easements for public roads and highways, public utilities, railroads and pipelines.

4. A plan showing the land taken is annexed hereto as Schedule "B" and made a part hereof.

1 5. The sum estimated by me as just compensation for said
 2 land, with all buildings and improvements thereon and all appurtenances
 3 thereto and including any and all interests hereby taken in said land,
 4 is set forth in Schedule "A" herein, which sum I cause to be deposited
 5 herewith in the registry of the said court for the use and benefit of
 6 the persons entitled thereto. I am of the opinion that the ultimate
 7 award for said land probably will be within any limits prescribed by
 8 law on the price to be paid therefor.

9 IN WITNESS WHEREOF, the United States of America, by its
 10 Secretary of the Army, thereunto authorized, has caused this
 11 declaration to be signed in its name by said *Harold H. Canine*
 12 Secretary of the Army, this *8th* day of *April*
 13 A.D. *1975*, in the City of Washington, District of Columbia.

14
 15
 16
 17 *Harold H. Canine*
 18 Secretary of the Army
 19
 20
 21
 22
 23
 24
 25

SCHEDULE "A"

The land which is the subject matter of this Declaration of Taking aggregates 0.40 of an acre, more or less, situate and being in the County of Skamania, State of Washington. Description of the land taken, and a statement of the sum estimated to be just compensation thereof is contained on the following continuation of Schedule "A", comprising two pages, including this page.

Unofficial
Copy

3 April 1974

BOOK 70 PAGE 609

SCHEDULE "A"

Tract 2718

A tract of land situated in Section 21, Township 2 North, Range 7 East of the Willamette Meridian, Skamania County, Washington, being more particularly described as follows:

Commencing at the Northeast corner of said Section 21; thence South 869.08 feet; thence West 2,005.14 feet to a point on the Northerly right-of-way line of the Evergreen Highway (State Highway No. 14); thence Westerly along the said highway right-of-way line 1,025.15 feet; thence North 14°02'00" West at a right angle to said highway right-of-way line 100.00 feet to the point of beginning; thence continuing North 14°02'00" West 100.00 feet; thence South 75°58'00" West parallel with said highway right-of-way 141.80 feet; thence South 48°09'00" East 118.07 feet; thence North 75°58'00" East 79.10 feet to the point of beginning, said tract being designated as Lots 11 and 12 and the West half of Lot 13 of Block 20 of the unrecorded plat of the Town of North Bonneville, Washington.

Also the Southerly 25.00 feet of a former street lying Northerly of and adjacent to the above described tract heretofore vacated by order of the Town Council of the Town of North Bonneville, Washington.

Also including one-half of the adjacent streets and alleys.

The tract of land herein described contains 0.40 of an acre, more or less.

NAME AND ADDRESS OF PURPORTED
OWNER(S) FOR TRACT 2718,
BONNEVILLE LOCK AND DAM
(LAKE BONNEVILLE)

Jerry L. Randall and
Lou Ann Randall, Husband & Wife
115 West Fourth
North Bonneville, WA 98639

ESTIMATED COMPENSATION:

\$21,800.00

The gross sum estimated by the acquiring authority to be just compensation for the estate hereby taken, inclusive of all rights set forth in the Declaration of Taking, is TWENTY-ONE THOUSAND EIGHT HUNDRED and NO/100 DOLLARS (\$21,800.00).

TRACT REGISTER						
TRACTING	LEAD CHARGE	PER	CHARGE	PERCENT	REMARKS	
2740		0.12				
2742		0.10				
2743		0.05				
2750		0.20				
2756	TEST S. B. SANCHEZ, MORTGAGE	0.20				
2758						
2760	STATE OF WASHINGTON, DEPARTMENT OF REVENUE				LICENSE FOR ROAD APPROACH STD.	

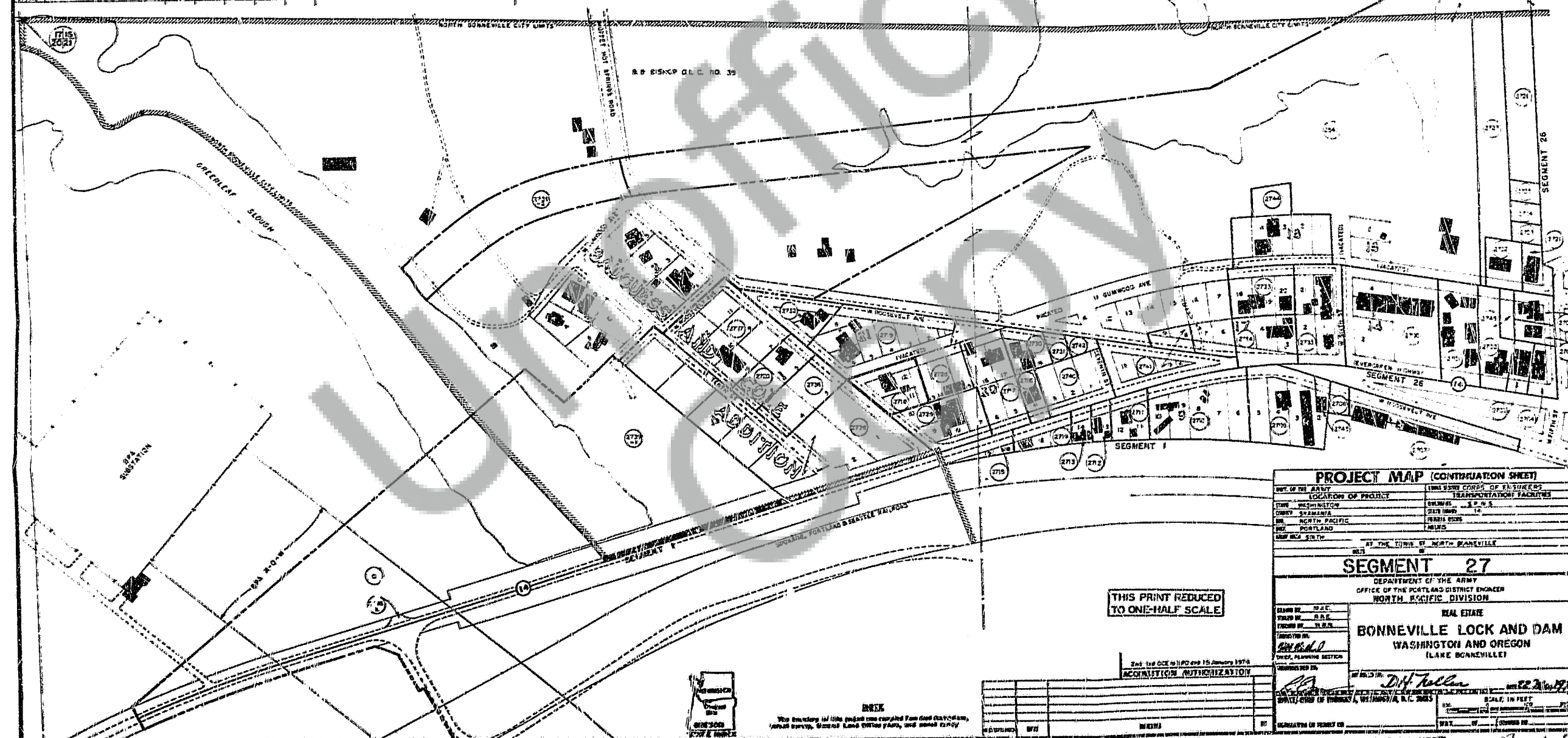
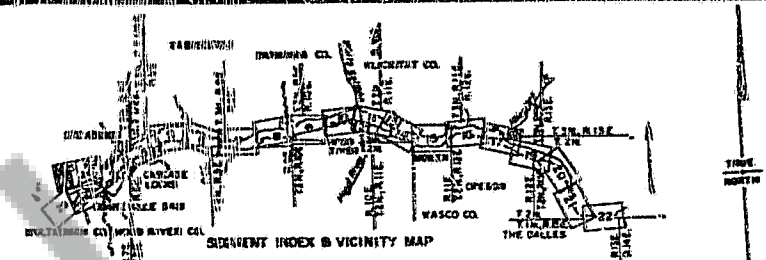

THIS PRINT REDUCED
TO ONE-HALF SCALE

2nd 1st CCE re 11/10/67 15 January 1967
ACCOMPLISHMENT AUTHORIZATION

SCHEDULE "B"

7-432