

Filed June 3, 25

BOOK 69 PAGE 635

80918

C75-103T

I hereby certify that the
annexed instrument is a true
and correct copy of the original
on file in the
Office of the
Clerk of the
Western District of Washington
at
Seattle, Washington
June 3, 1925
Clerk of the Court

IN THE
UNITED STATES DISTRICT COURT
FOR THE WESTERN DISTRICT OF WASHINGTON

UNITED STATES OF AMERICA,
Plaintiff,

DECLARATION
OF
TAKING

vs.

CIVIL NO. 1735

1.02 ACRES OF LAND, MORE OR LESS,
SITUATE IN SKAMANIA COUNTY, STATE
OF WASHINGTON, AND PARKER L.
KNIGHT, ET UX AND UNKNOWN OWNERS,
Defendants

No. 3540
TRANSACTION EXCISE TAX

SEP 17 1925

TO THE HONORABLE,
THE UNITED STATES DISTRICT COURT:

Amount Paid in full
for the
Skamania County Treasurer
By *[Signature]*

I, *Howard H. Cannon*, Secretary of
the Army, do hereby declare that:

1. (a) The land hereinafter described is taken under and
in accordance with the Act of Congress approved February 26, 1931
(46 Stat. 1421, 40 U.S.C. 258a), and acts supplementary thereto and
amendatory thereof, and under the further authority of the Acts of
Congress approved April 24, 1888 (25 Stat. 94, 33 U.S.C. 591), and

3

1 March 1, 1917 (39 Stat. 948, 33 U.S.C. 701), which authorize the
2 acquisition of land for flood control projects; the Act of Congress
3 approved August 30, 1935 (49 Stat. 1028), which act authorizes the
4 construction of the Bonneville Dam (Oregon and Washington); the Act
5 of Congress, approved August 20, 1937 (50 Stat. 731), which act
6 authorized completion, maintenance and operation of the project and
7 the Act of Congress approved August 28, 1974 (Public Law 93-393),
8 which act appropriated funds for such purposes.

9 (b) The public uses for which said land is taken are
10 as follows: The said land is necessary to provide for the construction
11 of a river improvement for the purposes of flood control, navigation
12 and for other uses incident thereto. The said land has been selected
13 by me for acquisition by the United States for use in connection with
14 the construction and maintenance of the Second Powerhouse which must
15 be provided at the Bonneville Dam, and for such other uses as may be
16 authorized by Congress or by Executive Order.

17 2. A general description of the land being taken is set
18 forth in Schedule "A", attached hereto and made a part hereof, and is
19 a description of the same land described in the complaint in the
20 above entitled cause.

21 3. The estate taken for said public uses is the fee simple
22 title, subject, however, to existing easements for public roads and
23 highways, public utilities, railroads and pipelines.

24 4. A plan showing the land taken is annexed hereto as
25 Schedule "B" and made a part hereof.

1 5. The sum estimated by me as just compensation for said
2 land, with all buildings and improvements thereon and all appurtenances
3 thereto and including any and all interests hereby taken in said land,
4 is set forth in Schedule "A" herein, which sum I cause to be deposited
5 herewith in the registry of the said court for the use and benefit of
6 the persons entitled thereto. I am of the opinion that the ultimate
7 award for said land probably will be within any limits prescribed by
8 law on the price to be paid therefor.

9 IN WITNESS WHEREOF, the United States of America, by its
10 Secretary of the Army, thereunto authorized, has caused this
11 declaration to be signed in its name by said *Howard N Callaway*
12 Secretary of the Army, this *7th* day of *April*
13 A.D. *1975*, in the City of Washington, District of Columbia.

14
15
16
17 *Howard N. Callaway*
18 Secretary of the Army
19
20
21
22
23
24
25

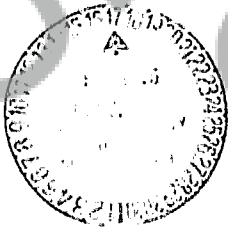

SCHEDULE "A"

The land which is the subject matter of this Declaration of Taking aggregates 1.02 acres, more or less, situate and being in the County of Skamania, State of Washington. Description of the land taken, and a statement of the sum estimated to be just compensation thereof is contained on the following continuation of Schedule "A", comprising three pages, including this page.

17 July 1974

BOOK 69 PAGE 639

SCHEDULE "A"

Tract 2719

A tract of land situated in Section 21, Township 2 North, Range 7 East of the Willamette Meridian, Skamania County, Washington, being more particularly described as follows:

Commencing at the Northeast corner of said Section 21; thence South 678.66 feet; thence West 3,446.76 feet; thence South 48°09'00" East 126.06 feet to the point of beginning; thence continuing South 48°09'00" East 110.06 feet; thence North 73°58'00" East 293.00 feet; thence North 80°35'00" West to a point which is North 41°51'00" East of the point of beginning; thence South 41°51'00" West to the point of beginning.

Excepting that portion of Lot 1 of Block Twenty-One of the unrecorded plat of the Town of North Bonneville, Washington, and that portion of said vacated street conveyed by Parker L. Knight and Marie H. Knight, husband and wife, to Eunice L. Perry, a widow, by deed dated May 13, 1961, and recorded May 17, 1961, at page 470 of Book 48 of Deeds, under Auditor's File No. 58425, Records of Skamania County, Washington.

Said tract being designated as Lots 2, 3, 4, 5, 6 and portions of Lots 1, 7 and 8 of Block Twenty-One of the unrecorded plat of the Town of North Bonneville, Washington.

Also the Northerly 25.00 feet of a former street lying Southerly of and adjacent to the above described tract heretofore vacated by order of the Town Council of the Town of North Bonneville, Washington.

Also including one-half of the adjacent streets and alleys.

SCHEDULE "A"

Tract 2719 (Continued)

The gross sum estimated by the acquiring authority to be just compensation for the estate hereby taken, inclusive of all rights set forth in the Declaration of Taking, is TWENTY SIX THOUSAND and NO/100 DOLLARS (\$26,000.00).

TRACT REGISTER								
TRACT NO.	LAND OWNER	FEE	CAMRY	ACRES	LIC.	PERMIT	TRANS.	REMARKS
2740		0.52						
2741		0.18						
2742		0.07						
2743								
2744	JOHN A. & ELLEN G. HOFFMEIER	0.21						
2745								
2746	STATE OF OREGON, DEPARTMENT OF HIGHWAYS							LICENSE FOR ROAD APPROACH STD.

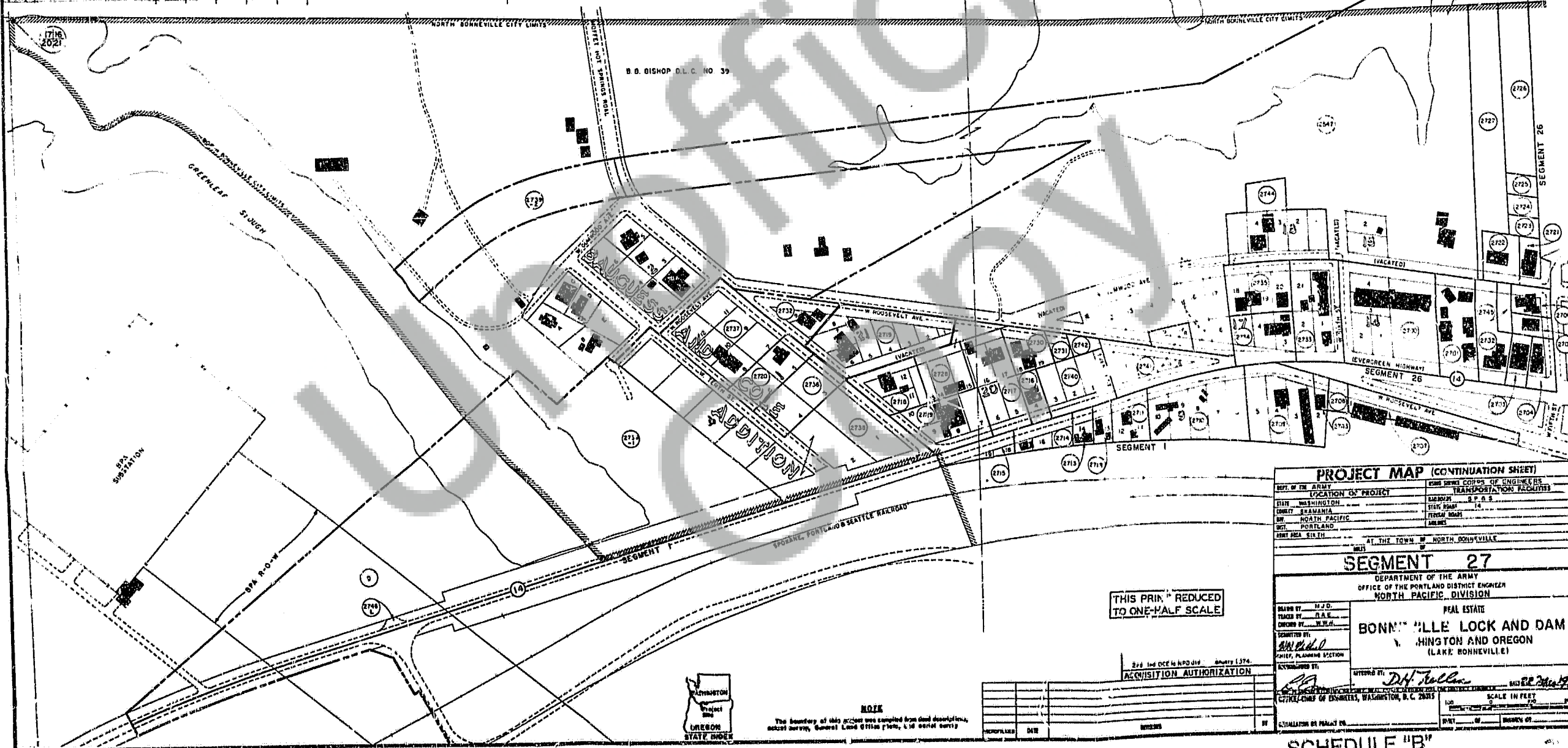
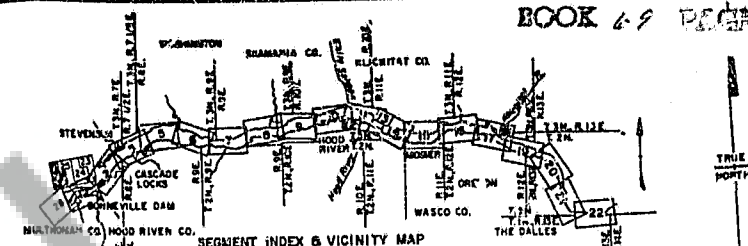

THIS PRINT REDUCED
TO ONE-HALF SCALE

ACQUISITION AUTHORIZATION

<h1>PROJECT MAP (CONTINUATION SHEET)</h1>	
DEPT. OF THE ARMY LOCATION OF PROJECT STATE WASHINGTON COUNTY SPOKANE DIST. NORTH PACIFIC CITY PORTLAND SHEET NO. SIXTH	FROM SERVICE CORPS OF ENGINEERS TRANSPORTATION FACILITIES AIRPORT STATE ROAD FEDERAL ROAD RAILROADS
AT THE TOWN OF NORTH BONNEVILLE DIST.	
<h2>SEGMENT 27</h2>	
DEPARTMENT OF THE ARMY OFFICE OF THE PORTLAND DISTRICT ENGINEER NORTH PACIFIC DIVISION	
DRAWN BY: M.J.D. CHECKED BY: H.A.E. DESIGNED BY: W.H.M.	REAL ESTATE
SUBMITTED BY: <i>Handwritten signature</i> CHIEF, PLANNING SECTION	<h3>BONNEVILLE LOCK AND DAM</h3> WASHINGTON AND OREGON (LAKE BONNEVILLE)
APPROVED BY: <i>Handwritten signature</i>	APPROVED BY: <i>D.H. Hollan</i>
APPROVED BY: <i>Handwritten signature</i>	DATE: 22 Mar 48
U.S. DEPARTMENT OF THE ARMY, WASHINGTON, D.C. 20315 U.S. CORPS OF ENGINEERS, WASHINGTON, D.C. 20315	
SCALE IN FEET 1" = 100'	SCALE IN FEET 1" = 100'
SHEET NO. 27	SHEET NO. 27

SCHEDULE "B"