

I hereby certify that the annexed instrument is a true and correct copy of the original on file in my office.

ATTEST: EUGEN SCORFIELD  
Clerk, U. S. District Court  
Western District of Washington

*[Signature]*  
Deputy Clerk

FILED  
MAY 20 1975

IN THE  
UNITED STATES DISTRICT COURT  
FOR THE WESTERN DISTRICT OF WASHINGTON

UNITED STATES OF AMERICA,  
Plaintiff,

vs.

0.61 ACRE OF LAND, MORE OR LESS,  
SITUATE IN SKAMANIA COUNTY, STATE  
OF WASHINGTON, AND ROBERT E.  
BROCKMAN, ET UX AND UNKNOWN OWNERS  
Defendants

DECLARATION

OF  
TAKING

CIVIL NO. \_\_\_\_\_

TO THE HONORABLE,  
THE UNITED STATES DISTRICT COURT:

I, ALBERT H. GALLAWAY

, Secretary of

the Army, do hereby declare that:

1. (a) The land hereinafter described is taken under and in accordance with the Act of Congress approved February 26, 1931 (46 Stat. 1421, 40 U.S.C. 258a), and acts supplementary thereto and amendatory thereof, and under the further authority of the Acts of Congress approved April 24, 1868 (25 Stat. 94, 33 U.S.C. 591), and

1 March 1, 1917 (39 Stat. 948, 33 U.S.C. 701), which authorize the  
2 acquisition of land for flood control projects; the Act of Congress  
3 approved August 30, 1935 (49 Stat. 1028), which act authorizes the  
4 construction of the Bonneville Dam (Oregon and Washington); the Act  
5 of Congress, approved August 20, 1937 (50 Stat. 731), which act  
6 authorized completion, maintenance and operation of the project and  
7 the Act of Congress approved August 28, 1974 (Public Law 93-393),  
8 which act appropriated funds for such purposes.

9 (b) The public uses for which said land is taken are  
10 as follows: The said land is necessary to provide for the construction  
11 of a river improvement for the purposes of flood control, navigation  
12 and for other uses incident thereto. The said land has been selected  
13 by me for acquisition by the United States for use in connection with  
14 the construction and maintenance of the Second Powerhouse which must  
15 be provided at the Bonneville Dam, and for such other uses as may be  
16 authorized by Congress or by Executive Order.

17 2. A general description of the land being taken is set  
18 forth in Schedule "A", attached hereto and made a part hereof, and is  
19 a description of the same land described in the complaint in the  
20 above entitled cause.

21 3. The estate taken for said public uses is the fee simple  
22 title, subject, however, to existing easements for public roads and  
23 highways, public utilities, railroads and pipelines.

24 4. A plan showing the land taken is annexed hereto as  
25 Schedule "B" and made a part hereof.

1           5. The sum estimated by me as just compensation for said  
2 land, with all buildings and improvements thereon and all appurtenances  
3 thereto and including any and all interests hereby taken in said land,  
4 is set forth in Schedule "A" herein, which sum I cause to be deposited  
5 herewith in the registry of the said court for the use and benefit of  
6 the persons entitled thereto. I am of the opinion that the ultimate  
7 award for said land probably will be within any limits prescribed by  
8 law on the price to be paid therefor.

9           IN WITNESS WHEREOF, the United States of America, by its  
10 Secretary of the Army, thereunto authorized, has caused this  
11 declaration to be signed in its name by said ~~Secretary of the Army~~  
12 Secretary of the Army, this *7th* day of *April*  
13 A.D. 1975, in the City of Washington, District of Columbia.

14  
15  
16  
17 *S. Howard N. Callaway*  
18 Secretary of the Army  
19  
20  
21  
22  
23  
24  
25

## SCHEDULE "A"

The land which is the subject matter of this Declaration of Taking aggregates 0.61 of an acre, more or less, situate and being in the County of Skamania, State of Washington. Description of the land taken, and a statement of the sum estimated to be just compensation thereof is contained on the following continuation of Schedule "A", comprising two pages.

Unofficial  
Copy

## SCHEDULE "A"

## Tract 2717

A tract of land situated in Section 21, Township 2 North, Range 7 East of the Willamette Meridian, Skamania County, Washington, being more particularly described as follows:

Commencing at the Northeast corner of said Section 21; thence South 1,033.11 feet; thence West 3,051.04 feet to a point on the Northerly right-of-way line of the Evergreen Highway (State Highway No. 14); thence Easterly along said highway right-of-way 241.30 feet to the point of beginning; thence North 14°02'00" West at a right angle to said highway 200.00 feet; thence South 75°58'00" West 108.00 feet; thence South 14°02'00" East 100.00 feet; thence North 75°58'00" East 8.00 feet; thence South 14°02'00" East 100.00 feet; thence North 75°58'00" East 100.00 feet to the point of beginning, said tract being designated as Lots 5, 6, 15 and 17 and the Easterly 8.00 feet of Lot 15 of Block 20 of the unrecorded plat of the Town of North Bonneville, Washington.

Also the Southerly 25.00 feet of a former street lying Northerly of and adjacent to the above described tract heretofore vacated by order of the Town Council of the Town of North Bonneville, Washington.

Also including one-half of the adjacent streets and alleys.

The tract of land herein described contains 0.61 of an acre, more or less.

NAME AND ADDRESS OF PURPORTED  
OWNER(S) FOR TRACT 2717,  
BONNEVILLE LOCK AND DAM  
(LAKE BONNEVILLE)

Robert E. Brockman and  
Ann M. Brockman, Husband & W.  
P.O. Box 367  
North Bonneville, WA 98639

ESTIMATED COMPENSATION:

\$29,800.00

The gross sum estimated by the acquiring authority to be just compensation for the estate hereby taken, inclusive of all rights set forth in the Declaration of Taking, is TWENTY-NINE THOUSAND EIGHT HUNDRED and NO/100 DOLLARS (\$29,800.00).

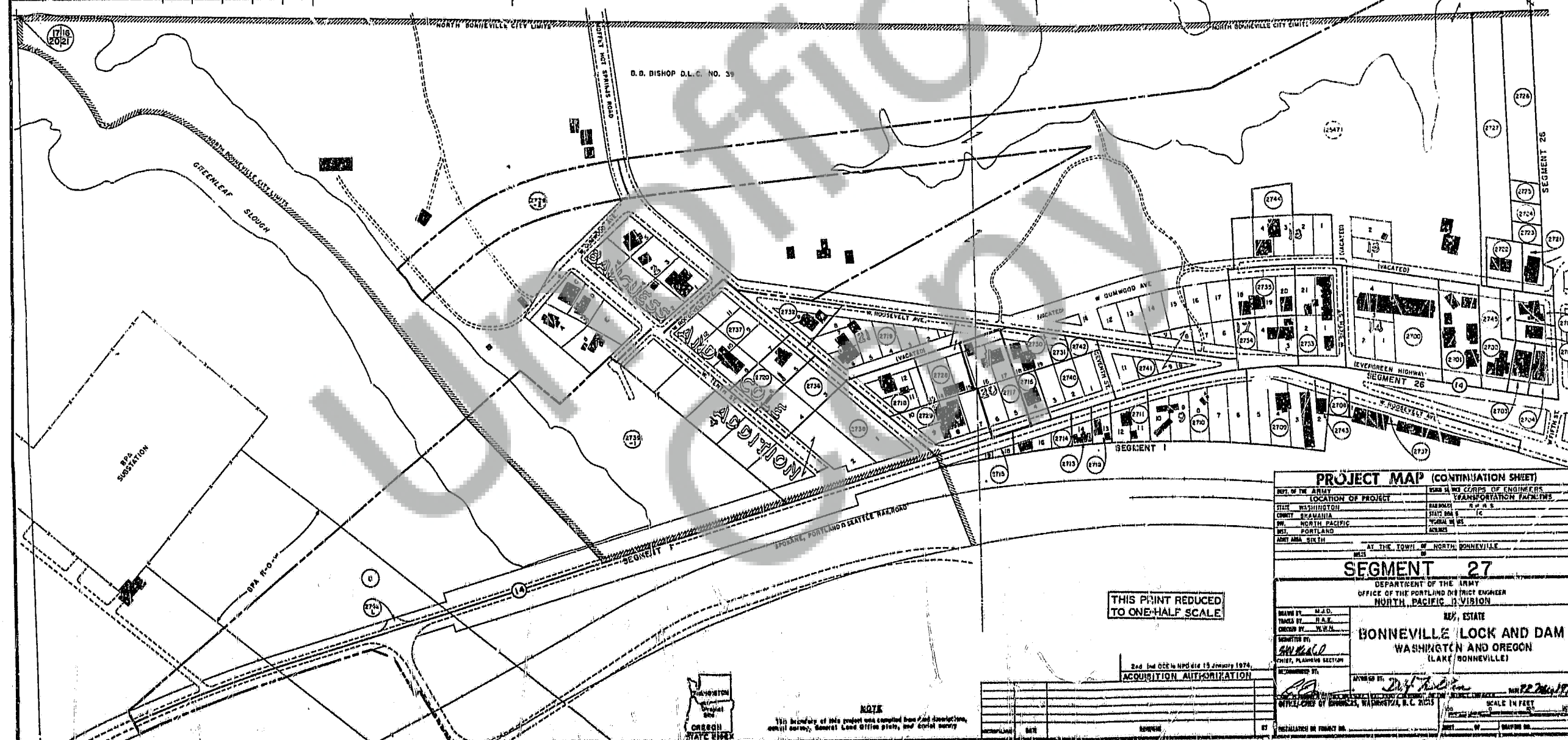
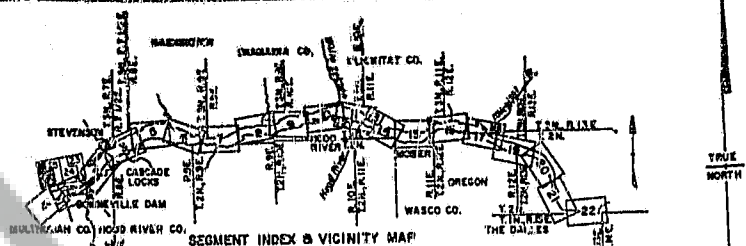

TRACT REGISTER					
TRACT NO.	LAND OWNER	FEE	TAXITY	PERCENTAGE	REMARKS
		LC			
2710		0.57			
2701		0.76			
2702		0.07			
2703					
2704	STATE OF ALABAMA, NAT. PARK	0.71			
2705					
2706	STATE OF MICHIGAN, DEPARTMENT OF HIGHWAYS				LICENSE FOR ROAD APPROX 870.

[illegible]