

Tract No. Ra-0-648
 Ra-0-653
 Ra-0-656
 Ra-0-671

TRANSMISSION LINE EASEMENT

The GRANTON, CARSON LUMBER COMPANY, a Washington corporation, for and in consideration of the sum of TWENTY-FOUR THOUSAND FIVE HUNDRED DOLLARS (\$24,500.00), in hand paid by the UNITED STATES OF AMERICA, receipt of which is hereby acknowledged, hereby grants, bargains, sells and conveys to the UNITED STATES OF AMERICA and its assigns, a perpetual easement and right to enter and erect, maintain, repair, rebuild, operate and patrol one line of electric power transmission structures and appurtenant signal lines, including the right to erect such poles, transmission structures, wires, cables and appurtenances as are necessary thereto, in, over, upon and across the following-described parcels of land in the County of Skamania in the State of Washington, to-wit:

Tract No. Ra-0-648

That portion of a strip of land 12.5 feet in width which lies within the following:

A tract of land in the NE $\frac{1}{4}$, Section 17, Township 3 North, Range 8 East, Willamette Meridian, Skamania County, Washington, more particularly described as follows: Beginning at a point on quarter section line 2497.5 feet East of Southwest corner of the NE $\frac{1}{4}$, Section 17; thence North 379.5 feet; thence West 597.5 feet; thence North 295.5 feet; thence West 464 feet; thence North to Northerly bank of Wind River; thence Southeasterly following Northerly bank of Wind River to intersection with East line of said Section 17; thence Southerly following said East line to Southeast corner of NE $\frac{1}{4}$ of said Section 17; thence West along quarter section line to point of beginning; also that part of said NE $\frac{1}{4}$ that lies north and east of Wind River.

Said strip of land lies on the northerly side of, runs parallel with and adjoins the existing 300-foot right of way of the United States of America for its Bonneville Power Administration's McNary-Ross transmission line, as described in the easement dated October 9, 1953, recorded October 16, 1953, in Book 37, page 219, under Auditor's File No. 46100, and in the easement dated March 23, 1953, recorded March 23, 1953, in Book 36, page 262, under Auditor's File No. 45215, Deed records of Skamania County, Washington.

Tract No. Ra-0-653

That portion of a strip of land 12.5 feet in width which lies within the following:

That portion of the NE $\frac{1}{4}$, Section 17, Township 3 North, Range 8 East, Willamette Meridian, Skamania County, Washington, described as follows: Beginning at the intersection of the center line of Secondary State Highway No. 8-C with East line of the NE $\frac{1}{4}$ of said Section 17; said point being N. 1°19'E. 565.54 feet from center of said section; thence Northwesterly following center line of said highway to intersection with survey line of the McNary-Ross transmission line as described in easement recorded in Book 36 on page 330, Deed records of said County; thence following said survey line Westerly to intersection with West line of NE $\frac{1}{4}$ of said section; thence North to Northwest corner of the NE $\frac{1}{4}$ of said section; thence East 1320 feet more or less to quarter corner on Nor. line of said section; thence South to point of beginning. Except Secondary State Highway No. 8-C.

Said strip of land lies on the northerly side of, runs parallel with and adjoins the existing 300-foot right of way of the United States of America for its Bonneville Power Administration's McNary-Ross transmission line, as described in the easement dated March 23, 1953, recorded April 21, 1953, in Book 36, page 330, under Auditor's File No. 45346, Deed records of Skamania County, Washington.

Tract No. Ha-O-656

That portion of a strip of land 12.5 feet in width which lies within the following:

The NW $\frac{1}{4}$ SE $\frac{1}{4}$ and the NE $\frac{1}{4}$ SW $\frac{1}{4}$ of Section 18, Township 3 North, Range 8 East, Willamette Meridian, Skamania County, Washington.

Said strip of land lies on the northerly side of, runs parallel with and adjoins the existing 300-foot right of way of the United States of America for its Bonneville Power Administration's McNary-Ross transmission line, as described in the easement dated October 9, 1953, recorded on October 16, 1953, in Book 37, page 252, under Auditor's File No. 46101, Dead records of Skamania County, Washington.

Tract No. Ha-O-671

That portion of a strip of land 150 feet in width which lies within the following:

The W $\frac{1}{2}$ W $\frac{1}{2}$ NE $\frac{1}{4}$ of Section 26, Township 3 North, Range 7 East, Willamette Meridian, Skamania County, Washington.

The boundaries of said strip of land lie 75 feet on each side of and parallel with the survey line of the United States of America for its Bonneville Power Administration's Hanford-Ostrander No. 1 transmission line, said survey line is described as follows:

Beginning at survey station 7655+15.0 in the east line of Section 23, said Township and Range, at a point which is N. 1°47'00" E., 726.7 feet from the southeast corner of said Section 23; thence S. 65°01'50" W., 2577.7 feet to survey station 7680+92.7; thence S. 3°45'30" E., 4892.0 feet to survey station 7729+84.7 in the south line of said Section 26 at a point which is S. 89°04'10" E., 710.6 feet from the south quarter corner of said Section 26.

The bearings of said survey line refer to the Washington Coordinate System -- South Zone;

together with the present and future right to clear said right of way and keep the same clear of brush, timber, structures and fire hazards, provided that fire hazards shall not be interpreted to include any growing crops other than trees; and also the present right to top, limb or fell all growing and dead trees and snags (collectively called "danger trees") located on land owned by the Grantor adjacent to the above-described right of way which could fall within 35 feet of any conductor of the electric transmission facilities hereinbefore described; provided, however, it is agreed that compensation is included in the consideration stated above for trees or snags within strips of land outlined in green on Exhibits A, B, C, D, E and F attached hereto and by this reference made a part hereof; also, individual trees described as follows:

<u>Tract No.</u>	<u>Species</u>	<u>DBH</u>	<u>Side of Right of Way</u>	<u>Distance from Survey Line</u>	<u>Survey Station</u>
<u>Ha-O-648</u>					
1	Douglas Fir	22-inch	North	130 feet	Opp. 7423+65
<u>Ha-O-653</u>					
1	Douglas Fir	20-inch	Northwest	110 feet	Opp. 7453+50
<u>Ha-O-656</u>					
1	Douglas Fir	18-inch	Northwest	100 feet	Opp. 7489+70
1	Douglas Fir	16-inch	Northwest	110 feet	Opp. 7489+80

and contiguous to said right of way that are danger trees on August 3, 1970 (hereinafter called "present danger trees"). The right to top, limb or fell danger trees outside of said strips (hereinafter called "additional danger trees") may only be exercised

within 3 years after all present danger trees have been cut, and the UNITED STATES OF AMERICA shall pay the person who is the owner thereof at the date of cutting such additional danger trees the market value prevailing at the date of cutting; under authority of the UNITED STATES OF AMERICA, such payment to be made within a reasonable period of time after they have been so cut.

It is further understood and agreed that the rights acquired by the UNITED STATES OF AMERICA herein shall include all necessary and convenient access over, along and across existing roads on premises owned by the Grantor within existing Bonneville Power Administration easements.

1. It is agreed that any damage to Grantor's agricultural crops, fences, or irrigation or drainage systems on the right of way resulting from and in the course of construction, reconstruction or maintenance of the transmission line or lines shall be repaired, replaced or paid for by the UNITED STATES OF AMERICA or its contractor. Where payment is made, the amount of the damages will be determined by an appraisal made by the UNITED STATES OF AMERICA.
2. The UNITED STATES OF AMERICA shall have the right to grade, cultivate, plant and maintain grass, shrubs, or other cover or ornamental plants upon the portion of the right of way not otherwise being utilized by Grantor.
3. For the purpose of preserving the natural appearance of the right of way, it is agreed by the Grantor and the UNITED STATES OF AMERICA that the right of way shall not be used for the accumulation or dumping of litter, trash or other foreign material. The UNITED STATES OF AMERICA agrees that any such accumulations resulting from its entry upon the right of way for construction or maintenance purposes will be removed or disposed of by the UNITED STATES OF AMERICA or its contractor.

As part of the consideration for this grant, it is agreed that the foregoing provisions numbered 1, 2, and 3 shall hereafter also apply to the previously existing right of way on Grantor's property described in instruments recorded in the Deed records of Skamania County, Washington, as follows:

Easement dated October 9, 1953, recorded in Book 37, page 249, (Tract Mc-R-113)
 Easement dated March 23, 1953, recorded in Book 36, page 262, (Tract Mc-R-114)
 Easement dated March 23, 1953, recorded in Book 36, page 330, (Tract Mc-R-116)
 Easement dated October 9, 1953, recorded in Book 37, page 252, (Tract Mc-R-124)

TO HAVE AND TO HOLD said easement and rights unto the UNITED STATES OF AMERICA and its assigns, forever.

The Grantor covenants to and with the UNITED STATES OF AMERICA and its assigns that the title to all brush, timber or structures existing upon the right of way on August 3, 1970, and the title to all present danger trees shall vest in the UNITED STATES OF AMERICA on said date; and that title to any additional danger trees shall vest in the UNITED STATES OF AMERICA upon their being cut pursuant to the terms hereof; and that the consideration stated herein is accepted by the Grantor as full compensation for all damages incidental to the exercise of said easement and danger tree rights, except payment for any additional danger trees as defined hereinabove which may be cut under authority of the UNITED STATES OF AMERICA as herein provided.

The Grantor also covenants to and with the UNITED STATES OF AMERICA that Grantor is lawfully seized and possessed of the lands aforesaid; has a good and lawful right and power to sell and convey same; that same are free and clear of encumbrances, except as above indicated; and that Grantor will forever warrant and defend the title to said easement and the quiet possession thereof against the lawful claims and demands of all persons whomsoever.

IN WITNESS WHEREOF, CARSON LUMBER COMPANY has caused this instrument to be signed by its proper officers thereunto duly authorized and its corporate seal to be hereunto affixed this 13th day of October, 1970.

CARSON LUMBER COMPANY

By W. Birkenfeld
 President Title

SECRETARY



(Corporate Form)

STATE OF Washington
COUNTY OF Skamania

SS:

On this 13th day of October 1970, before me personally appeared W. Birkenfeld and Rodrigue Salvendy to me known to be the President and Secretary of the corporation that executed the foregoing instrument, and acknowledged said instrument to be the free and voluntary act and deed of said corporation, for the uses and purposes therein mentioned, and on oath, stated authorized to execute said instrument and that the seal affixed is the corporate seal of said corporation.

GIVEN under my hand and official seal the day and year last above written.

Clara J. LinnNotary Public in and for the
State of Washington
Residing at PortlandMy commission expires: 8-19-72

(SEAL)



The within instrument was recorded on the 15 day of Oct, 1970,
at 11:30 P.M., in Vol 62 P. 259
records of Reed

File No. 72728
County, Skamania (State), Wash.

By H.P. Todd
E. Manfred Deputy.

BONNEVILLE POWER ADMINISTRATION
P.O. BOX No. 3621
PORTLAND, OREGON 97203

NOTES: BONNEVILLE POWER ADMINISTRATION, FORM 712, 08-67

BPA 175
Rev. July 1966

9-16-70

-AR-140-1

ANMWN

OPP STA 7410+70

MCNARY-ROSS 345 KV

WIND RIVER (11-13-68)
7411+67 WE
7413+50 WE

7421+98.0 BPA MON

7422+70.8 BPA MON

7422+71 @ PVT RD

7424+04 @ PVT RD

OPP STA 7426+65

OPP STA 7429+50

7430+61 Fc

OPP STA 7430+60

7431+40.0 BPA MON

Ha-0-648

B.P.A. Drawing No. 150440

EXHIBIT A

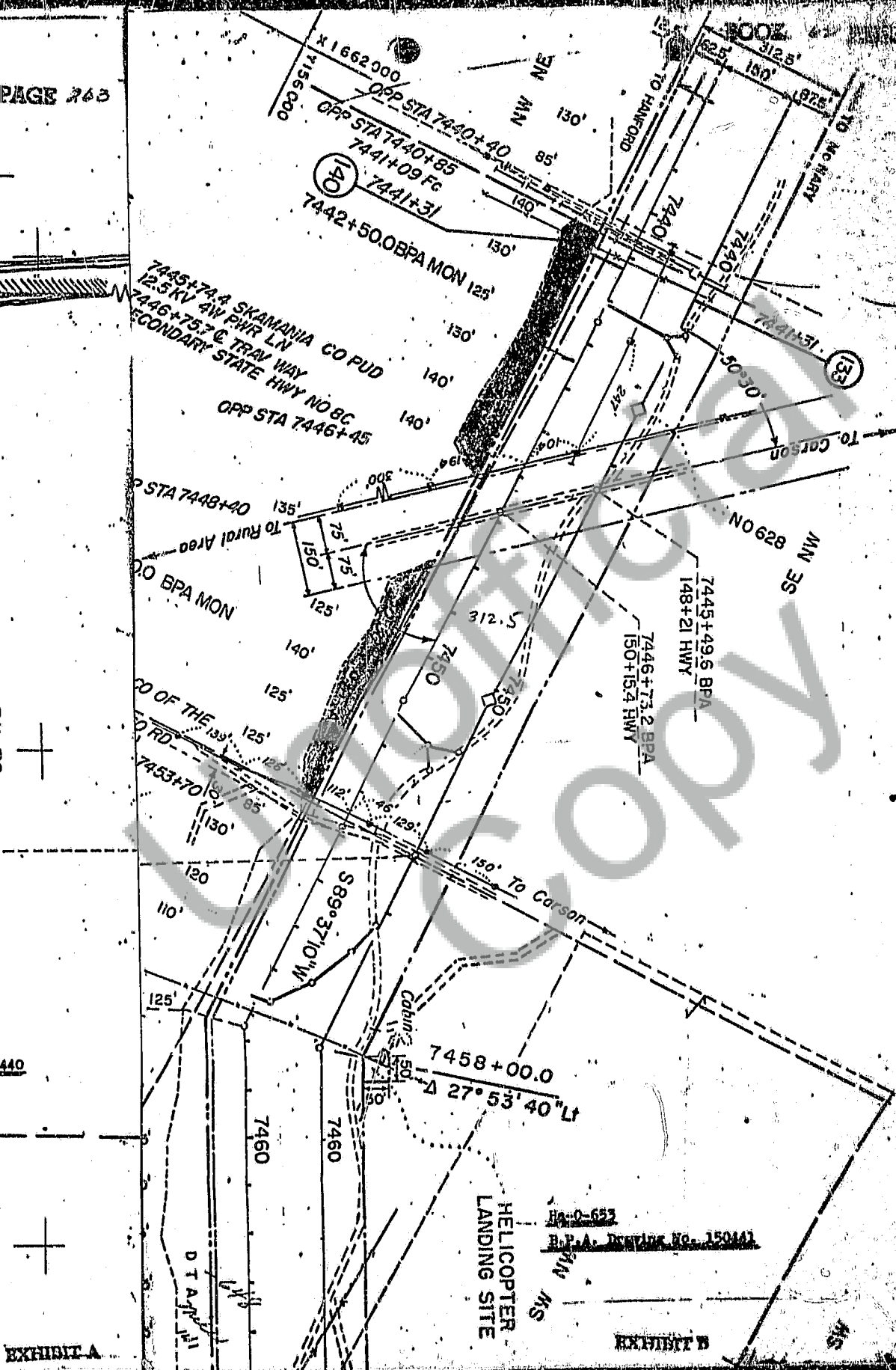

(Corporate Form)

STATE OF Washington
COUNTY OF Skamania

ss:

On this 13th day of October, 1970, before me personally appeared W. Binkfeld and Rudolf E. Salvesen to me known to be the President and Secretary of the corporation that executed the foregoing instrument, and acknowledged said instrument to be the free and voluntary act and deed of said corporation, for the uses and purposes therein mentioned, and on oath stated authorized to execute said instrument and that the seal affixed is the corporate seal of said corporation.

GIVEN under my hand and official seal the day and year last above written.

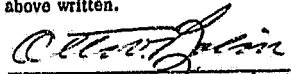

Notary Public in and for the
State of Washington
Residing at Chenoweth

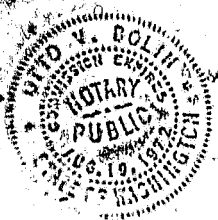
My commission expires: 8-19-72

(SEAL)



The within instrument was recorded on the 15th day of Oct, 1970,
at 11:30 P.M. in Vol 62 P. 259
records of Deed

File No. 72728
County, Skamania (State), Wash.

By H.P. Todd
E. McFarlane
Deputy.



BOONEVILLE POWER ADMINISTRATION
P.O. BOX No. 3621
PORTLAND, OREGON 97208

9-16-70

DIVISION - BOONEVILLE POWER ADMINISTRATION, PORTLAND, OREGON

4

AR-140-1

MNMAN

Shed
B

OPP STA 7410+70

McNARY-ROSS 345 KV

WIND RIVER (11-13-68)
7411+67 WE
7413+50 WE

EN EN

7421+98.0 BPA MON

7422+70.8 BPA MON

7422+71 @ PVT RD

7424+04 @ PVT RD

OPP STA 7426+65

OPP STA 7429+50

7430+61 Fc

OPP STA 7430+60

7431+40.0 BPA MON

Ha-O-648

B.P.A. Drawing No. 150440

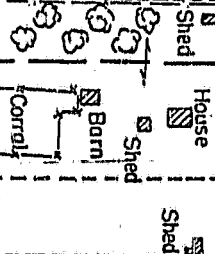
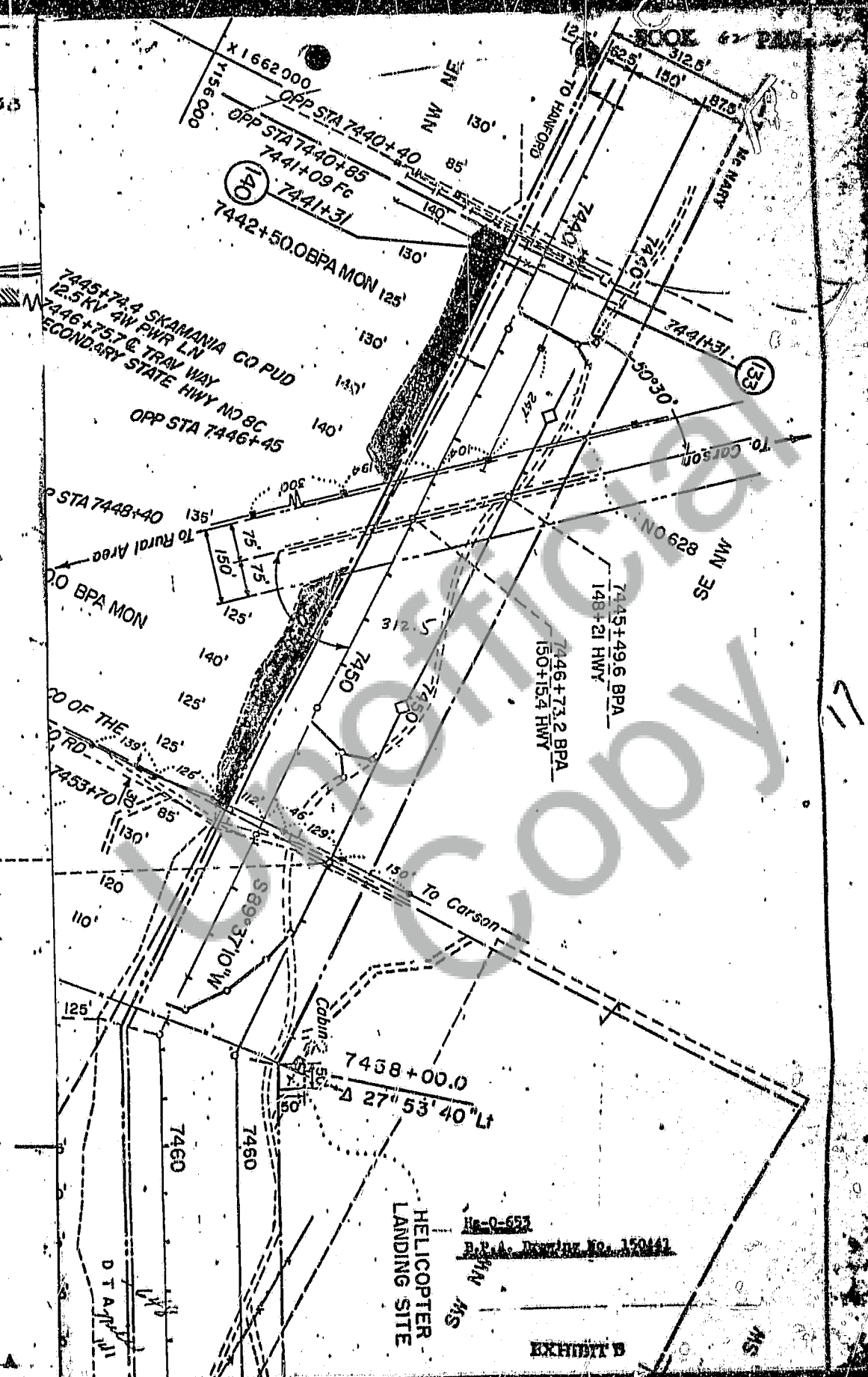

EXHIBIT A



HANFORD-OSTRANDER NO 1 500 KV

MCNAFF-ROSS 345 KV LINE

7479+50.0 BPA MON

OPP STA 7485+00 115'

7489+50.0 BPA MON

7490+04 & PVT RD

7490+96 Cr 115'

7494+11

7494+11

0+00 AR 345'

7490+33.1

MC-R-AR-34
LENGTH 3453

NO 633

Ha-0-656

B.P.A. Drawing No. 150-41 DTM-D

JUL 16 1963

EXHIBIT C

NOTE
BEARINGS AND COORDINATES REFERRED TO
WASHINGTON COORDINATE SYSTEM

HORIZONTAL SCALE 1"=200'
VERTICAL SCALE 1"=20'

81

41

134

TO OSTRANDER

TO ROSS

35 MN

31N

7507
7507

75

751

7

22



R.P.A. Drawing No. 150442

EXHIBIT D

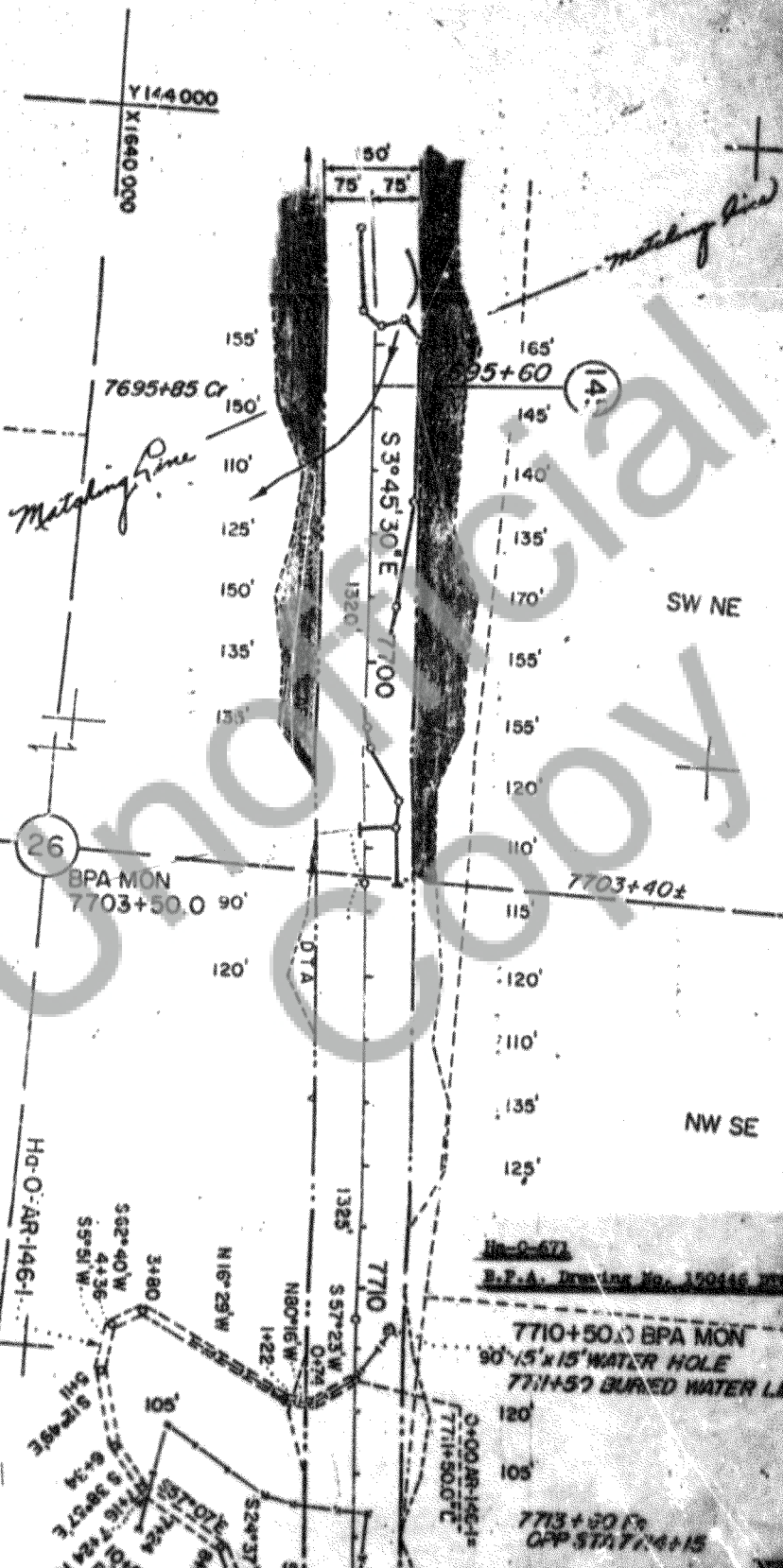

H-0-471
 S.F.A. Drawing No. 150446 H-0-471

7710+50.0 BPA MON
 90' 15" x 15" WATER HOLE
 7711+57 BURED WATER LINE
 7713+50.0
 Q.P. STA 7714+15