

RECEIVED

APR 13 1967

EXHIBIT D

EASEMENT

THIS EASEMENT, dated this 13 day of April, 1967,  
from the United States of America, acting by and through the Forest  
Service, Department of Agriculture, hereinafter called "Grantor," to  
State of Washington Department of Natural Resources, a Department of the  
State of Washington, hereinafter called "Grantee,"

## WITNESSETH:

WHEREAS, Grantee has applied for a grant of an easement under the  
Act of October 13, 1964 (78 Stat. 1089, 16 USC 532-538), for a road over  
certain lands or assignable easements owned by the United States in the  
County of Skamania, State of Washington and administered by the Forest  
Service, Department of Agriculture.

NOW THEREFORE, Grantor, for and in consideration of \$1.00 received  
by Grantor, does hereby grant to Grantee, its successors and assigns, and  
to successors in interest to any lands now owned or hereafter acquired by  
Grantee (hereinafter collectively referred to as "Grantee"), subject to  
existing easements and valid rights, a perpetual easement for a road  
along and across a strip of land, hereinafter defined as the "premises,"  
over and across the lands in the County of Skamania, State of Washington,  
as described on Exhibit A attached hereto.

Certified correct as to consideration  
description and conditions.

*[Signature]*



The word "premises" when used herein means said strip of land whether or not there is an existing road located thereon. Except where it is defined more specifically, the word "road" shall mean roads now existing or hereafter constructed on the premises or any segment of such roads.

The location of said premises is shown on Exhibit A attached hereto.

Said "premises" shall be 30 feet on each side of the centerline with such additional width as required for accommodation and protection of cuts and fills. If the road is located substantially as described herein, the centerline of said road as constructed is hereby deemed accepted by Grantor and Grantee as the true centerline of the premises granted. If any subsequent survey of the road shows that any portion of the road, although located substantially as described, crosses lands of the Grantor not described herein, the easement shall be amended to include the additional lands traversed; if any land described herein is not traversed by the road as constructed, the easement traversing the same shall be terminated in the manner hereinafter provided.

This grant is made subject to the following terms, provisions, and conditions applicable to Grantee, its permittees, contractors, assignees, and successors in interest:

- A. Except as hereinafter limited, Grantee shall have the right to use the road on the premises without cost for all purposes deemed necessary or desirable by Grantee in connection with the protection, administration, management, and utilization of Grantee's lands or

resources, now or hereafter owned or controlled, subject to such traffic-control regulations and rules as Grantor may reasonably impose upon or require of other users of the road without reducing the rights herein granted: Grantee shall have the right to construct, reconstruct, and maintain roads within the premises.

Grantee's right to use the road shall include, but shall not be limited to, use for the purpose of operating and moving specialized logging vehicles and other equipment subject to the following limitations:

Subject to compliance with legal maximum dimensions and weights of motor vehicles imposed by State law on comparable public roads or highways: Provided, That gross weights of equipment or vehicles shall not exceed the capacity of bridges and other structures, and Provided further, That cleared equipment shall not be used on surfaced roads.

- B. Grantee shall comply with all applicable State and Federal laws, Executive Orders, and Federal rules and regulations, except that no present or future administrative rules or regulations shall reduce the rights herein expressly granted.
- C. Grantee shall have the right to cut timber upon the premises to the extent necessary for constructing, reconstructing, and maintaining the road. Timber so cut shall, unless otherwise agreed to, be cut into logs of lengths specified by the timber owner and

decked along the road for disposal by the owner of such timber.

- D. The costs of road maintenance shall be allocated on the basis of respective uses of the road.

During the periods when either party uses the road or Grantor permits use of the road by others for hauling of timber or other materials, the party so using or permitting such use will perform or cause to be performed, or contribute or cause to be contributed that share of maintenance occasioned by such use of the road.

On any road maintained by Grantee, Grantee shall have the right to charge purchasers of National Forest timber and other commercial haulers, or to recover from available deposits held by the Grantor for such purchasers or haulers, reasonable maintenance charges based on the ratio that said hauling bears to the total hauling on such road. Grantor shall prohibit noncommercial use unless provision is made by Grantor or by the noncommercial users to bear proportionate maintenance costs.

- E. Grantee shall have the right to require any user of the road for commercial or heavy hauling purposes to post security guaranteeing performance of such user's obligations with respect to maintenance of the road and with respect to payment of any charges hereinabove stated as payable to Grantee for use of the road: Provided, the amount of such security shall be limited to the amount reasonably necessary to secure such payment as approved by the Regional Forester.

This easement is granted subject to the following reservations by Grantor, for itself, its permittees, contractors, and assignees:

1. The right to use the road for all purposes deemed necessary or desirable by Grantor in connection with the protection, administration, management, and utilization of Grantor's lands or resources, now or hereafter owned or controlled, subject to the limitations herein contained, and subject to such traffic-control regulations and rules as Grantor may reasonably impose upon or require of other users of the road without reducing the rights herein granted to Grantee: Provided, That all use by the public for purposes of access to or from Grantor's lands shall be controlled by Grantor so as not unreasonably to interfere with use of the road by Grantee or to cause the Grantee to bear a share of the cost of maintenance greater than Grantee's use bears to all use of the road.
2. The right alone to extend rights and privileges for use of the premises to other Government Departments and Agencies, States, and local subdivisions thereof, and to other users including members of the public except users of lands or resources owned or controlled by Grantee or its successors: Provided, That such additional use also shall be controlled by Grantor so as not unreasonably to interfere with use of the road by Grantee or to cause the Grantee to bear a share of the cost of maintenance greater than Grantee's use bears to all use of the road.

3. The right to cross and recross the premises and road at any place by any reasonable means and for any purpose in such manner as will not unreasonably interfere with use of the road.
4. The right to all timber now or hereafter growing on the premises, subject to Grantee's right to cut such timber as hereinbefore provided.

The Chief, Forest Service may terminate this easement, or any segment thereof, (1) by consent of the Grantee, (2) by condemnation, or (3) after a five (5) year period of nonuse, by a determination to cancel after notification and opportunity for hearing as prescribed by law; provided the easement, or segment thereof, shall not be terminated for nonuse so long as the road, or segment thereof, is being preserved for prospective future use.

IN WITNESS WHEREOF, the Grantor, by its Regional Forester, Forest Service, has executed this easement (pursuant to the act above-mentioned, the Delegation of Authority and Assignment of Functions by the Secretary of Agriculture dated December 24, 1953, 19 Fed. Reg. 74, the Delegation of Authority by the Chief, Forest Service, dated September 30, 1963, 28 Fed. Reg. 10828, and the Delegation of Authority by the Deputy Chief, Forest Service, dated April 16, 1965, 30 Fed. Reg. 5647, the provisions of which have been complied with), on the day and year first above-written.

UNITED STATES OF AMERICA

By

Douglas R. Leisz  
Acting Regional Forester

Forest Service

Department of Agriculture

Approved as to Forest Chief

4th day of May 1967

[Signature]  
Regional Forester

ACKNOWLEDGMENT

STATE OF OREGON       )  
                                  )  
COUNTY OF MULTNOMAH )

On this day personally appeared the above-named Douglas B. Leisy to me known to be the individual described in and who executed the within and foregoing instrument and acknowledged that he signed the same as his free and voluntary act and deed, for the uses and purposes therein mentioned.

Given under my hand and official seal this 13  
day of April, 1967.

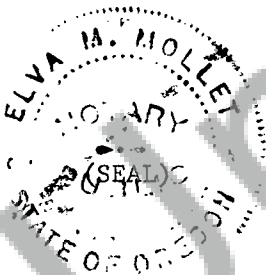

Elva M. Mollet  
Notary Public in and for the  
State of Oregon  
My Commission Expires October 20, 1970

STATE OF WASHINGTON  
DEPARTMENT OF NATURAL RESOURCES  
RIGHT OF WAY PLAT

VN-P-301 ROAD

SEC. 8 T. 7 N. R. 6 E. W.M.

SKAMANIA COUNTY WASH.

SCALE 1 IN. = 400 FT.

U.S.

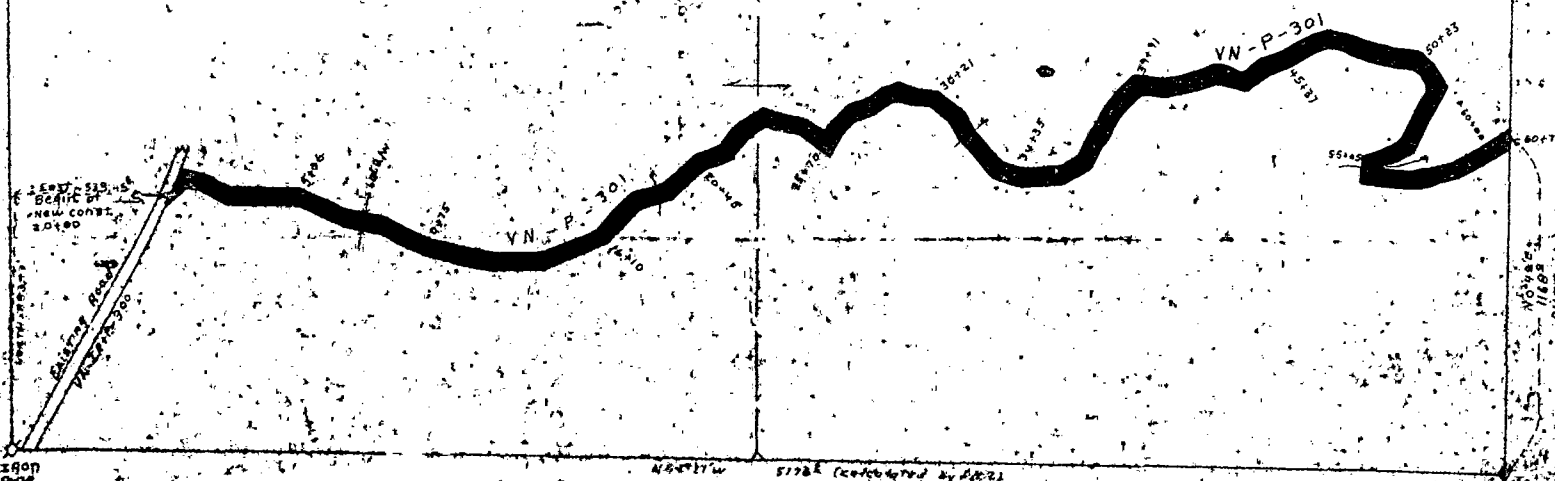

EXHIBIT A

TRAVELLED BY: Dr. J. A. Jensen

DRAWN BY: M. J. A.

DATE: 12/2/60

I, WILLIAM C. GROES, SUPERVISOR OF FOREST ENGINEERING  
HEREBY CERTIFY THAT THIS MAP ACCURATELY REPRESENTS  
LOCATION OF SAID ACCESS ROAD ACROSS SECTION 8 TO  
7 NORTH, RANGE 66 WILLAMETTE MERIDIAN

DECLINATION