

62768

G376244

338172

BOOK

52 PAGE 278

Washington Contract  
T. & M. No. 5593

Easement Deed  
No. 26244-W

N O R T H E R N P A C I F I C R A I L W A Y C O M P A N Y

THIS EASEMENT, made the 9th day of December, A. D. 1963, by the NORTHERN PACIFIC RAILWAY COMPANY, a corporation of the State of Wisconsin, Grantor, to the STATE OF WASHINGTON, Department of Natural Resources, Grantee, WITNESSETH:

*H.L.B.*  
*Good*  
The Grantor, in consideration of the sum of seventy-nine and 71/100 dollars (\$79.71), receipt of which is hereby acknowledged, does hereby grant unto the Grantee, its successors and assigns, an easement and right of way to construct, maintain and use an access road, as authorized in connection with the Washington State Yacolt Rehabilitation Project, over and along a right of way sixty (60) feet in width or wider, as may be necessary to accommodate needed cuts and fills, upon, over and across those parts of the east half of southeast quarter ( $E\frac{1}{2}SE\frac{1}{4}$ ) of Section three (3) in Township three (3) North, Range four (4) East, Clark County, Washington, shown colored red on Exhibit A attached hereto and by this reference made a part hereof, together with the right to construct and maintain fire trails upon, over and across those parts of the east half of southeast quarter ( $E\frac{1}{2}SE\frac{1}{4}$ ) of Section three (3) in Township three (3) North, Range four (4) East, Clark County, Washington, shown colored green on the said Exhibit A;

And also the right to construct and maintain fire trails upon, over and across the following described property: the southeast quarter ( $SE\frac{1}{4}$ ) and northeast quarter of southwest quarter ( $NE\frac{1}{4}SW\frac{1}{4}$ ) of Section thirteen (13) in Township three (3) North, Range three (3) East, Clark County, Washington, shown colored green on Exhibit B attached hereto and by this reference made a part hereof; the south half of northwest quarter ( $S\frac{1}{2}NW\frac{1}{4}$ ) of Section one (1) in Township two (2) North, Range four (4) East, Clark County, Washington, shown colored green on Exhibit C attached hereto and by this reference made a part hereof; the north half of northeast quarter ( $N\frac{1}{2}NE\frac{1}{4}$ ), southwest quarter of northeast quarter ( $SW\frac{1}{4}NE\frac{1}{4}$ ), northwest quarter ( $NW\frac{1}{4}$ ) and north half of south half ( $N\frac{1}{2}S\frac{1}{2}$ ) of Section eleven (11) in Township three (3) North, Range four (4) East, Clark County, Washington, shown colored green on Exhibit D attached hereto and by this reference made a part hereof; Government Lot four (4) of Section twenty-one (21) in Township three (3) North, Range six (6) East, Skamania County, Washington, shown colored green on Exhibit E attached hereto and by this reference made a part hereof; and south half of northwest quarter ( $S\frac{1}{2}NW\frac{1}{4}$ ) and east half of northeast quarter ( $E\frac{1}{2}NE\frac{1}{4}$ ) of Section twenty-three (23) in Township three (3) North, Range six (6) East, Skamania County, Washington, also shown colored green on attached Exhibit E. All of the lands hereinabove described are located East of the Willamette Meridian.

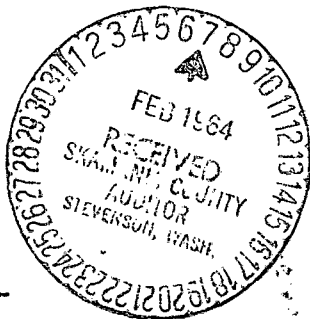

588173

The Grantor reserves unto itself, its successors and assigns, all timber on said right of way, provided that the Grantee shall have the right to cut timber upon the right of way to the extent necessary for the construction or betterment of said road. Such timber shall be cut into logs of standard length, with proper trim allowance, and shall be decked horizontally along said right of way, and shall be free of stumps, limbs or other debris. The method of disposal of such timber so cut shall be mutually determined by the Grantor and the Grantee in advance of actual road construction. The Grantor further reserves the right to grow and harvest future forest crops on that portion of said right of way not actually used for road purposes.

The Grantor also reserves the right to cross and recross the land covered by said right of way and any road thereon at any point for any and all purposes and furthermore reserves the right, subject to all applicable laws and regulations, to use at all times, without cost except for maintenance, all portions of the road now in place or to be constructed on the land embraced by said easement. Provided however, that if at any time hereafter the use of said right of way shall be abandoned by the Grantee, and by the properly constituted authorities in such matters, for all purposes as an access road, then the said easement covered by the said right of way shall revert to the said grantor, its successors, administrators or assigns.

IN WITNESS WHEREOF, the Grantor has caused these presents to be sealed with its corporate seal and signed by its VICE PRESIDENT the day and year first above written.

In Presence Of:

NORTHERN PACIFIC RAILWAY COMPANY

Beatrice L. Nachtrieb

By

[Signature]  
VICE PRESIDENT

Michael J. Rockenbach

Attest:

Richard A. Beulke  
Assistant Secretary

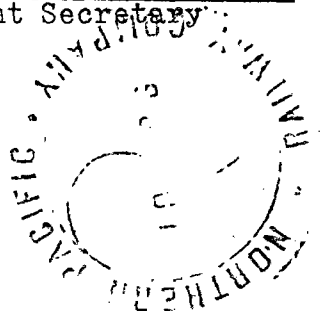

588174

STATE OF MINNESOTA )  
COUNTY OF RAMSEY ) : ss

On this 16<sup>th</sup> day of December, A. D. 1963, before me personally appeared E. B. STANTON, to me known to be the VICE PRESIDENT of the Northern Pacific Railway Company, the corporation which executed the within and foregoing instrument, and acknowledged the said instrument to be the free and voluntary act and deed of said corporation for the uses and purposes therein mentioned, and on oath stated that he was authorized to execute said instrument and that the seal affixed is the corporate seal of said corporation.

IN WITNESS WHEREOF, I have hereunto set my hand and affixed my official seal the day and year last above written.

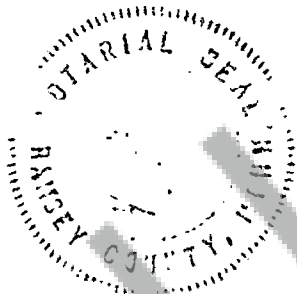

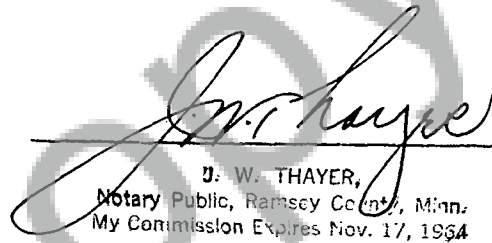
  
J. W. THAYER,  
Notary Public, Ramsey County, Minn.  
My Commission Expires Nov. 17, 1964

DEPARTMENT OF NATURAL RESOURCES  
RIGHT OF WAY PLAT

ACCESS ROADS -L-1210  
L-1214

SEC. 3 T.3 N. R.4 E. W.M.

CLARK COUNTY WASH.

SCALE: 1 IN. = 400 FT.

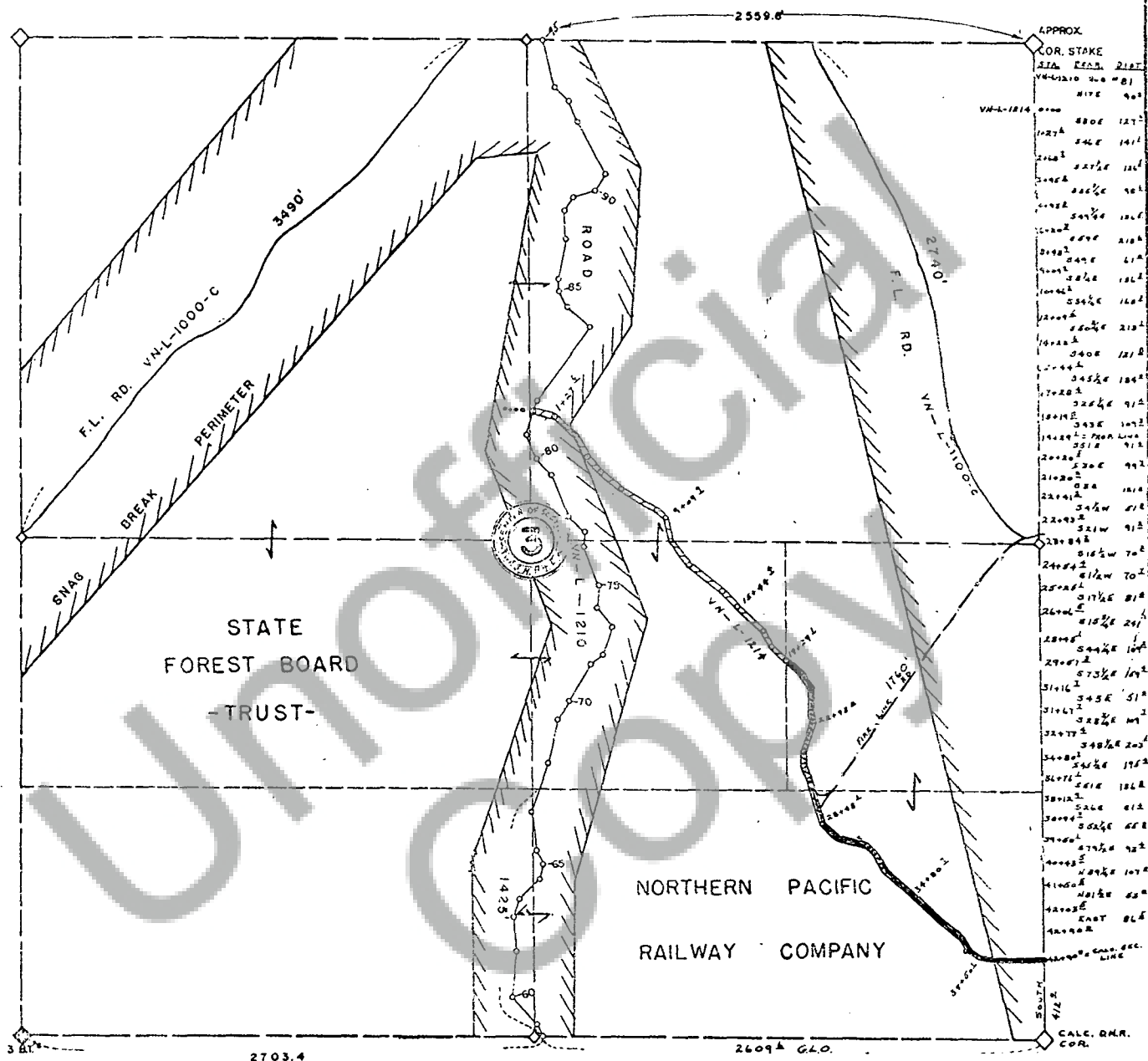

EXHIBIT 'A'

TRAVERSED BY: *E. J. Johnson*  
DRAWN BY: *E. J. Johnson*  
DATE: 11-25-58  
REVISED: 4-27-68  
DECLINATION: 22° 30' E

I, WILLIAM C. GROSS, SUPERVISOR OF FOREST ENGINEERING, DO  
HEREBY CERTIFY THAT THIS MAP ACCURATELY REPRESENTS THE  
LOCATION OF SAID ACCESS ROADS ACROSS SECTION 3, TOWNSHIP  
3 NORTH, RANGE 4 EAST, WILLAMETTE MERIDIAN.

*Wm C Gross*  
SUPERVISOR OF FOREST ENGINEERING

209

588176

BOOK 52 PAGE 282

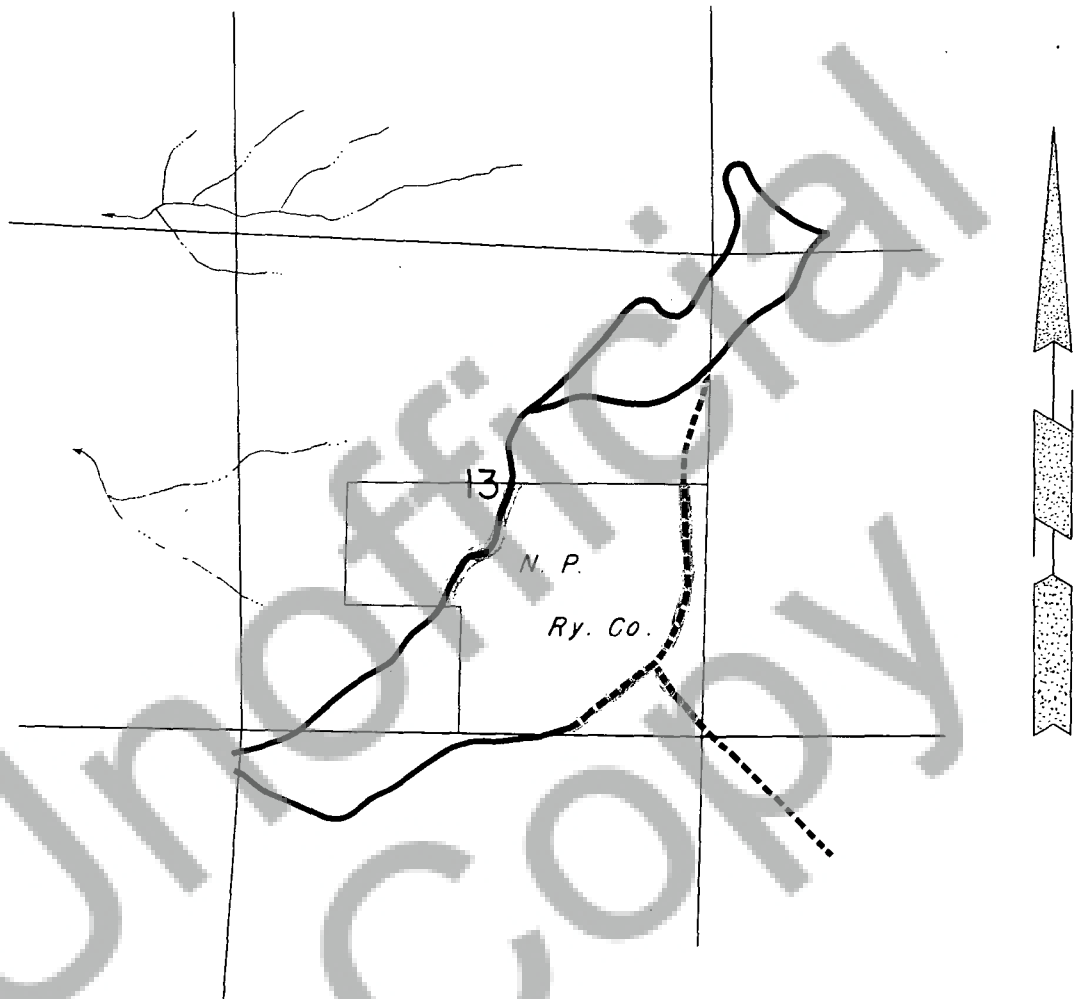

EXHIBIT "B"

Sec. 13, Twp. 3 N., Rge. 3 E.W.M.

CLARK COUNTY, WASHINGTON

LEGEND

Existing Access Road

Existing Road to be  
used as Fireline

Proposed Fireline

588177

BOOK 52 PAGE 283

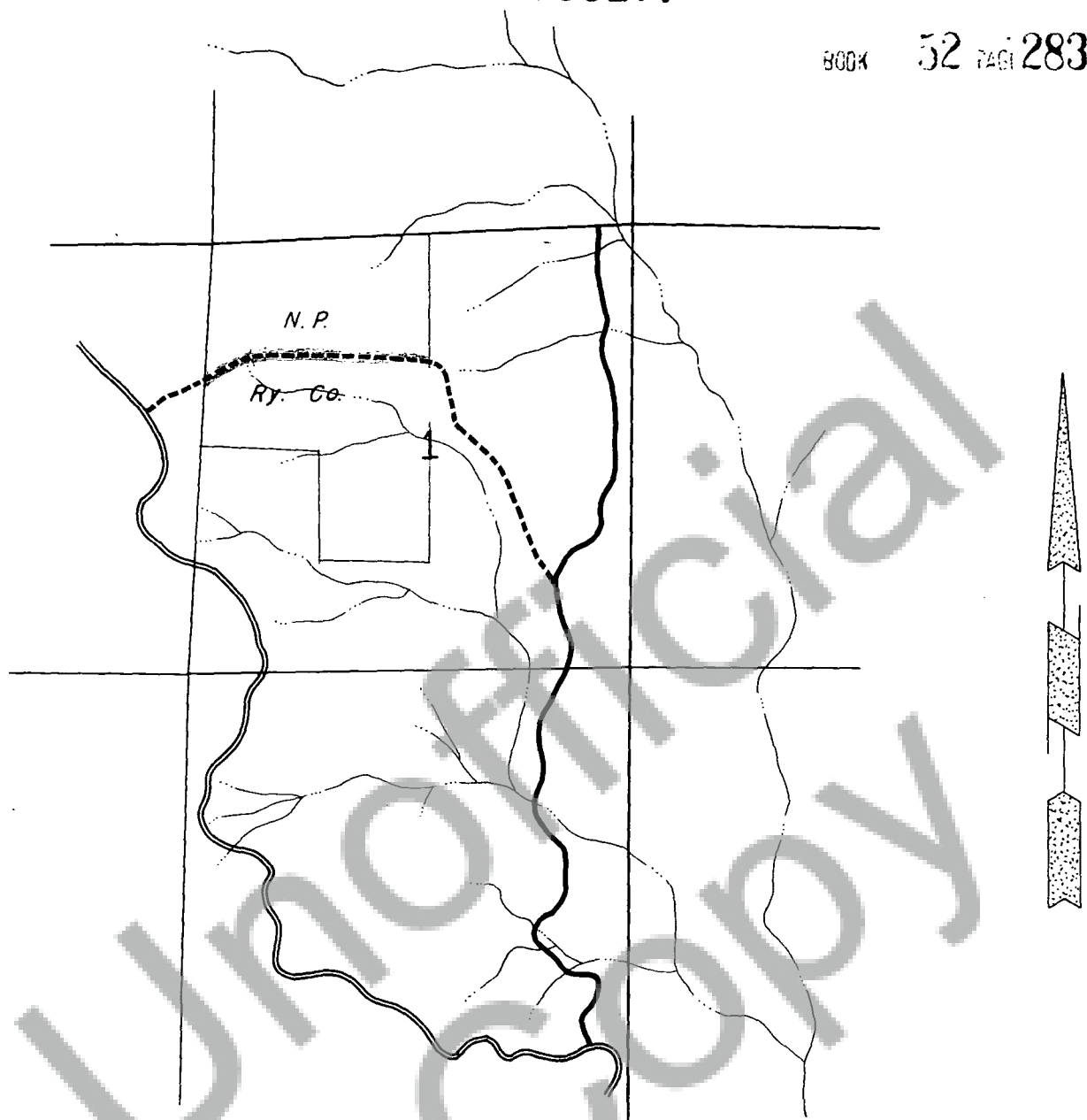

EXHIBIT "C"

Sec. 1, Twp. 2 N., Rge. 4 E.W.M.

CLARK COUNTY, WASHINGTON

LEGEND

- Existing Access Road
- Existing Road to be used as Fireline
- Proposed Fireline

588178

BOOK

52 PAGE 284

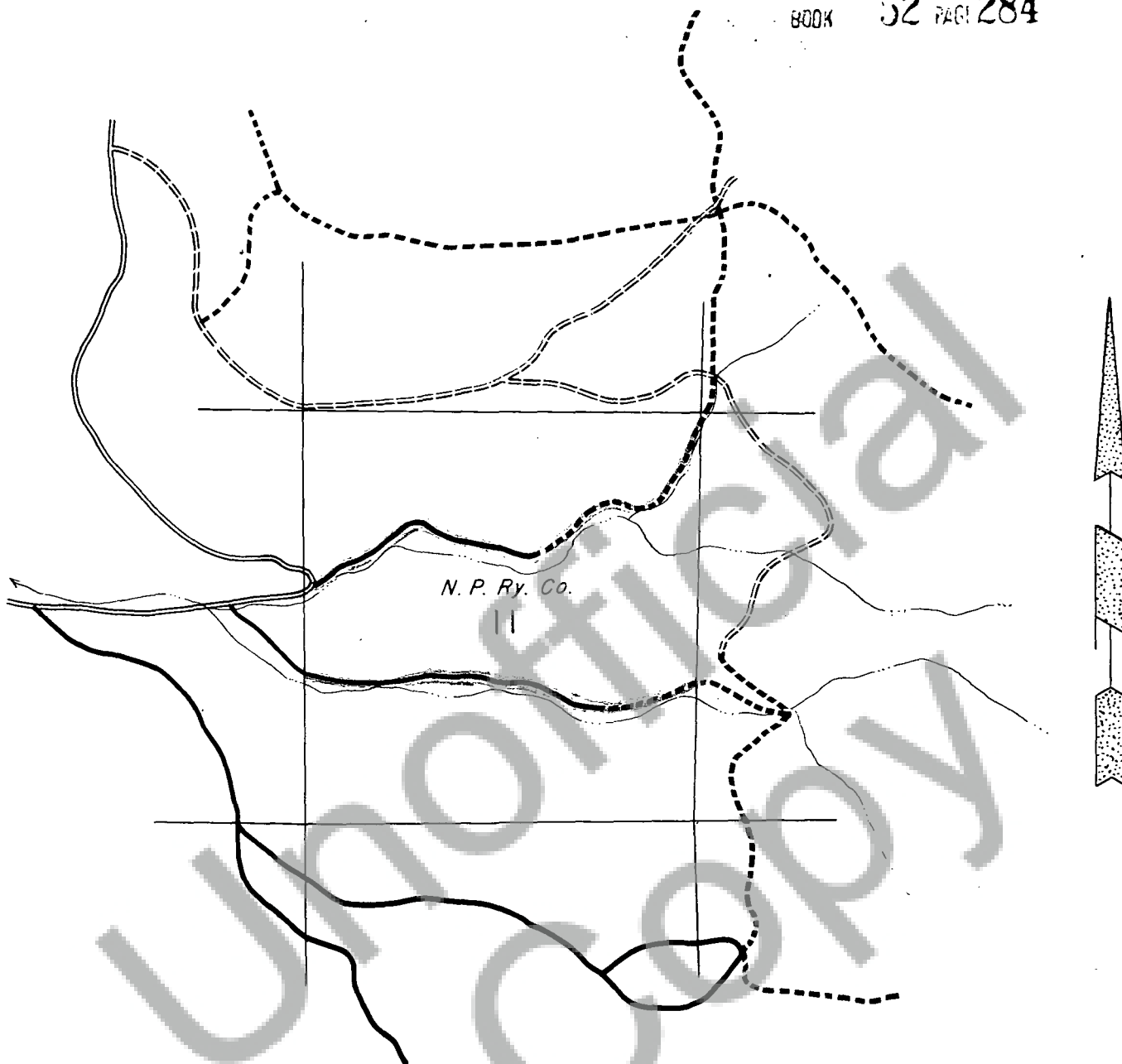

EXHIBIT "D"

Sec. 11, Twp. 3 N., Rge. 4 E.W.M.

CLARK COUNTY, WASHINGTON

LEGEND

- ==== Existing Access Road
- Proposed Access Road
- Existing Road to be used as Fireline
- Proposed Fireline



588179

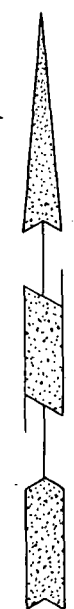

- LEGEND
- ==== Existing Access Road
  - Proposed Access Road
  - Existing Road to be used as Fireline
  - Proposed Fireline

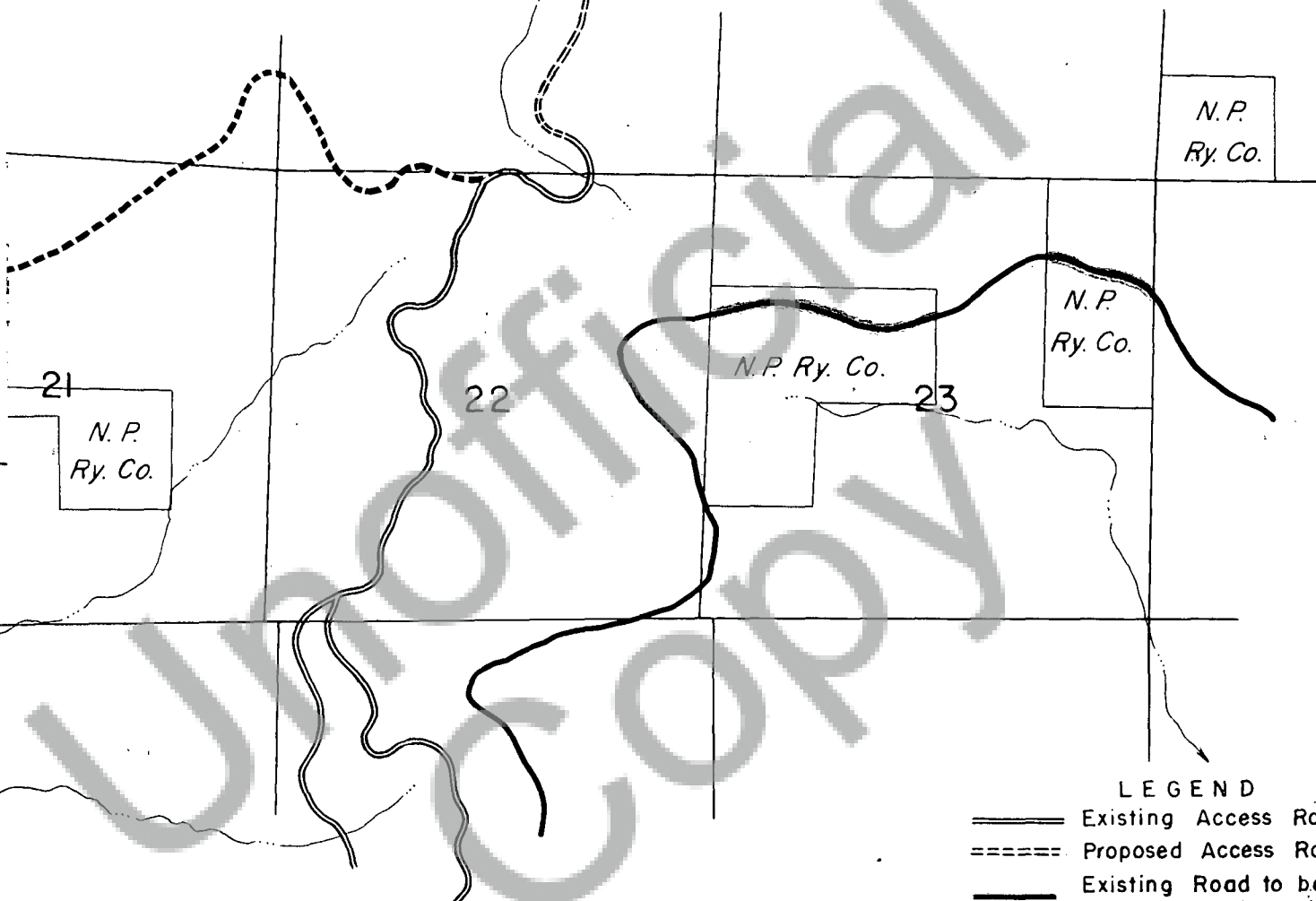

EXHIBIT "E"

Sec. 21 & 23, Twp. 3 N., Rge. 6 E.W.M.

SKAMANIA COUNTY, WASHINGTON

FILED FOR RECORD  
 CLARK D. WASH  
 BY *John J. McArthur*  
 FEE *Free*  
 JAN 30 10 14 AM '64  
 REGISTERED  
 COUNTY CLERK  
 588179  
 AUDITOR  
*Box 110, Olney, Wn*

BOOK 52 PAGE 285