

KNOW ALL MEN BY THESE PRESENTS that in consideration of Two Hundred Dollars (\$200.00) WILLIAM J. WINEBERG and JANET R. WINEBERG, husband and wife, of Vancouver, Washington, (Grantors) hereby grant and convey unto OREGON-WASHINGTON RAILROAD & NAVIGATION COMPANY, an Oregon corporation, and its lessee, UNION PACIFIC RAILROAD COMPANY, a Utah corporation, (Grantees) their successors and assigns, a perpetual easement and right of way for the purpose of transmitting microwave beams upon, along and over a strip of land 100 feet wide as identified by red color on map dated February 3, 1961, marked Exhibit "A" hereto attached and by this reference made part of this instrument and which property is further described as follows:

A parcel of land situate in Section 4, Township 2 North, Range 6 East of the Willamette Meridian, in Skamania County, Washington, described as follows:

Commencing at a point 1527.6 feet north and 1423.4 feet west of the southeast corner of said Section 4;

thence South $69^{\circ} 41'$ West on a straight line a distance of 1297.2 feet, more or less, to a point on the north and south center line of Section 4, being the true point of beginning of a parcel hereby being described;

thence north along said north and south center line of Section 4, a distance of 53.32 feet, more or less;

thence South $69^{\circ} 41'$ West on a straight line a distance of 1218.51 feet, more or less;

thence South $20^{\circ} 19'$ East on a straight line a distance of 100 feet;

thence North $69^{\circ} 41'$ East on a straight line to a point on said north and south center line of Section 4, a distance of 1181.49 feet, more or less;

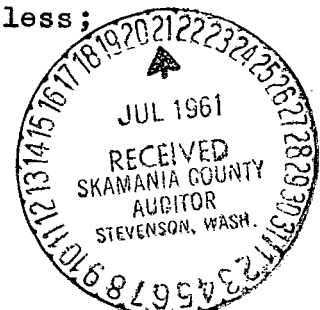

thence north on aforesaid north and south center line of Section 4, a distance of 53.32 feet, more or less, to point of beginning.

Together with the right in perpetuity of ingress to and egress from said easement area to keep said microwave beam path clear of all trees, timber and man-made structures which by their location or height do or may interfere with the transmission of microwave beams along said beam path.

The Grantees shall remove any such trees, timber or other man-made structures from said easement area at the Grantees' own expense and without expense whatsoever to the Grantors, and shall remove said trees, timber or man-made structures in a safe and proper manner so as not to create hazard of injury to persons or damage to property.

The Grantors hereby reserve the right to use the property hereinbefore described for any and all purposes not inconsistent with the easement granted.

TO HAVE AND TO HOLD unto the Grantees, their successors and assigns forever, the above described and conveyed easement, right of way and rights.

If and when and to the extent that the Grantees, their successors and assigns, shall permanently abandon and cease to use the aforesaid easement, the easement hereby granted shall cease and terminate.

IN WITNESS WHEREOF, the Grantors have executed this
instrument as of the 26th day of May 1961.

William P. Rosenberg
Janet R. Rosenberg



5000 49 81

CROWN ZELLERBACH CORP.

W. W. WILKINS

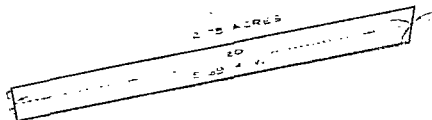

3.21 ACRES

1297.2'

PROPOSED 10
MICROWAVE SITE

0.6 ACRES

425' ± E. 1/2 S. 1/2
52' ± N. 1/2 S. 1/2
FROM S. E. COR. SEC. 14

CROWN ZELLERBACH CORP.

1072.2'

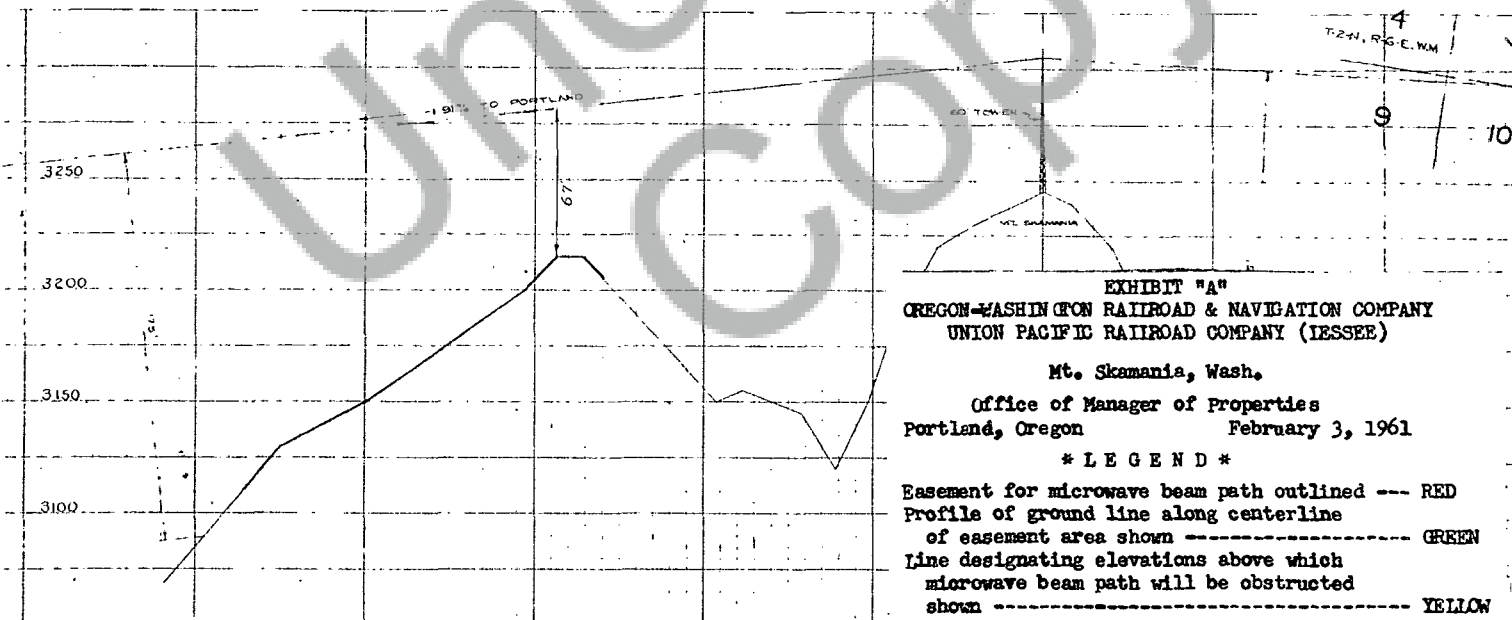

EXHIBIT "A"
OREGON-WASHINGTON RAILROAD & NAVIGATION COMPANY
UNION PACIFIC RAILROAD COMPANY (LESSEE)

Mt. Skamania, Wash.

Office of Manager of Properties
Portland, Oregon **February 3, 1961**

*** LEGEND ***

Easement for microwave beam path outlined --- RED
 Profile of ground line along centerline
 of easement area shown ----- GREEN
 Line designating elevations above which
 microwave beam path will be obstructed
 shown ----- YELLOW

STATE OF WASHINGTON)
) ss:
 County of Clark)

On this day personally appeared before me William J. Wineberg and Janet R. Wineberg, husband and wife, to me known to be the individuals described in and who executed the within and foregoing instrument, and acknowledged that they signed the same as their free and voluntary act and deed, for the purposes and uses therein mentioned.

Given under my hand and official seal this 16th
 day of May, 1961.

James H. Hickey
 Notary Public in and for the said
 County and State, residing
 at Vancouver.

My commission expires 12-12-61

2442

No.

TRANSACTION EXCISE TAX

JUL 20 1961

Amount Paid \$2.00

Michael J. O'Connell
 Skemaania County Treasurer

By