

57865

Quit Claim Deed

The GRANTOR, SEATTLE-FIRST NATIONAL BANK, a National Banking Association,

for and in consideration of Ten 00/100

Dollars, conveys and quit-claims to THE WASHINGTON CORPORATION

all interest in the following described real estate:

The Northwest Quarter ($NW\frac{1}{4}$); the West Half of the Northeast Quarter ($W\frac{1}{2}$ of $NE\frac{1}{4}$) and Government Lots 1, 2 and 3, all in Section 6, Township 1 North, Range 6 E.W.M.

EXCEPT that portion thereof lying easterly of the line described in those certain deeds dated June 25, 1883, and recorded at pages 266 and 364 of Book C of Deeds, Records of Skamania County, Washington, which said line is described as follows: Beginning at a point on the north line of said Section 6 west 20 rods and 17 links from the quarter post of the north line of the said Section 6; thence in a southeasterly direction keeping the center of the canyon to its mouth and continuing on the same course to the Cascade Road; thence following the Cascade Road 19 rods and 15 links west; thence in a direct line to the Columbia River taking a hollow ash stump in the line;

AND EXCEPT the following described tract in Government Lots 2 and 3 of said section 6; All that portion of the following described tract lying south of the center of State Highway No. 8: Beginning at a point 1,320 feet east and 914 feet south of the quarter corner on the west line of said Section 6; thence north $54^{\circ}35'$ east 120.3 feet; thence north $71^{\circ}09'$ east 161.7 feet; thence north $52^{\circ}48'$ east 863.6 feet; thence east 155.6 feet, thence north $62^{\circ}05'$ east 227.8 feet; thence south $24^{\circ}45'$ east 228.3 feet; thence south $13^{\circ}40'$ east 435 feet to the meander line of the Columbia River; thence westerly along said meander line to a point south of the point of beginning; thence north 498 feet to the point of beginning;

AND EXCEPT right of way for State Highway No. 8 and the right of way of the Spokane, Portland & Seattle Railway Company.

The south 820 feet of the Northeast Quarter of the Northeast Quarter ($NE\frac{1}{4}$ of $NE\frac{1}{4}$); the Southeast Quarter of the Northwest Quarter ($SE\frac{1}{4}$ of $NW\frac{1}{4}$); the North Half of the Northeast Quarter of the Southeast Quarter ($N\frac{1}{2}$ of $NE\frac{1}{4}$ of $SE\frac{1}{4}$); the Southeast Quarter of the Southeast Quarter ($SE\frac{1}{4}$ of $SE\frac{1}{4}$); the West Half of the Southeast Quarter ($W\frac{1}{2}$ of $SE\frac{1}{4}$); and the East Half of the Southwest Quarter ($E\frac{1}{2}$ of $SW\frac{1}{4}$); all in Section 29, Township 2 North, Range 6 E. W. M.

The East Half of the East Half ($E\frac{1}{2}$ of $E\frac{1}{2}$); the Southwest Quarter of the Southeast Quarter ($SW\frac{1}{4}$ of $SE\frac{1}{4}$); the South Half of the Northeast Quarter of the Southwest Quarter ($S\frac{1}{2}$ of $NE\frac{1}{4}$ of $SW\frac{1}{4}$); The Southeast Quarter of the Southwest Quarter ($SE\frac{1}{4}$ of $SW\frac{1}{4}$); and the West Half of the Southwest Quarter ($W\frac{1}{2}$ of $SW\frac{1}{4}$); all in Section 31, Township 2 North, Range 6 E. W. M.

EXCEPTING THEREFROM: Commencing at the Southwest corner of Section 31, Township 2 North, Range 6 E. W. M., thence due East along the south boundary of said Section 31 a distance of 2550 feet to the true point of beginning; thence due North a distance of 970 feet to a point; thence due East along a line parallel to the south boundary of said Section 31, a distance of 1370 feet to a point; thence due South, a distance of 970 feet to a point on the south boundary of said Section 31; thence due West, along the said south boundary a distance of 1370 feet to the true point of beginning. Together with an easement for an access road thereto, 20 feet wide, (as now located) over and across the property herein conveyed.

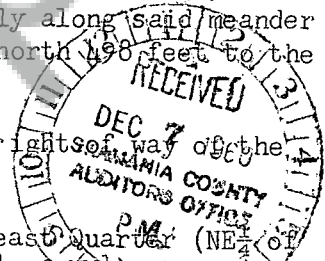

ALSO excepting therefrom: Commencing at a point 660 feet South of the center of Section 31, Township 2 North, Range 6 E. W. M., this point being the Southeast corner of a 20-acre tract; thence South 214 feet, thence North $31^{\circ}27'$ West 205.1 feet to the South line of the 20-acre tract; thence East 130 feet to the place of beginning, containing $32/100$ acres, more or less. ALSO except roadway conveyed to Cripe and Smith by agreement dated February 8, 1911, recorded at page 204, Book "2" of Agreements and Leases.

ALSO excepting any right, title or interest of third persons, parties or municipalities in and to one acre of the East Half of the Southeast quarter ($E\frac{1}{2}$ of $SE\frac{1}{4}$) of Section 31, Township 2 North, Range 6, E. W. M., reserved for school purposes as appearing in conveyance from Finch R. Archer and Dora G. Archer, husband and wife, grantors, to Nancy T. Dillon, Wife of A. T. Dillon, grantee,

BOOK 48 PAGE 215

dated October 13, 1903 and of record at page 527 of Book H, Deed Records of Skamania County.

The North Half of the Northeast quarter ($N\frac{1}{2}$ of $NE\frac{1}{4}$); the Southwest quarter of the Northeast quarter ($SW\frac{1}{4}$ of $NE\frac{1}{4}$); the Northeast quarter of the Northwest quarter ($NE\frac{1}{4}$ of $NW\frac{1}{4}$); the West Half of the Northwest quarter ($W\frac{1}{2}$ of $NW\frac{1}{4}$); and the Southwest quarter ($SW\frac{1}{4}$); all in Section 32, Township 2 North, Range 6 E. W. M.

The Northwest quarter of the Northwest quarter ($NW\frac{1}{4}$ of $NW\frac{1}{4}$); of Section 33, Township 2 North, Range 6. E. W. M.

That portion of the West Half of the Southwest quarter ($W\frac{1}{2}$ of $SW\frac{1}{4}$) of Section 34, Township 2 North, Range 6 E. W. M., lying northerly of Primary State Highway No. 8.

The North Half of the Northeast quarter ($N\frac{1}{2}$ of $NE\frac{1}{4}$) of Section 1. Township 1 North, Range 5. E. W. M.

The East Half of the Southeast quarter ($E\frac{1}{2}$ of $SE\frac{1}{4}$) of Section 36, Township 2 North, Range 5 E. W. M.

That portion of the Northeast quarter of the Northeast quarter ($NE\frac{1}{4}$ of $NE\frac{1}{4}$) and of Government Lot 1 of Section 6, and of Government Lot 5 of Section 5 lying northerly of Primary State Highway No. 8, in Township 1 North, Range 6 E. W. M., described as follows: Beginning at a point on the northerly line of said Highway 509.2 feet south and 268.3 feet east of southwest corner of the Northeast quarter of the Northeast quarter ($NE\frac{1}{4}$ of $NE\frac{1}{4}$) of said Section 6, thence north 512.2 feet to the rim of a certain cliff; thence following the rim of the said cliff north $38^{\circ}32'$ west a distance of 449.3 feet to intersection with the west line of the Northeast quarter of the Northeast quarter ($NE\frac{1}{4}$ of $NE\frac{1}{4}$) of the said Section 6; thence North along the west line of the Northeast quarter of the Northeast quarter ($NE\frac{1}{4}$ of $NE\frac{1}{4}$) of the said Section 6 - 961.3 feet to intersection with the north line of the said Section 6; thence east along the north lines of the said Section 6 and of the said Section 5 - 2638.3 feet to the northeast corner of Government Lot 5 of the said section 5; thence south along the east line of Government Lot 5 of the said Section 5 - 1,712.3 feet to the northerly right of way line of the said State Highway No. 8, thence along the northerly right of way line of the said highway in a westerly direction 2,376.2 feet, more or less, to the point of beginning.

The East Half of the northeast Quarter ($E\frac{1}{2}$ of $NE\frac{1}{4}$) and the Southeast quarter ($SE\frac{1}{4}$); of Section 22, Township 2 North, Range 6 E. W. M.

The Northwest quarter of the Northwest quarter ($NW\frac{1}{4}$ of $NW\frac{1}{4}$) of Section 27, Township 2 North, Range 6, E. W. M., EXCEPT that portion thereof acquired by the United States of America for Bonneville Power Administration's electric power transmission lines.

The South 820 feet of the Northwest quarter of the Northwest quarter ($NW\frac{1}{4}$ of $NW\frac{1}{4}$); the North Half of the Southeast quarter ($N\frac{1}{2}$ of $SE\frac{1}{4}$); the North Half of the Southeast quarter of the Southeast quarter ($N\frac{1}{2}$ of $SE\frac{1}{4}$ of $SE\frac{1}{4}$); the east 990 feet of the South Half of the Southeast quarter of the Southeast quarter ($S\frac{1}{2}$ of $SE\frac{1}{4}$ of $SE\frac{1}{4}$); and the South Half of the Southwest quarter ($S\frac{1}{2}$ of $SW\frac{1}{4}$); EXCEPT that portion lying easterly of county road; all in Section 28, Township 2 North, Range 6 E. W. M.

Including all tide lands adjacent to and abutting upon the same.

BOOK 48 PAGE 216

The purpose of this instrument is to divest the grantor of all right, title and interest in the subject property which the grantor received under a certain Assignment of Real Estate Contract and Deed dated October 31, 1960, and recorded with the Skamania County Auditor on November 3, 1960, in book 48 of Deeds at page 43, under File Number 57730, which instrument was in fact given to secure a debt now paid in full.

situated in the County of Skamania, State of Washington.

IN WITNESS WHEREOF, said Seattle-First National Bank has caused this instrument to be executed by its proper officers and its seal to be hereunto affixed this 2nd day of December, 1960.

SEATTLE-FIRST NATIONAL BANK

L.W.
By R. C. MacDonald
No. 3275 VICE-PRESIDENT
TRANSACTION EXCISE TAX
BY [Signature]
JAN 12 1961
Ass't Vice Pres.

STATE OF WASHINGTON

County of King

ss.

Amount Paid None
Michael O'Donnell
Skamania County Treasurer
By

On this 2nd day of December, A. D. 1960, before me, the undersigned, a Notary Public in and for the State of Washington, duly commissioned and sworn, personally appeared R. C. MacDonald and R. M. Smith

to me known to be a Vice President and ASSISTANT VICE-PRESIDENT, respectively, of SEATTLE-FIRST NATIONAL BANK, a national banking association that executed the foregoing instrument, and acknowledged the said instrument to be the free and voluntary act and deed of said national banking association, for the uses and purposes therein mentioned, and on oath stated that they were authorized to execute the said instrument and that the seal affixed is the seal of said national banking association.

WITNESS my hand and official seal hereto affixed the day and year in this certificate above written.

[Signature]
Notary Public in and for the State of Washington residing at Seattle