

For and in consideration of the sum of ten dollars

(\$10.00) The Washington Corporation (a Corporation organized and existing under the laws of the State of Washington) hereby sells, conveys and delivers to James G. Moore all the merchantable timber 12" or over (dbh-ob) situated on the following described land located in Skamania County, Washington:

The Northwest Quarter ($NW\frac{1}{4}$); the West Half of the Northeast Quarter ($W\frac{1}{2} NE\frac{1}{4}$); and Government Lots 1, 2 and 3; all in Section 6, Township 1 North, Range 6 E. W. M.;

EXCEPT that portion thereof lying easterly of the line described in those certain deed dated June 25, 1883, and recorded at pages 266 and 364 of Book C of Deeds, Records of Skamania County, Washington, which said line is described as follows: Beginning at a point on the north line of said Section 6 west 20 rods and 17 links from the quarter post on the north line of the said Section 6; thence in a southeasterly direction keeping the center of the canyon to its mouth and continuing on the same course to the Cascade Road; thence following the Cascade Road 19 rods and 15 links west; thence in a direct line to the Columbia River taking a hollow ash stump in the line;

AND EXCEPT the following described tract in Government Lots 2 and 3 of said Section 6; All that portion of the following described tract lying south of the center of State Highway no 8: Beginning at a point 1,320 feet east and 914 feet south of the quarter corner on the west line of said Section 6; thence north $54^{\circ}35'$ east 120.3 feet; thence north $71^{\circ}09'$ east 161.7 feet; thence north $52^{\circ}48'$ east 863.6 feet; thence east 155.6 feet; thence north $62^{\circ}05'$ east 227.8 feet; thence south $24^{\circ}45'$ east 228.3 feet; thence south $13^{\circ}40'$ east 435 feet to the meander line of the Columbia River; thence westerly along said meander line to a point south of the point of beginning; thence north 496 feet to the point of beginning;

AND EXCEPT right of way for State Highway No. 8 and the right of way of the Spokane, Portland & Seattle Railway Company.

The south 820 feet of the Northeast Quarter of the Northeast Quarter ($NE\frac{1}{4} NE\frac{1}{4}$); the Southeast Quarter of the Northwest Quarter ($SE\frac{1}{4} NW\frac{1}{4}$); the North

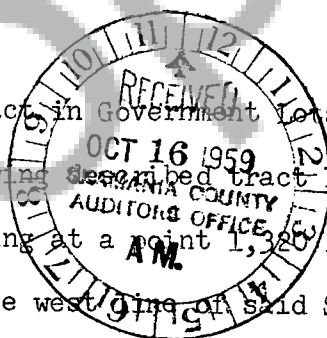

Half of the Northeast Quarter of the Southeast Quarter ($N\frac{1}{2} NE\frac{1}{4} SE\frac{1}{4}$); the Southeast Quarter of the Southeast Quarter ($SE\frac{1}{4} SE\frac{1}{4}$); the West Half of the Southeast Quarter ($W\frac{1}{2} SE\frac{1}{4}$); and the East Half of the Southwest Quarter ($E\frac{1}{2} SW\frac{1}{4}$); all in Section 29, Township 2 North, Range 6 E. W. M.

The East Half of the East Half ($E\frac{1}{2} E\frac{1}{2}$); the Southwest Quarter of the Southeast Quarter ($SW\frac{1}{4} SE\frac{1}{4}$); the South Half of the Northeast Quarter of the Southwest Quarter ($S\frac{1}{2} NE\frac{1}{4} SW\frac{1}{4}$); the Southeast Quarter of the Southwest Quarter ($SE\frac{1}{4} SW\frac{1}{4}$); and the West Half of the Southwest Quarter ($W\frac{1}{2} SW\frac{1}{4}$); all in Section 31, Township 2 North, Range 6 E. W. M.

The North Half of the Northeast Quarter ($N\frac{1}{2} NE\frac{1}{4}$); the Southwest Quarter of the Northeast Quarter ($SW\frac{1}{4} NE\frac{1}{4}$); the Northeast Quarter of the Northwest Quarter ($NE\frac{1}{4} NW\frac{1}{4}$); the West Half of the Northwest Quarter ($W\frac{1}{2} NW\frac{1}{4}$); and the Southwest Quarter ($SW\frac{1}{4}$); all in Section 32, Township 2 North, Range 6 E. W. M.

The Northwest Quarter of the Northwest Quarter ($NW\frac{1}{4} NW\frac{1}{4}$) of Section 33, Township 2 North, Range 6 E. W. M.

That portion of the West Half of the Southwest Quarter ($W\frac{1}{2} SW\frac{1}{4}$) of Section 34, Township 2 North, Range 6 E. W. M., lying northerly of Primary State Highway No. 8.

The North Half of the Northeast Quarter ($N\frac{1}{2} NE\frac{1}{4}$) of Section 1, Township 1 North, Range 5 E. W. M.;

The East Half of the Southeast Quarter ($E\frac{1}{2} SE\frac{1}{4}$) of Section 36, Township 2 North, Range 5 E. W. M.;

That portion of the Northeast Quarter of the Northeast Quarter ($NE\frac{1}{4} NE\frac{1}{4}$) and of Government Lot 1 of Section 6, and of Government Lot 5 of Section 5 lying northerly of Primary State Highway No. 8, in Township 1 North, Range 6 E. W. M., described as follows: Beginning at a point on the northerly line of said highway 509.2 feet south and 268.3 feet east of the southwest corner of the $NE\frac{1}{4}$ of the $NE\frac{1}{4}$ of said Section 6; thence north 512.2 feet to the rim of a certain cliff; thence following the rim of the said cliff north $38^{\circ}32'$ west a distance of 449.3 feet to intersection with the west line of the Northeast Quarter of the Northeast Quarter ($NE\frac{1}{4} NE\frac{1}{4}$) of the said Section 6; thence north along the west line of the Northeast Quarter of the Northeast Quarter ($NE\frac{1}{4} NE\frac{1}{4}$) of the said Section 6 961.3 feet to intersection with the north line of the said Section 6; thence east along the north lines of the said Section 6 and of the

said Section 5, 2,638.3 feet to the northeast corner of Government Lot 5 of the said Section 5; thence south along the east line of Government Lot 5 of the said section 5 1,712.3 feet to the northerly right of way line of the said State Highway No. 8; thence along the northerly right of way line of the said highway in a westerly direction 2,378.2 feet, more or less, to the point of beginning.

The East Half of the northeast Quarter ($E\frac{1}{2} NE\frac{1}{4}$) and the Southeast Quarter ($SE\frac{1}{4}$); of Section 22, Township 2 North, Range 6 E. W. M.

The Northwest Quarter of the Northwest Quarter ($NW\frac{1}{4} NW\frac{1}{4}$) of Section 27, Township 2 North, Range 6 E. W. M., EXCEPT that portion thereof acquired by the United States of America For Bonneville Power Administration's electric power transmission lines.

The South 820 feet of the Northwest Quarter of the Northwest Quarter ($NW\frac{1}{4} NW\frac{1}{4}$); the North Half of the Southeast Quarter ($N\frac{1}{2} SE\frac{1}{4}$); the North Half of the Southeast Quarter of the Southeast Quarter ($N\frac{1}{2} SE\frac{1}{4} SE\frac{1}{4}$); the east 990 feet of the South Half of the Southeast Quarter of the Southeast Quarter ($S\frac{1}{2} SE\frac{1}{4} SE\frac{1}{4}$); and the South Half of the Southwest Quarter ($S\frac{1}{2} SW\frac{1}{4}$) EXCEPT that portion lying easterly of county road; all in Section 28, Township 2 North, Range 6 E. W. M.

It is understood that there is being conveyed to Koppers Company, Inc. the timber on Sections 5 and 6, Township 1 North, Range 6 E. W. M and Section 31, Township 2 North, Range 6 E.W.M. a copy of which Deed showing the exact description has been exhibited to Grantee, and this timber Deed is made subject to the timber Deed to Koppers Company, Inc.

Grantee has three years from date hereof in which to remove said timber. All timber not removed within said period of three years shall revert to and become the property of Grantor or its assigns. Grantee is given full use of all access and existing logging roads to and across the property herein described for the purpose of removing said timber providing said use does not in any way interfere with the use thereof by Koppers Company, Inc.

In the cutting and removing of said timber Grantee shall comply with all Federal, State and local laws and regulations and save and protect Grantor harmless from any liability or damage whatever in connection with or resulting from Grantee's operations.

DATED this 1st day of October, 1959.

THE WASHINGTON CORPORATION

BY *[Signature]*
President

BY *Hazel M. Herbst*
Assistant Secretary

On this first day of October, 1959 personally appeared before me Bryce Little and Hazel M. Herbst to me known to be the President and Assistant Secretary respectively of the Corporation that executed the foregoing timber Deed, and acknowledged said Deed to be the free and voluntary act and deed of said Corporation for the uses and purpose therein mention and and on oath stated that they are authorized to execute the said instrument and that the seal affixed is the Corporate seal of said Corporation.

In Witness whereof, I have hereunto set my hand and affixed my official seal the day and year first above written.

[Signature]
Notary Public in and for the State
of Washington, residing at
Seattle.

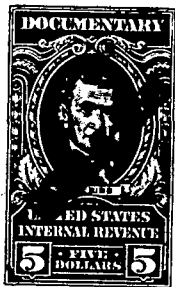
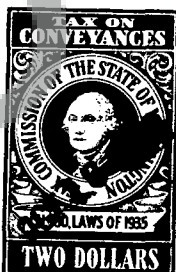
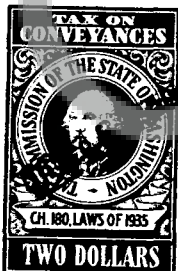
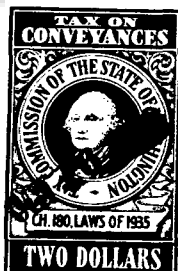

No. 2883
TRANSACTION EXCISE TAX
OCT 16 1959
Amount Paid 100.00
Mahesh Patel
Skamania County Treasurer
By