

MORTGAGE

THIS MORTGAGE, Made this 8th day of January, 19 65, by

GERALD D. PAYNE and CHARLOTTE AGNES PAYNE, husband and wife

of _____, County of Skamania _____, State of Washington, mortgagor, and

COMMONWEALTH, INC.

organized and existing under the laws of the State of Oregon _____, a corporation _____, mortgagee,

WITNESSETH, That the mortgagor mortgages to the mortgagee, its successors and assigns, the following-described real estate, situated in the County of Skamania _____, and State of Washington, to wit:

Lot 29 of Block One of WOODARD MARINA ESTATES according to the official plat thereof on file and of record at pages 114 and 115 of Book A of Plats, Records of Skamania County, Washington, EXCEPT that portion thereof described as follows: Beginning at the southwesterly corner of the said Lot 29; thence north 15° 21' 15" west along the westerly line of the said Lot 29 a distance of 75.56 feet; thence south 33° 41' 20" east 70.09 feet to intersection with the southerly line of the said Lot 29; thence south 52° 22' west along said southerly line 23.82 feet to the point of beginning;

ALSO: That portion of Lot 30 of Block One of WOODARD MARINA ESTATES afore-said described as follows: Beginning at the northeasterly corner of the said Lot 30; thence south 15° 21' 15" east along the easterly line of the said Lot 30 a distance of 144.44 feet; thence north 33° 41' 20" west 54.59 feet; thence north 04° 51' 10" west 94.20 feet to the point of beginning;

TOGETHER WITH shorelands of the second class conveyed by the State of Washington and fronting and abutting upon that portion of Lot 29 of Block One of the said Woodard Marina Estates described above;

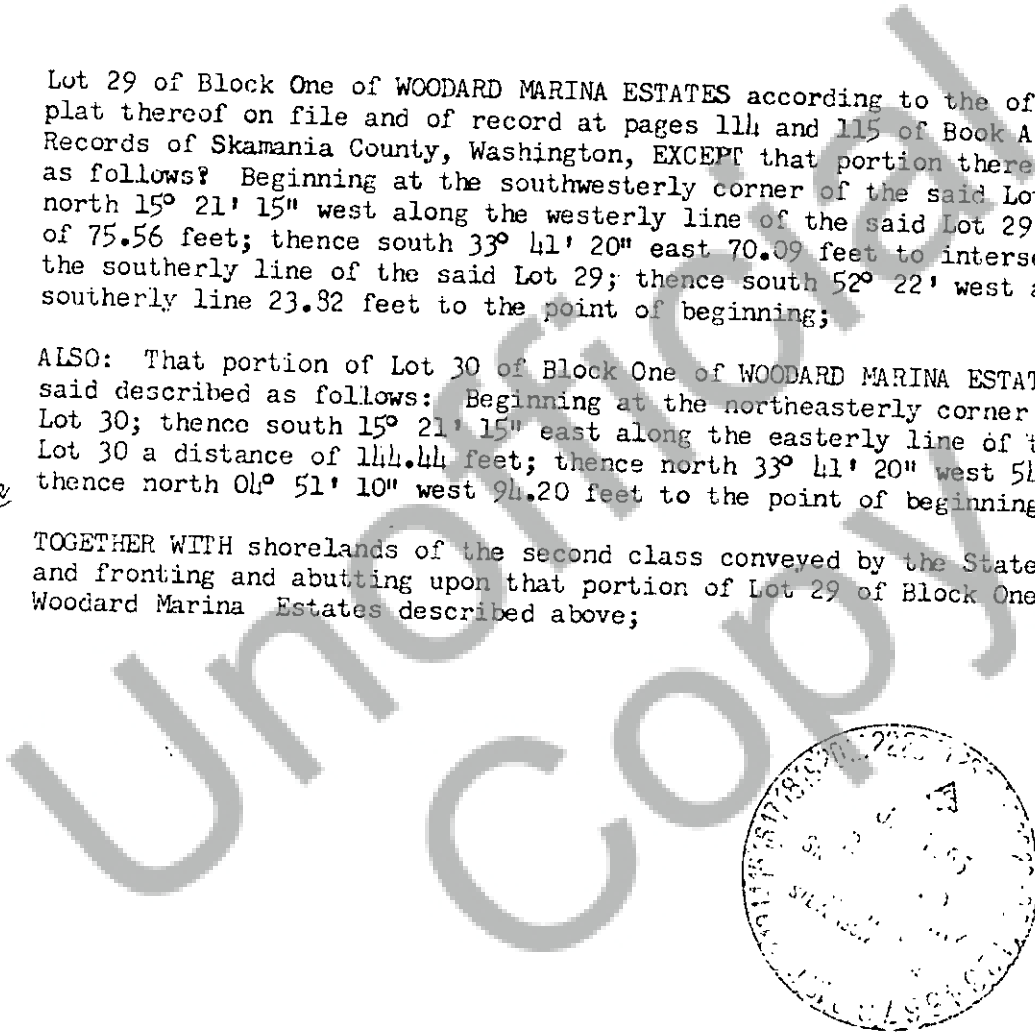

with all rents, issues and profits therefrom, and all appurtenances, fixtures, attachments, tenements and hereditaments belonging or appertaining thereto, including all heating equipment, oil burners, light and plumbing fixtures, window shades, linoleum which is glued to floors, refrigeration and other house service equipment, and trees and shrubs, together with all interest therein of the mortgagor and that is hereafter acquired by him, to secure the payment of the principal sum of EIGHTEEN THOUSAND, NINE HUNDRED AND NO/100 - - - - - Dollars (\$ 18,900.00), as evidenced by a certain promissory note of even date herewith and the terms of which are incorporated herein by reference, with interest from date at the rate of FIVE AND ONE-FOURTH per centum (5 1/4 %) per annum on the balance remaining from time to time unpaid; the said principal and interest to be payable at the office of COMMONWEALTH, INC. in Portland, Oregon, or at such other place as the holder may designate in writing, in monthly installments of ONE HUNDRED TWENTY-SEVEN AND 39/100 - - - - - Dollars (\$ 127.39), commencing on the first day of MARCH, 19 65, and on the first day of each month thereafter until the principal and interest are fully paid, except that the final payment of the entire indebtedness evidenced by said note, if not sooner paid, shall be due and payable on the first day of FEBRUARY, 19 85.

The within-described mortgaged property is not used principally for agricultural or farming purposes.