

BOOK 232 PAGE 352

FILED FOR RECORD  
SKAMANA CO. WASH  
BY LANOVERK

Nov 15 2 52 PM '02  
AMW

ALBANY  
J. MICHAEL GARRISON

**Duane Lansverk, Attorney at Law**  
**Landerholm, Memovich,**  
**Lansverk & Whitesides, P.S.**  
**PO Box 1086**  
**Vancouver, WA 98666-1086**

[illegible]

Reference Number(s) or Documents assigned or released:  
**SUPERIOR COURT CASE NO. 98-2 00002-5**  
 Additional reference numbers on page \_\_\_\_\_ of document \_\_\_\_\_

☐ Additional names on page \_\_\_\_\_ of document \_\_\_\_\_

☐ Additional names on page \_\_\_\_\_ of document \_\_\_\_\_

☐ Additional legal is on page \_\_\_\_\_ of document \_\_\_\_\_

☐ Assessor Tax Number not yet assigned

IN THE SUPERIOR COURT OF THE STATE OF WASHINGTON  
FOR SKAMANIA COUNTY

FIRST NATIONAL BANK OF OREGON,  
a corporation,

Plaintiff,

v.

BILLY D. LYONS, aka BILL LYONS;  
MARIE SITZMAN, formerly known as  
MARIE LYONS; and J.L. LEDGETT and  
LAVERNE LEDGETT, husband and wife,

Defendants.

No. 98-2-00002-5

**RELEASE OF JUDGMENT LIEN**

COMES NOW judgment creditor Wells Fargo Bank NA, successor by merger with First Interstate Bank of Oregon, formerly known as First National Bank of Oregon, plaintiff in said suit, by and through its attorney of record, D. Jeffrey Courser of Stoel Rives LLP, and herewith release that certain judgment against defendants, including Marie Cobine, formerly known as Marie Sitzman, pertaining to the property described on Exhibit A attached hereto. Said judgment has been satisfied in full.

DATED: November 8, 2002.

STOEL RIVES LLP

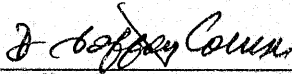
  
\_\_\_\_\_  
D. Jeffrey Courser, WSB No. 15466  
Attorneys for Plaintiff

RELEASE OF JUDGMENT LIEN - Page 1



LAND SURVEYORS  
ENGINEERS

(360) 695-1385  
1111 Broadway  
Vancouver, WA  
98660

LEGAL DESCRIPTION FOR OTTIS HOLWEGNER  
Parcel 4

May 18, 2001

A parcel of property located in the West half of the East half of Section 15, Township 4 North, Range 7 East of the Willamette Meridian in Skamania County, Washington, described as follows:

COMMENCING at the Southeast corner of said Section 15;

THENCE North  $02^{\circ} 00' 11''$  East along the East of the Southeast quarter of said Section 15 a distance of 1326.15 feet to the South line of the North half of said Southeast quarter of Section 15;

THENCE North  $88^{\circ} 46' 06''$  West to said South line of the North half of the Southeast quarter of Section 15 a distance of 1991.68 feet to the TRUE POINT OF BEGINNING;

THENCE North  $16^{\circ} 21' 13''$  West 1020.08 feet;

THENCE North  $33^{\circ} 14' 18''$  East 930.63 feet;

THENCE North  $56^{\circ} 18' 27''$  West 896.26 feet to a point on a 1432.40 foot radius curve to the right;

THENCE around said 1432.40 foot radius curve to the right 158.32 feet to a point 20.00 feet East of, when measured at right angles to, the West line of the East half of said Section 15;

THENCE South  $00^{\circ} 45' 15''$  West parallel with said West line 851.32 feet to a point 163.00 feet north of, when measured at right angles to, the North line of the Northwest Quarter of the Southeast Quarter of said Section 15;

THENCE North  $88^{\circ} 53' 18''$  West parallel with said North line 20.00 feet to said West line of the East half of Section 15;



**OLSON**  
ENGINEERING INC.

LAND SURVEYORS  
ENGINEERS

(360) 695-1385  
1111 Broadway  
Vancouver, WA  
98660

THENCE South  $00^{\circ} 45' 15''$  West along said West line 598.00 feet;

THENCE South  $65^{\circ} 26' 29''$  East 411.27 feet;

THENCE South  $04^{\circ} 30' 07''$  East 726.25 feet to the South line of the North half of the Southeast quarter of said Section 15;

THENCE South  $88^{\circ} 46' 06''$  East along said South line 257.50 feet to the TRUE POINT OF BEGINNING.

The intent of this description is to describe property to the centerline of the Wind River Highway.

Subject to easements and all restrictions of record.

This parcel contains 22.13 +/- acres.

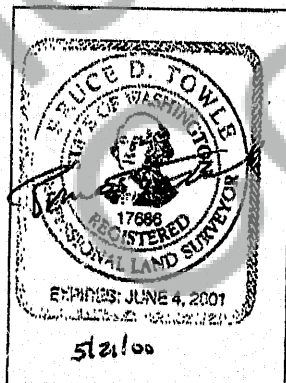

**COPY  
ORIGINAL FILED**

NOV 08 2002

JoAnne McBride, Clerk, Clark Co.

SUPERIOR COURT OF WASHINGTON

CLARK COUNTY

FIRST NATIONAL BANK OF OREGON,  
a corporation,

Plaintiff,

v.

BILLY D. LYONS, aka BILL LYONS;  
MARIE SITZMAN, formerly known as  
MARIE LYONS; and J.L. LEDGETT and  
LAVERNE LEDGETT, husband and wife,

Defendants.

No. 80-2-02651-1

**FULL SATISFACTION OF  
JUDGMENT**

COMES NOW judgment creditor Wells Fargo Bank NA, successor by merger with First Interstate Bank of Oregon, formerly known as First National Bank of Oregon, herewith acknowledges full satisfaction of the Judgment and hereby releases the Judgment against defendants, including Marie Cobine, formerly known as Marie Sitzman.

Plaintiff authorizes the Clerk of this Court and the clerk of any county in which this Judgment has been entered, to enter satisfaction of this Judgment in the judgment docket of that county.

DATED: November 8, 2002.

STOEL RIVES LLP

*D. Jeffrey Courser*  
\_\_\_\_\_  
D. Jeffrey Courser, WSB No. 15466  
Of Attorneys for Plaintiff

FULL SATISFACTION OF JUDGMENT - Page 1